

MALLORY SCREW TERMINAL ALUMINUM CAPACITORS

Mallory computer grade capacitors provide high C/V product (capacity times voltage per given can size) commensurate with the quality of components required in today's modern equipment.

Type CGS utilizes Mallory Engineering knowledge to provide greater capacity per given can size with higher ripple current capability.

CGS FEATURES:

- Operating temperature range: -40°C to +85°C
- Capacity tolerance: 0 thru 150 WVDC -10 +75% 151 thru 500 WVDC -10 +50%
- PVC insulating sleeve standard.
- Polyester sleeving is available on special order.
- High post terminals.
- Low post standard options available on special order.

Cat. No.	Cap. (MFD)	Max. ESR (ohms) @ 120Hz	Max. Ripple RMS Amps @ 120Hz +85°C	D x L (mm)	Net Price
16 VDC					
CGS552U016R2C	5,500	.037	4.4	35 x 54	\$19.28
CGS892U016R2C	8,900	.034	4.4	35 x 54	19.28
CGS103U016R2C	10,000	.033	4.7	35 x 54	19.28
CGS153U016R2L	15,000	.026	5.6	35 x 67	20.27
CGS173U016R3C	17,000	.022	6.7	35 x 79.4	20.27
CGS193U016R3C	19,000	.021	6.8	35 x 79.4	21.78
CGS233U016V3C	23,000	.027	7.6	50.8 x 79.4	27.39
CGS243U016R3C	24,000	.032	5.6	35 x 79.4	21.78
CGS253U016R4C	25,000	.016	8.8	35 x 105	25.36
CGS383U016V3C	38,000	.021	8.6	50.8 x 79.4	27.39
CGS503U016V3C	50,000	.011	11.7	50.8 x 79.4	29.51
CGS553U016V3L	55,000	.015	10.2	50.8 x 92	30.24
CGS663U016V4C	66,000	.017	10.8	50.8 x 105	32.48
CGS683U016V3C	68,000	.017	9.5	50.8 x 79.4	32.85
CGS104U016X5C	100,000	.007	22.5	76.2 x 130	64.86
CGS114U016W4C	110,000	.010	16.0	63.5 x 105	41.79
CGS124U016X3L	120,000	.007	20.1	76.2 x 92	50.98
CGS214U016X5R	210,000	.005	29.2	76.2 x 149	73.48
25 VDC					
CGS302U025R2C	3,000	.235	1.8	35 x 54	19.28
CGS682U025R2C	6,800	.096	2.8	35 x 54	19.28
CGS892U025R3C	8,900	.024	6.4	35 x 79.4	21.78
CGS103U025R3C	10,000	.024	6.4	35 x 79.4	21.78
CGS123U025R3C	12,000	.024	8.1	35 x 79.4	21.78
CGS183U025R4C	18,000	.017	8.6	35 x 105	25.36
CGS203U025V3C	20,000	.024	8.0	50.8 x 79.4	27.39
CGS283U025V3C	28,000	.028	7.5	50.8 x 79.4	27.28
CGS333U025V3C	33,000	.018	9.3	50.8 x 79.4	30.03
CGS473U025V4C	47,000	.022	9.6	50.8 x 105	34.20
CGS124U025X4C	120,000	.010	17.9	76.2 x 105	61.94
30 VDC					
CGS452U030R2C	4,500	.037	4.4	35 x 54	19.28
CGS802U030R3C	8,000	.024	6.4	35 x 79.4	19.28
CGS922U030R3C	9,200	.024	6.4	35 x 79.4	21.78
CGS153U030R4L	15,000	.016	9.3	35 x 117.5	25.83
CGS203U030R5L	20,000	.013	11.0	35 x 143	27.39
CGS303U030V4C	30,000	.019	10.0	50.8 x 105	31.65
CGS553U030W4C	55,000	.009	16.3	63.5 x 105	42.45
CGS104U030X5L	100,000	.008	22.4	76.2 x 143	73.48
35 VDC					
CGS822U035R3C	8,200	.024	6.4	35 x 79.4	21.78
CGS103U035V2C	10,000	.038	5.5	50.8 x 54	25.83
CGS123U035R4C	12,000	.018	8.4	35 x 105	25.36
CGS213U035V3C	21,000	.029	7.3	50.8 x 79.4	28.85
CGS303U035W3C	30,000	.028	8.6	63.5 x 79.4	39.80

Cat. No.	Cap. (MFD)	Max. ESR (ohms) @ 120Hz	Max. Ripple RMS Amps @ 120Hz +85°C	D x L (mm)	Net Price
40 VDC					
CGS222U040R2C	2,200	.014	4.1	35 x 54	\$19.28
CGS272U040R2C	2,700	.042	4.2	35 x 54	19.28
CGS352U040R2C	3,500	.038	4.4	35 x 54	19.28
CGS422U040R3C	4,200	.028	6.0	35 x 79.4	21.78
CGS472U040R2C	4,700	.036	4.5	35 x 54	19.28
CGS512U040R3C	5,100	.026	6.1	35 x 79.4	20.84
CGS602U040R3C	6,000	.025	6.2	35 x 79.4	21.78
CGS622U040R4C	6,200	.020	7.9	35 x 105	25.36
CGS752U040R4C	7,500	.019	8.10	35 x 105	25.36
CGS902U040R4C	9,000	.019	8.2	35 x 105	25.36
CGS113U040V3C	11,000	.024	8.0	50.8 x 79.4	27.39
CGS123U040R4C	12,000	.049	5.00	35 x 105	25.36
CGS133U040V4C	13,000	.033	6.05	50.8 x 105	31.65
CGS223U040V3C	22,000	.031	7.10	50.8 x 79.4	30.66
CGS233U040V4C	23,000	.022	9.9	50.8 x 105	31.65
CGS323U040V4C	32,000	.021	9.52	50.8 x 105	35.45
CGS333U040V4C	33,000	.021	9.71	50.8 x 105	35.89
CGS353U040V5L	35,000	.015	12.8	50.8 x 143	37.52
CGS403U040X4C	40,000	.010	18.1	76.2 x 105	55.76
CGS403U040W4C	40,000	.010	16.3	63.5 x 105	39.55
CGS683U040X4C	68,000	.012	16.0	76.2 x 105	62.55
50 VDC					
CGS162U050R2C	1,600	.048	3.9	35 x 54	19.28
CGS222U050R2C	2,200	.044	4.1	35 x 54	19.28
CGS292U050R3C	2,900	.022	7.6	35 x 79.4	21.78
CGS302U050R2C	3,000	.040	4.3	35 x 54	19.28
CGS412U050R3C	4,100	.022	7.6	35 x 79.4	21.78
CGS492U050R3L	4,900	.023	7.0	35 x 92	21.78
CGS502U050R3C	5,000	.026	6.1	35 x 79.4	21.78
CGS612U050R4C	6,100	.020	7.8	35 x 105	25.36
CGS652U050V3C	6,500	.025	7.9	50.8 x 79.4	27.39
CGS682U050R3C	6,800	.024	6.4	35 x 79.4	20.01
CGS962U050V4C	9,600	.018	10.3	50.8 x 105	31.65
CGS103U050R4C	10,000	.017	8.5	35 x 105	25.36
CGS103U050V2C	10,000	.045	4.9	50.8 x 54	26.40
CGS123U050R5L	12,000	.014	10.7	35 x 143	27.39
CGS133U050V3C	13,000	.029	7.3	50.8 x 79.4	29.29
CGS153U050V4C	15,000	.019	10.0	50.8 x 105	31.65
CGS183U050V3C	18,000	.034	6.8	50.8 x 79.4	32.69
CGS203U050V4C	20,000	.021	9.5	50.8 x 105	34.12
CGS253U050W4C	25,000	.024	10.2	63.5 x 105	41.79
CGS313U050W4C	31,000	.028	9.6	63.5 x 105	43.48
CGS413U050X4L	41,000	.009	19.2	76.2 x 117.5	63.02
CGS433U050X5C	43,000	.023	12.7	76.2 x 130	64.86
CGS563U050X3L	56,000	.005	23.1	76.2 x 92	65.21
CGS603U050X5C	60,000	.010	14.2	76.2 x 130	70.66
CGS703U050X5L	70,000	.016	15.7	76.2 x 143	75.70
CGS104U050X8L	100,000	.007	19.1	76.2 x 219	120.34
75 VDC					
CGS152U075R3C	1,500	.041	1.1	35 x 79.4	21.78
CGS222U075R2C	2,200	.041	4.2	35 x 54	19.28
CGS292U075R3C	2,900	.032	5.6	35 x 79.4	31.65
CGS422U075R4C	4,200	.023	7.4	35 x 105	25.36
CGS482U075V3C	4,800	.030	7.2	50.8 x 79.4	27.39
CGS562U075R4C	5,600	.021	7.8	35 x 105	25.36
CGS632U075R5L	6,300	.017	9.8	35 x 143	27.39
CGS752U075V5L	7,500	.017	12.3	50.8 x 143	37.10
CGS103U075V3C	10,000	.041	6.2	50.8 x 79.4	30.92
CGS103U075V4C	10,000	.024	9.0	50.8 x 105	31.65
CGS123U075V4C	12,000	.026	8.7	50.8 x 105	33.63
CGS153U075V5L	15,000	.018	11.9	50.8 x 143	37.99
CGS173U075X4C	17,000	.033	9.8	76.2 x 105	55.76
CGS173U075W4C	17,000	.033	8.8	63.5 x 105	51.14
CGS253U075W5L	25,000	.024	11.7	63.5 x 143	52.70
CGS253U075X4C	25,000	.014	15.0	76.2 x 105	55.76
CGS333U075X4C	33,000	.019	12.7	76.2 x 105	79.49
CGS373U075X5L	37,000	.010	14.7	76.2 x 143	69.95
100 VDC					
CGS122U100R3C	1,200	.062	3.5	35 x 79.4	21.78
CGS153U100W5L	15,000	.043	8.6	63.5 x 143	52.06
CGS172U100R3C	1,700	.069	3.8	35 x 79.4	20.27
CGS242U100R4C	2,400	.025	11.4	35 x 105	25.36
CGS402U100V4C	4,000	.036	7.3	50.8 x 105	31.65
CGS602U100V4C	6,000	.033	7.6	50.8 x 105	34.29
CGS902U100V5L	9,000	.024	10.2	50.8 x 143	42.05
CGS103U100W4C	10,000	.040	8.0	63.5 x 105	45.32
CGS153U100X4C	15,000	.051	7.9	76.2 x 105	59.86

Continued on next page....

Cat. No.	Cap. (MFD)	Max. ESR (ohms) @ 120Hz	Max. Ripple RMS Amps @ 120Hz +85°C	D x L (mm)	Net Price
----------	------------	-------------------------	------------------------------------	------------	-----------

150 VDC

CGS401U150R2C	400	.037	2.3	35x67	\$19.28
CGS112U150R4C	1,100	.102	3.2	35x105	25.36
CGS572U150X4C	5,700	.023	8.3	76.2x105	56.70
CGS622U150W5L	6,200	.025	11.4	63.5x143	57.93
CGS872U150X5R	8,700	.027	12.5	76.2x149	69.95
CGS103U150X5C	10,000	.034	10.4	76.2x130	81.73
CGS123U150X5L	12,000	.013	17.8	76.2x143	88.90

200 VDC

CGS591T200R3C	590	.151	2.6	35x79.4	21.78
CGS102T200R4C	1,000	.113	3.2	35x105	25.36
CGS142T200V3C	1,400	.081	4.4	50.8x79.4	29.29
CGS162T200V3C	1,600	.074	4.6	50.8x79.4	30.54
CGS202T200V4C	2,000	.057	5.8	50.8x105	33.00
CGS222T200V4C	2,200	.054	6.0	50.8x105	33.99
CGS272T200V4C	2,700	.048	6.4	50.8x105	38.51
CGS462T200X4C	4,600	.047	8.2	76.2x105	65.64
CGS542T200X4L	5,400	.021	12.6	76.2x117.5	78.41
CGS742T200X5L	7,400	.018	15.0	76.2x143	86.16
CGS772T200X5L	7,700	.018	15.0	76.2x143	82.11

250 VDC

CGS201T250R2C	200	.241	1.7	35x54	19.28
CGS471T250R3C	470	.439	1.50	35x79.4	21.78
CGS551T250R4C	550	.098	3.6	35x105	25.36
CGS721T250R4C	720	.110	3.4	35x105	25.36
CGS122T250V3C	1,200	.080	4.4	50.8x79.4	32.05
CGS252T250V5L	2,500	.041	7.8	50.8x143	45.98
CGS292T250W4L	2,900	.043	8.0	63.5x117.5	52.65
CGS602T250X5L	6,000	.047	9.2	76.2x143	98.89

350 VDC

CGS251T350R3C	250	.478	1.4	35x79.4	21.78
CGS381T350R4C	380	.318	2.0	35x105	25.36
CGS801T350V4C	800	.170	3.4	50.8x105	38.39
CGS102T350V4C	1,000	.145	3.0	50.8x105	38.93
CGS132T350V5L	1,300	.085	4.3	50.8x143	44.00
CGS212T350X4C	2,100	.056	5.9	76.2x105	84.49
CGS222T350W5L	2,200	.063	7.2	63.5x143	81.99
CGS302T350X5R	3,000	.048	9.3	76.2x149	103.77
CGS332T350X5L	3,300	.044	9.5	76.2x143	89.63
CGS342T350X5L	3,400	.043	9.6	76.2x143	109.50

450 VDC

CGS101T450R2C	100	.737	1.0	35x54	19.28
CGS141T450R3C	140	.796	1.4	35x79.4	21.78
CGS171T450R3C	170	.456	1.5	35x79.4	21.05
CGS211T450R4C	210	.332	1.4	35x105	25.36
CGS251T450R4C	250	.308	2.0	35x105	25.36
CGS321T450V3C	320	.253	2.5	50.8x79.5	31.02
CGS451T450V3C	450	.188	2.5	50.8x79.4	35.40
CGS481T450V4C	480	.171	3.4	50.8x105	36.41
CGS651T450V4C	650	.134	3.7	50.8x105	44.26
CGS801T450V4L	800	.108	4.4	50.8x117.5	48.95
CGS102T450W4C	1,000	.082	5.5	63.5x105	56.85
CGS112T450X4C	1,100	.076	6.5	76.2x105	76.64
CGS142T450W5C	1,400	.060	7.1	63.5x105	71.51
CGS152T450X5C	1,500	.057	8.1	76.2x130	79.35
CGS182T450X5R	1,800	.048	9.3	76.2x149	88.43
CGS192T450X5L	1,900	.052	7.6	76.2x143	96.30
CGS202T450X5C	2,000	.045	4.1	76.2x130	99.03
CGS242T450X5L	2,400	.038	10.3	76.2x143	107.26
CGS332T450X5L	3,300	.031	11.4	76.2x143	148.36
CGS481T450V4C	480	.171	3.4	50.8x105	36.41

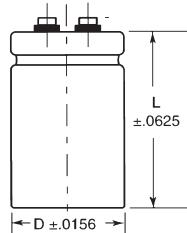

TYPE CGR SCREW TERMINAL ALUMINUM CAPACITORS HIGH PERFORMANCE

The CGR is specifically designed as a low ESR, high ripple current power supply filtering capacitor. Constructed in a rugged aluminum can with a choice of high or low 10-32 screw insert terminal assemblies. (High post terminals are standard and in stock for immediate delivery.) Outstanding features of the CGR are low

ESR, low DC leakage current plus high ripple current capability over broad temperature and frequency ranges.

With capacitances up to 100,000µF and ripple capability up to 35.7 amperes at 20kHz at +85°C the CGR handles extreme application requirements with ease and reliability. The CGR has been successfully utilized as an output capacitor in some high frequency switching regulator power supplies.

HIGHLIGHTS:
Capacitance Range: 330 to 100,000µF
Voltage Range: 7.5 to 200 WVDC
Capacity Tolerance: -10% + 75% 0 thru 50 WVDC
 -10% + 50% 75 and 100 WVDC
Operating Temperature: -40°C to 105°C
36 Case Sizes: 1.375x2.125 thru 3.00x8.625

Cat. No.	Cap. (MFD)	Max. ESR (ohms) @ 120Hz	Max. Ripple RMS Amps @ 20kHz +85°C	D x L (mm)	Net Price
----------	------------	-------------------------	------------------------------------	------------	-----------

16 VDC

CGR163U016U2L	16,000	.0173	11.6	44.5x67	\$40.37
CGR203U016R4C	20,000	.0084	17.2	35x105	38.72
CGR303U016V3C	30,000	.0098	17.8	50.8x79.4	50.03

20 VDC

CGR103U020R3L	10,000	.0105	14.6	35x92	22.81
---------------	--------	-------	------	-------	-------

30 VDC

CGR103U030R4L	10,000	.0077	18.9	35x117.5	38.98
---------------	--------	-------	------	----------	-------

40 VDC

CGR392U040R3C	3,900	.0133	12.2	35x79.4	32.64
CGR962U040V3L	9,600	.0090	19.7	50.8x92	29.37
CGR223U040W4L	22,000	.0060	30.0	63.5x117.5	44.99

50 VDC

CGR152U050R2C	1,500	.0672	4.7	35x54	30.36
CGR762U050V3C	7,600	.0165	13.7	50.8x79.4	32.10
CGR103U050V4C	10,000	.0113	18.5	50.8x105	33.82

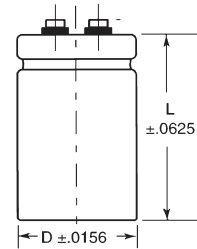

TYPE CGH SCREW TERMINAL ALUMINUM CAPACITORS POWER SUPPLY OUTPUT

High ripple current. Very high capacitance. Suitable for use in most AC drive and UPS applications. **SPECIFICATIONS:** Operating temperature: -40°C to +85°C. Voltage range: 250 WVDC to 500 WVDC. Capacitance range: 350µF to 22,000µF. Capacitance tolerance: -10% + 50%.

Cat. No.	Cap. (µF)	Max. ESR Ohms @ 20kHz	Max. Ripple RMS AMPS @ 20kHz	D x L (mm)	Net Price
----------	-----------	-----------------------	------------------------------	------------	-----------

250 VDC

CGH172T250V2L	1,700	42.1	5.0	50.8x67	\$41.23
CGH292T250V3L	2,900	34.0	7.1	50.8x92	45.73
CGH412T250V4L	4,100	16.4	11.4	50.8x117.5	58.24
CGH502T250V3L	5,000	17.2	11.5	63.5x92	87.01

350 VDC

CGH102T350V2L	1,000	104.1	3.6	50.8x67	45.78
CGH242T350V4L	2,400	37.6	7.5	50.8x117.5	77.71
CGH312T350V5L	3,100	29.6	9.3	50.8x143	101.74
CGH732T350X5L	7,300	16.6	15.6	76.2x143	217.54

450 VDC

CGH621T450V2L	620	102.1	3.6	50.8x67	50.23
CGH102T450V3L	1,000	53.4	6.0	50.8x92	63.53
CGH142T450V4L	1,400	38.6	7.4	50.8x117.5	74.57
CGH182T450V5L	1,800	30.5	9.0	50.8x143	99.72
CGH242T450W4L	2,400	25.7	10.4	63.5x117.5	105.46
CGH312T450W5L	3,100	20.3	12.6	63.5x143	120.91
CGH362T450X4L	3,600	20.9	12.9	76.2x117.5	142.36
CGH462T450X5L	4,600	16.8	15.5	76.2x143	228.33
CGH772T450X8L	7,700	11.1	22.8	76.2x219	316.68