



EPROM ERASER MODEL 850

The Model 850 is a UV- EPROM eraser featuring small dimensions, high erasing efficiency, and simple operation. Up to five EPROM's in 40-pin DIP packages can be erased simultaneously. A built-in timer is preset to an optimum erasing period.

Cat. No.	Net Price
850	\$134.99



DELUXE EPROM ERASER MODEL 851

The model 851 is a heavy duty EPROM eraser that can simultaneously erase up to 40 twenty-four pin EPROM's. It is constructed of an all-metal case plus an advanced designed chip drawer that prevents UV radiation from being a hazard to the user. The chip drawer is lined with conductive foam to prevent electrostatic damage to the chips.

Cat. No.	Net Price
851	\$210.74



B&K MODELS 300, 305, 307 AND 308 INSULATION TESTERS

Economical analog megohmmeters measure up to 2,000 megohms with applied voltage to 1,000 volts. These meters also measure AC voltage to 600 VAC and include a battery check meter scale. Powered by 6 "AA" cells (supplied). Accuracy 1% at infinity and zero, within 5% at all points. Dimensions: 6.66" x 4.18" x 1.42". Weight with batteries 16oz. Comes complete with batteries, carrying case, high voltage test leads and instruction manual.

Cat. No.	Description	Net Price
300	Applies 1000 volts DC, measures 1M Ω to 2000M Ω with 50M Ω centre scale. Greater than 90% of output voltage at centre scale. Maximum 250 μ A into short circuit.	\$168.34
305	Applies 500 volts DC, measures 0.2M Ω to 1000M Ω with 20M Ω centre scale. Greater than 90% of output voltage at centre scale. Maximum 500 μ A into short circuit.	168.34
307	Applies 1000VDC, measures 0-200m Ω 1000V, 0-100m Ω 500V, 0-50m Ω , 250V with 2 Ω centre scale. Maximum 1.2mA into short circuit.	243.16
308	Applies 1000VDC, measures 0-2000m Ω . Maximum 1.2 μ A into short circuit self contained carrying case includes test leads and complete instructions. Large LCD digital readout for accurate and reliable operation.	330.44



848A



864

B&K MODELS 848A AND 864 DEVICE PROGRAMMERS

The **Model 864** is a universal device programmer with extensive device libraries that are constantly updated. This programmer has been designed for ease of use and reliable performance. Whether you are working with PLCC, SOIC, TSOP, DIP, TQFP, SSOP, PSOP, or QFP, B&K Precision has an extensive line of socket adapters to interface with any IC package. This programmer is a must for anyone that tests, repairs, or programs any electronic device that uses a memory IC. **FEATURES:** 48 pin DIL ZIF (Zero Insertion Force) socket accepts both 300/600 mil devices up to 48 pin. Fast and accurate programming. 48 pin ZIF socket, no adapter required for any DIP device up to 48 pins. Parallel printer port interface. Windows 95/98/Me/NT/2000/XP compatible.

The **Model 848A** is a great low cost programmer designed for anyone who wants to read, copy, program, or burn common ICs. **FEATURES:** Low cost. 32 pin DIL ZIF (Zero Insertion Force) socket accepts both 300/600 mil devices up to 32 pin. Parallel printer port interface. Easy to use program, DOS and Windows 95/98/Me/NT/2000/XP compatible.

Cat. No.	Net Price
864	\$866.63
848A	305.00

CIRCUIT-TEST

Eraser

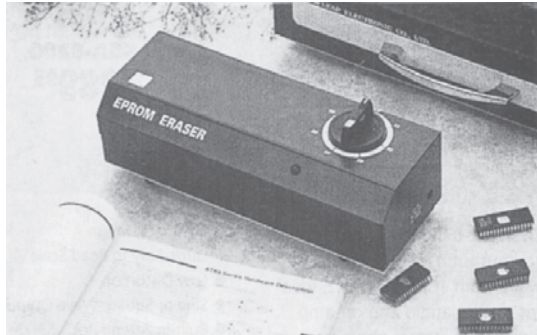

EPROM ERASER

The ER-121A EPROM Eraser has a maximum capacity of 12 24 pin EPROMS. With a built-in adjustable UV exposure from 1 to 60 minutes. **SPECIFICATIONS:** Power: 9VDC @ 500mA. UV intensity: 5000 μ W/cm². UV tube: GL-4. Size: 240mm x 85mm x 95mm (9.5" x 3.4" x 3.75"). Weight: 1.2Kg (2.65 lbs). Accessories include: DC 9V/500mA Power Adapter.

Cat. No.	Description	Net Price
ER-121A	Eprom Eraser	\$153.46
ER-121A-BULB	Replacement Tube	37.51

Panel Meters



DIGITAL LCD PANEL METER

For increased accuracy and readability use the DMD-3500B Digital Panel Meter. Factor set to read 199.9mV, this model can be easily adapted to read a wide range of voltages and current by the addition of external resistors and adjusting built-in jumpers. Note: Supply voltage must be independent of voltage being measured.

SPECIFICATIONS:

Input Impedance:	1000mV
Accuracy:	±(0.1% + digit)
Measurement Range:	199.9mV
Resolution:	100 μ V
Display:	3.5 Digit LCD
Supply Voltage:	9-12VDC
Current:	Approx. 1mA
Temperature Range:	0-60°C
Dimensions (W x H):	80 x 43mm (3.12 x 1.75")
Mounting Cutout (W x H):	75 x 40mm (3 x 1.12")

Cat. No.	Description	Net Price
DMD-3500B	Digital Panel Meter	\$21.49

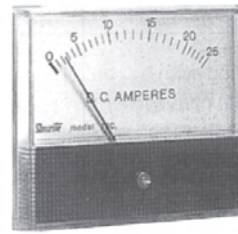

750 SERIES



850 SERIES

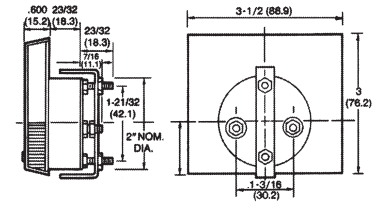

750 SERIES

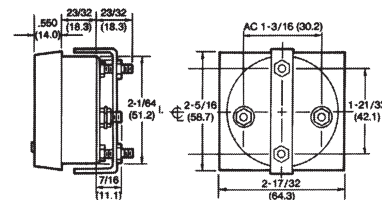

850 SERIES

ANALOGUE PANEL METERS

Rugged, low-cost panel meters designed and manufactured for lasting service and reliable performance. **SPECIFICATIONS:** Accuracy: ±5%. Dials: White field, printed black scales, age and moisture resistant. DC Models: Either polarized-vane solenoid or moving magnet type. AC Models: Double-vane repulsion, jeweled bearing. Pointers: Lance Type. Mounting: Mount on panels up to 5mm (3/16") Thick. Case: Polystyrene.

750 SERIES 3.5" MODEL

Cat. No.	Range	Net Price
DC VOLTAGE		
7108Z	0-15V	\$34.25
7122Z	0-50V	36.72
DC CURRENT		
7336Z	0-1mA	34.68
7201Z	0-1A	34.68
AC VOLTAGE		
7406Z	0-150V	35.65
AC CURRENT		
7503Z	0-5A	37.26
7505Z	0-30A	37.91

850 SERIES 2.5" MODEL

Cat. No.	Range	Net Price
DC VOLTAGE		
8107Z	0-10V	\$28.86
8108Z	0-15V	28.86
8109Z	0-25V	29.51
8122Z	0-50V	30.69
DC CURRENT		
8336Z	0-1mA	31.98
8203Z	0-5A	30.69
8205Z	0-10A	28.54
8206Z	0-15A	28.54
8207Z	0-25A	30.26
8208Z	0-50A	30.26
AC VOLTAGE		
8406Z	0-150V	31.98
8407Z	0-300V	31.98
AC CURRENT		
8503Z	0-5A	35.65
8504Z	0-10A	35.65
8508Z	0-15A	36.94
8505Z	0-30A	35.65
8506Z	0-50A	36.94
8507Z	0-80A	38.55