

BUSS®

5mm × 20mm FUSES



GMA TYPE FUSES FAST ACTING

Glass tube visual indicating. Designed for protection of miniaturized circuits or equipment. UL & CSA certified.

Cat. No.	Volts	Net Price
GMA-63-R	250	\$2.60
GMA-100-R	250	1.22
GMA-125-R	250	1.22
GMA-200-R	250	1.22
GMA-250-R	250	1.22
GMA-300-R	250	1.22
GMA-500-R	250	.66
GMA-600-R	250	.66
GMA-750-R	250	.66
GMA-800-R	250	.66
GMA-1-R	250	.54
GMA-1.5-R	250	.54
GMA-1.6-R	250	.54
GMA-2-R	250	.54
GMA-2.5-R	250	.54
GMA-3-R	250	.54
GMA-3.5-R	125	.54
GMA-4-R	125	.54
GMA-5-R	125	.54
GMA-6-R	125	.54
GMA-7-R	125	.54
GMA-8-R	125	.54
GMA-10-R	125	.54
GMA-15-R	125	.54



S501 HIGH BREAKING TYPE FUSES 250 VOLT FUSES, FAST ACTING

S501 are fast acting 250 Volt ceramic tube miniature fuses for foreign equipment, with a 1500 Amp interrupting rating at 250 Volts. These fuses meet IEC specification 127 sheet 1 and are covered by SEMKO 104 approval and CEE certification.

Cat. No.	Volts	Net Price
S501-50-R	250	\$3.86
S501-63-R	250	3.86
S501-80-R	250	3.86
S501-100-R	250	3.60
S501-125-R	250	3.60
S501-160-R	250	3.60
S501-200-R	250	3.60
S501-250-R	250	3.60
S501-315-R	250	3.60
S501-400-R	250	3.60
S501-500-R	250	3.39
S501-630-R	250	3.39
S501-800-R	250	3.39
GDA-1.25-R	250	2.16
GDA-1.6-R	250	2.16
GDA-2-R	250	2.16
GDA-2.5-R	250	4.48
GDA-3.15-R	250	2.16
GDA-4-R	250	2.16
GDA-5-R	250	2.16
GDA-6.3-R	250	2.16

5mm × 20mm FUSES



S500 LOW BREAKING TYPE FUSES 250 VOLT FUSES, FAST ACTING

S500 are fast acting 250 Volt miniature glass fuses, for foreign equipment, with a 35 Amp or 10 times current rating of fuse (whichever is larger) interrupting rating at 250 Volts. These fuses meet IEC specifications 127 sheet 2 and are covered by SEMKO 104 approval and CEE certification.

Cat. No.	Volts	Net Price
S500-32-R	250	\$4.28
S500-40-R	250	4.28
S500-50-R	250	4.28
S500-63-R	250	4.28
S500-80-R	250	4.28
S500-100-R	250	4.28
S500-125-R	250	2.97
S500-160-R	250	2.97
S500-200-R	250	2.97
S500-250-R	250	2.97
S500-315-R	250	2.97
S500-400-R	250	2.97
S500-500-R	250	2.42
S500-630-R	250	2.42
S500-800-R	250	2.42
S500-1A-R	250	2.42
S500-1.25-R	250	2.42
S500-1.6-R	250	2.42
S500-2-R	250	2.42
S500-2.5-R	250	2.42
S500-3.15-R	250	2.42
S500-4-R	250	2.42
S500-5-R	250	2.42
S500-6.3-R	250	2.42



S506 LOW BREAKING TYPE FUSES 250 VOLT FUSES, TIME DELAY

S506 time delay (for circuits with large surge currents) 250 Volt miniature glass fuses for foreign equipment. Meet IEC specification 127 sheet 3 and are covered by SEMKO 104 approval and CEE 4 certification. The interrupting rating is 35 Amps, 10 times current rating of fuse whichever is larger at 250 Volts.

Cat. No.	Volts	Net Price
S506-32-R	250	\$6.83
S506-40-R	250	6.83
S506-50-R	250	3.38
S506-63-R	250	3.38
S506-80-R	250	6.83
S506-100-R	250	1.97
S506-125-R	250	1.97
S506-160-R	250	1.97
S506-200-R	250	5.93
S506-250-R	250	1.97
S506-315-R	250	5.93
S506-400-R	250	1.97
S506-500-R	250	1.42
S506-630-R	250	1.42
S506-800-R	250	1.42
S506-1-R	250	1.42
S506-1.25-R	250	3.03
S506-1.6-R	250	3.03
S506-2-R	250	3.03
S506-2.5-R	250	3.03
S506-3.15-R	250	3.03
S506-4-R	250	3.03
S506-5-R	250	3.03
S506-6.3-R	250	3.03

1/4 × 1-1/4 INCH FUSES

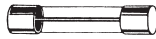

AGC TYPE FUSES FAST ACTING

These fast acting glass tube, visual indicating fuses are designed for instruments, electronic and small appliance circuits. Most common American size glass fuse. APPROVALS: AFC—1/500-10 UL listed, CSA; 12-35 UR.

Cat. No.	Volts	Net Price
TYPE AGC FUSES		
AGC-1/200-R	250	\$11.54
AGC-1/100-R	250	15.27
AGC-1/32-R	250	15.27
AGC-1/20-R	250	15.27
AGC-1/16-R	250	2.85
AGC-1/10-R	250	2.85
AGC-1/8-R	250	1.89
AGC-15/100-R	250	3.42
AGC-175/1000-R	250	3.42
AGC-3/16-R	250	2.84
AGC-2/10-R	250	1.89
AGC-1/4-R	250	1.76
AGC-3/10-R	250	2.14
AGC-3/8-R	250	1.76
AGC-4/10-R	250	1.96
AGC-45/100-R	250	3.28
AGC-1/2-R	250	.81
AGC-6/10-R	250	.81
AGC-3/4-R	250	.81
AGC-8/10-R	250	.81
AGC-1-R	250	.50
AGC-1-1/4-R	250	.53
AGC-1-1/2-R	250	.50
AGC-1-6/10-R	250	.50
AGC-1-3/4-R	250	.50
AGC-1-8/10-R	250	.92
AGC-2-R	250	.50
AGC-2-1/4-R	250	.50
AGC-2-1/2-R	250	.51
AGC-3-R	250	.50
AGC-3-2/10-R	250	.50
AGC-4-R	250	.80
AGC-5-R	250	.80
AGC-6-R	250	.84
AGC-6-1/4-R	250	.80
AGC-7-R	250	.84
AGC-7-1/2-R	250	.88
AGC-8-R	250	.93
AGC-9-R	250	.88
AGC-10-R	250	.88
AGC-12-R	32	.55
AGC-15-R	32	.55
AGC-20-R	32	.55
AGC-25-R	32	.55
AGC-30-R	32	.55
AGC-35-R	32	.59

1/4 × 1-1/4 INCH FUSES



MDA TYPE FUSES, TIME DELAY

Ceramic tube fuse, time delay type for circuits with high inrush currents. APPROVALS: MDA—2/10 UL listed, CSA; 25-30 UR.

Cat. No.	Volts	Net Price
MDA-1/32-R	250	\$8.45
MDA-1/16-R	250	8.45
MDA-1/10-R	250	8.45
MDA-1/8-R	250	8.45
MDA-15/100-R	250	8.45
MDA-2/10-R	250	9.10
MDA-1/4-R	250	3.24
MDA-3/10-R	250	5.93
MDA-3/8-R	250	5.93
MDA-4/10-R	250	5.93
MDA-1/2-R	250	3.24
MDA-6/10-R	250	5.93
MDA-3/4-R	250	5.93
MDA-8/10-R	250	5.93
MDA-1-R	250	3.24
MDA-1-1/4-R	250	3.24
MDA-1-1/2-R	250	3.24

Cat. No.	Volts	Net Price
MDA-1-6/10-R	250	\$5.93
MDA-2-R	250	3.24
MDA-2-1/2-R	250	2.26
MDA-2-8/10-R	250	4.12
MDA-3-R	250	2.26
MDA-3-2/10-R	250	4.12
MDA-4-R	250	2.26

TIME DELAY

MDA-5-R	250	2.26
MDA-6-R	250	2.26
MDA-6-1/4-R	250	2.26
MDA-7-R	250	2.26
MDA-8-R	250	2.26
MDA-10-R	250	2.26
MDA-12-R	250	2.26
MDA-15-R	250	2.26
MDA-20-R	250	2.26
MDA-25-R	125	2.26
MDA-30-R	125	1.37
HKP-R	Panel fuseholder	5.30

1/4 × 1-1/4 INCH FUSES



MDL TYPE FUSES TIME DELAY GLASS TUBE FUSES

Spiral wound time delay type. Time-delay/time lag glass for circuits with high inrush currents. APPROVALS: MDL—8A UL listed, CSA; 1-30 UR.

Cat. No.	Volts	Net Price
MDL-1/100-R	250	\$7.85
MDL-1/32-R	250	7.85
MDL-1/16-R	250	3.76
MDL-1/10-R	250	3.01
MDL-1/8-R	250	3.01
MDL-15/100-R	250	3.01
MDL-175/1000-R	250	5.72
MDL-3/16-R	250	3.01
MDL-2/10-R	250	3.01
MDL-1/4-R	250	1.81
MDL-3/10-R	250	1.81
MDL-3/8-R	250	1.81
MDL-4/10-R	250	1.81
MDL-1/2-R	250	1.74
MDL-6/10-R	250	1.74
MDL-7/10-R	250	1.74
MDL-3/4-R	250	1.74
MDL-8/10-R	250	1.74
MDL-1-R	250	1.74
MDL-1-2/10-R	250	1.32
MDL-1-1/4-R	250	1.32
MDL-1-1/2-R	250	1.32
MDL-1-6/10-R	250	1.32
MDL-1-8/10-R	250	1.32
MDL-2-R	250	1.32
MDL-2-1/4-R	250	1.32
MDL-2-1/2-R	250	1.32
MDL-2-8/10-R	250	2.71
MDL-3-R	250	1.32
MDL-3-2/10-R	250	1.32
MDL-3-1/2-R	250	1.32
MDL-4-R	250	1.32
MDL-5-R	250	1.32
MDL-6-R	250	1.32
MDL-6-1/4-R	250	1.32
MDL-7-R	250	1.32
MDL-7-1/2-R	250	1.32
MDL-8-R	250	1.32
MDL-9-R	32	1.32
MDL-10-R	32	1.94
MDL-12-R	32	1.94
MDL-15-R	32	1.94
MDL-20-R	32	1.94
MDL-25-R	32	1.94
MDL-30-R	32	1.94
HKP-R	Fuseholder	5.30

13/32 × 1-3/8 INCH FUSES



BBS TYPE FUSES FAST ACTING 600 V FUSES

Fibre tube. Designed for the protection of control circuits, gaseous vapor fixture circuits or where fast acting characteristics are desired. Used in Buss HPF-L fuseholders or 3845 fuseblocks. APPROVALS: UL 0-5A/600V; CSA.

Cat. No.	Volts	Net Price
BBS-2/10	600	\$10.45
BBS-4/10	600	10.45
BBS-3/4	600	10.45
BBS-8/10	600	10.45
BBS-1	600	5.67
BBS-1-1/2	600	10.45
BBS-1-6/10	600	10.45
BBS-1-8/10	600	10.45
BBS-2	600	6.97
BBS-3	600	6.97
BBS-4	600	9.34
BBS-5	600	6.97
BBS-6	250	10.45
BBS-7	250	10.45
BBS-8	250	10.45
BBS-10	48	9.88
BBS-15	48	10.45
BBS-20	48	10.45
BBS-25	48	10.45
BBS-30	48	10.45
HPF-L	Fuseholder	16.73

13/32 × 1-1/2 INCH FUSES



AGU TYPE FUSES GLASS TUBE TYPE NON-TIME DELAY FUSES—FAST ACTING

For overload and or short circuit protection in primarily resistive load circuits. Glass tube permits visual indication of element. Use with HPF fuseholder.

Cat. No.	Volts	Net Price
AGU-1	250	\$3.94
AGU-2	250	3.94
AGU-3	250	3.84
AGU-4	32	3.84
AGU-5	32	3.84
AGU-8	32	3.84
AGU-10	32	3.91
AGU-15	32	3.91
AGU-20	32	3.58
AGU-25	32	3.58
AGU-30	32	3.30
AGU-35	32	3.58
AGU-40	32	3.30
AGU-50	32	3.58
AGU-60	32	3.58
HPF	Fuseholder	11.11

13/32 × 1-1/2 INCH FUSES



BAF TYPE FUSES LAMINATED TUBE TYPE

Recommended as higher voltage replacement for AGU fuses. Use with HPF fuseholder. APPROVALS: UL listed. BAF-0-15A/250V; CSA.

Cat. No.	Volts	Net Price
BAF-1/2	250	\$6.00
BAF-1	250	3.99
BAF-1-1/2	250	6.00
BAF-2	250	3.99
BAF-2-1/2	250	6.00
BAF-3	250	3.99
BAF-4	250	6.00
BAF-5	250	3.99
BAF-6	250	3.99
BAF-6-1/4	250	6.18
BAF-7	250	4.87
BAF-8	250	4.87
BAF-9	250	4.87
BAF-10	250	3.24
BAF-12	250	4.87
BAF-15	250	3.66
BAF-20	125	3.24
BAF-25	125	4.66
BAF-30	125	3.24
HPF	Fuseholder	11.11

5mm × 15mm GLASS FUSES

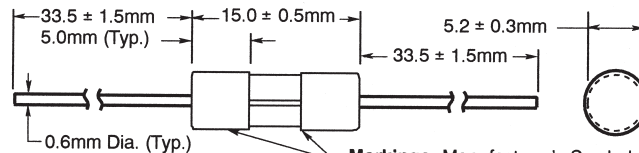

Dimensions are in Millimeters (mm)

Markings: Manufacturer's Symbol, Product Symbol, Voltage, Ampere, Testing Agency Mark (Optional)

Packaging & Ordering Information:

Package Code	C515 Product Symbol	Ampere Rating
BK/ Bulk Package (100 pcs)		125mA
		250mA
		350mA
		375mA
		500mA
		600mA
		750mA
		1A
		1.25A
		1.5A
		1.6A
		2A
		2.25A
		2.5A
		3A
		3.5A
		4A
		5A
		7A

C515 TIME-DELAY AXIAL LEADED 5MM × 15MM GLASS FUSES

Telecommunication Capabilities: UL 1459: Telephone equipment. Fuses successfully opened: 600 V (AC)—40 Amps. 600 V (AC)—7 Amps. 600 V (AC)—2.2 Amps. UL 497: Protectors for paired conductor communications circuits. Fuses successfully passed without opening: 10 × 1000 microsecond wavefore †50 pulses/1 pulse every 8 seconds @ 1000 V (Note: † fuse resistance was not allowed to vary by more than five percent after completion of the test). UL listing: Guide # JDYX, file E75865. CSA Certification: Class 1422-01, file LR65063. UL Recognized: Guide # JDYX2, file E75865.

Cat. No.	Rtd Voltage (V) AC	Voltage Drop (mV) max.	Net Price
C515-1.25-R	250	220	\$1.48
C515-1.5-R	250	200	1.48

FRN-R TYPE FUSES 250 VOLT FUSES

Cat. No.	Volts	Net Price
5/16" DIAMETER x 2" LENGTH		
FRN-R-1/4	250	\$15.91
FRN-R-1/2	250	12.18
FRN-R-1	250	10.33
FRN-R-1-6/10	250	10.57
FRN-R-1-8/10	250	15.91
FRN-R-2	250	8.55
FRN-R-2-1/2	250	11.91
FRN-R-3	250	9.47
FRN-R-3-2/10	250	9.47
FRN-R-3-1/2	250	11.01
FRN-R-4	250	9.47
FRN-R-4-1/2	250	11.01
FRN-R-5	250	7.84
FRN-R-6	250	9.47
FRN-R-6-1/4	250	10.91
FRN-R-7	250	11.01
FRN-R-8	250	9.47
FRN-R-10	250	7.84
FRN-R-12	250	9.47
FRN-R-15	250	6.30
FRN-R-20	250	6.30
FRN-R-25	250	6.30
FRN-R-30	250	6.30
3/16" DIAMETER x 3" LENGTH		
FRN-R-35	250	11.48
FRN-R-40	250	11.48
FRN-R-45	250	11.48
FRN-R-50	250	11.48
FRN-R-60	250	11.48
5/32" DIAMETER x 5 7/8" LENGTH		
FRN-R-70	250	25.82
FRN-R-80	250	25.82
FRN-R-100	250	25.82
5/32" DIAMETER x 7 1/8" LENGTH		
FRN-R-125	250	56.78

FRS-R TYPE FUSES 600 VOLT FUSES

Cat. No.	Volts	Net Price
3/4" DIAMETER x 5" LENGTH		
FRS-R-1	600	\$20.69
FRS-R-1-6/10	600	20.69
FRS-R-2	600	17.00
FRS-R-2-1/2	600	20.69
FRS-R-3	600	15.80
FRS-R-4	600	15.80
FRS-R-5	600	15.80
FRS-R-6	600	15.80
FRS-R-6-1/4	600	19.26
FRS-R-7	600	19.26
FRS-R-8	600	15.80
FRS-R-10	600	15.80
FRS-R-12	600	15.80
FRS-R-15	600	13.92
FRS-R-20	600	13.92
FRS-R-25	600	13.92
FRS-R-30	600	13.92
1" DIAMETER x 5 1/2" LENGTH		
FRS-R-35	600	23.88
FRS-R-40	600	23.88
FRS-R-45	600	23.88
FRS-R-50	600	23.88
FRS-R-60	600	23.88
1 1/4" DIAMETER x 7 7/8" LENGTH		
FRS-R-70	600	49.38
FRS-R-100	600	49.38
1 3/4" DIAMETER x 9 5/8" LENGTH		
FRS-R-125	600	98.80
FRS-R-200	600	98.80



NORTH AMERICAN STYLE HIGH SPEED FUSES

These specialized devices provide low energy let-thru (I²T), low watts loss, superior cycling capacity, low arc voltage, as well as excellent DC performance. These devices provide an excellent solution for medium power applications. UL recognized, STD 248-13.

Cat. No.	Volts	Net Price
FWA-200A	150	\$31.75
FWA-250A	150	31.75

Cat. No.	Volts	Net Price
FWX-50A	250	\$68.85
FWX-60A	250	68.85
FWX-70A	250	82.90
FWX-80A	250	90.19
FWX-100A	250	82.90

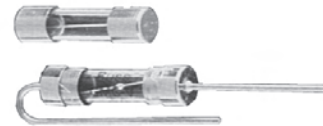

TYPE GMC

Type GMC 5mm x 20mm. Time-Lag. Glass Body, Electroplated end caps.

Cat. No.	Volts	Net Price
GMC-63-R	250	\$2.26
GMC-100-R	250	2.29
GMC-200-R	250	2.29
GMC-250-R	250	1.35
GMC-315-R	250	2.29
GMC-500-R	250	1.04
GMC-600-R	250	1.43
GMC-750-R	250	1.43
GMC-800-R	250	1.04
GMC-1-R	250	1.04
GMC-1.5-R	250	1.43
GMC-1.6-R	250	1.43
GMC-2-R	250	1.04
GMC-2.5-R	250	1.26
GMC-3-R	250	1.04
GMC-3.15-R	250	1.43
GMC-3.5-R	125	1.43
GMC-4-R	125	1.04
GMC-5-R	125	1.04
GMC-6-R	125	1.04
GMC-8-R	125	1.43
GMC-10-R	125	1.04

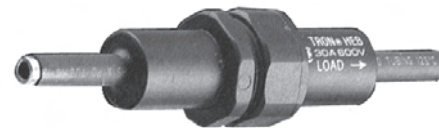

TYPE HEB IN-LINE WATER-PROOF

For 1 3/32" x 1 1/2" Fuses KTK, FNM, BAF, FNQ. Waterproof for exposed location. Accepts various wire sizes #14-#4 solid. Body Matl: Phenolic. Lead Matl: Copper Crimp.

FUSEHOLDER WITHOUT BREAK-A-WAY

Cat. No.	Wire Size		Net Price
	Load	Line	
HEB-AA	#12-#8	#12-#8	\$20.24