

## TINI "Q-G" MINIATURE AUDIO AND GENERAL PURPOSE CONNECTORS

Tini "Q-G" connectors may be connected to switchcraft "Q-G", QGP and other similar connectors by using Switchcraft Series TA Adapters. Miniature connectors are ideal for use with slim lavalier microphones and miniature instrumentation. Features: plugs and receptacles: 3, 4, or 5 pin/contacts; full cable clamp and flex relief "Through-Connector" shielding; latch locking polarized mating; "scoop-proof" pin protection. **Series TA(\*F)**—straight cord plugs (3, 4 or 5 contacts), nickel finish, neoprene parts, 1.9 in. (48.3mm) lg.; .413 in. (10.5mm) housing dia. **Series TA(\*M)**—cord plug .204 in. (5.18mm) lg.; .413 (10.5mm) **Series TB(\*M)**—receptacle designed for chassis/panel mtg. Specially designed flange permits close (front) mtg. on crowded panels. Length: .703 in. (17.86mm), Front Mount .25 in. (6.35mm) max. Terminals accommodate wire leads, #21 AWG solid or #24 AWG stranded. **Series TY(\*F)**—receptacles mount in min. space from front or rear. Receptacles have separate grounding lug. Length: .978 in. (24.84), Front Mount .375 in. (9.5mm), Rear Mount .093 in. (2.3mm). Series TY(\*F) solder lugs, #18 AWG solid or #20 AWG stranded. **SERIES TRA(\*M)** low profile male receptacles mount in minimum space from the rear of panel or chassis, and feature space-saving right-angle construction and PC type terminals. Cost-effective choice for audio equipment, medical instrumentation. Computer equipment and test/measurement applications.

Cat. No.	Insert Contacts	Net Price Each			
		1-9	10-99	100-499	500-Up
<b>CORD PLUGS</b>					
TA3F	3	\$24.24	\$12.12	\$8.49	\$6.27
TA4F	4	26.26	13.14	9.19	6.79
TA5F	5	28.17	14.09	9.86	7.28
TA6F	6	28.62	14.32	10.02	7.39
TA3M	3	20.20	10.10	7.07	5.22
TA4M	4	22.00	11.00	7.70	5.69
TA5M	5	24.47	12.25	8.55	6.32
TA6M	6	25.14	12.57	8.79	6.49

<b>RECEPTACLES</b>					
TB3M	3	22.22	11.12	7.77	5.74
TB4M	4	24.47	12.25	8.55	6.32
TB5M	5	26.60	13.29	9.32	6.86
TY3F	3	26.04	13.02	9.12	6.74
TY4F	4	28.17	14.09	9.86	7.28
TY5F	5	29.97	14.99	10.50	7.75

<b>PC MOUNT MALE RECEPTACLES</b>					
TRA3M	3	23.23	11.62	8.14	6.00
TRA6M	6	34.68	17.33	12.13	8.96
TRA6MF*	6	36.03	18.01	12.61	9.31

\*Designates ferrite shielding.

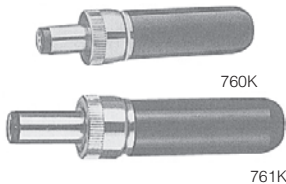

## "POWER-PLUG" BATTERY CHARGER PLUGS

Two conductor battery charger plugs mate with sockets used on portable radios, tape recorders, appliances which have A.C. adapters, and/or battery chargers. **760** and **765** have a hollow center pin with 0.1 inch dia. center hole, .328 inches deep. **S760** and **S765**, same as **760** and **765**, except center hole is 0.08 inch inside dia. Plugs with Cat. No. ending in **K** have a locking that provides a secure power connection. Mates with Switchcraft "Power Jax". Plug sleeve and ring: Brass, nickel plated. Lockring: Brass, nickel plated. Handle: Molded plastic. Sleeve terminals: Brass, electro-tinned.

Cat. No.	Handle	Typical Mating Jack	Net Price Each		
			1-9	10-99	100-Up
760	Black	712A	\$8.64	\$4.31	\$3.03
765	Red	712A	8.75	4.39	3.06
760K	Black	712A	12.57	6.29	4.41
761K	Black	L712A	12.57	6.29	4.41
765K	Red	712A	12.57	6.29	4.41
766K	Red	PC712A	12.80	6.41	4.47
S760	Black	722A	8.64	4.31	3.03
S765	Red	722A	8.64	4.31	3.03
S760K	Black	PC722A	12.57	6.29	4.41
S761K	Black	L722A	12.57	6.29	4.41
S765K	Red	722A	12.57	6.29	4.41
S766K	Red	PCL722A	12.57	6.29	4.41



712A



PC722A

## SWITCHCRAFT "POWER-JAX"

Designed for AC/DC power converter and/or battery charger connections for electronic equipment and appliances, such as cassette recorders/players, TV receivers, radios and hand-held miniature calculators. Silver plated sleeve shunt spring permits automatic switch-over from AC to DC (battery) operation when AC power plug is disconnected. Power jacks are 2-cond. type with shunted sleeve. Behind panel space .609" max. **No. 712A** mounts in .312" dia. hole in panels up to .125" thick max. and have silver plated solder lugs. **No. PC712A**, PC terminals fit in .062" dia. holes. **Nos. 712A** and **PCL712A** accept plugs with .475" long, 0.10" diameter finger. **Nos. L722A** and **PCL722A** accept plugs with .475" long, 0.08" diameter finger. Insulation resistance: 10,000 MΩ min. (initial). Electric withstanding voltage: 500VAC max. Contact rating: 5A, 12VDC, resistive. Mates with Switchcraft Power Plugs.

Cat. No.	Mating Plug	Pin. Dia.	Net Price Each		
			1-9	10-99	100-Up
712A	760, 765, 760K	.100"	\$8.64	\$4.31	\$3.03
L712A	761K	.100"	11.78	5.89	4.12
PC712A	766K	.100"	8.64	4.31	3.03
PCL712A	761K, 766K	.100"	11.78	5.89	4.12
722A	S760	.080"	8.64	4.31	3.03
L722A	S761K	.080"	11.78	5.89	4.12
PC722A	S760K	.080"	8.64	4.31	3.03
PCL722A	S761K, S760K	.080"	11.78	5.89	4.12

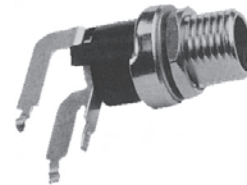

## PC MOUNT RIGHT ANGLE LOCKING POWER JACKS

These power jacks have threaded bushings to allow use of both standard and locking power plugs. Three center pin diameters: 0.100", 0.080", and 0.050". Kinked terminals allow snap-in PC board mounting. Automatic switch over from AC to DC permitted by sleeve shunt spring. Split center pin shaped to hold mating plug firmly. Standard version has 0.219" long bushing. L version has 0.319" long bushing to permit use of thicker panels. L version also accepts plugs with 0.475" long plug fingers. Non-turn mounting possible using standard "D" shape bushing. These plugs can be used for DC-powered hand held instrumentation, portable computers, cellular/portable phones, battery chargers and external low voltage power supplies for instrumentation and more. Life: 10,000 insertion/withdrawal cycles min. Insulation resistance: 10,000 MΩ minimum (initial). Dielectric withstanding voltage: 500VAC maximum. Contact rating: 5A, 12VDC resistive. Housing: Molded plastic. Pin, spring and terminals: Plated copper alloy. Insulators: Rigid plastic.

Cat. No.	Description	Net Price Each		
		1-9	10-99	100-Up
712RA	Right angle PC mount, 0.100" diameter pin	\$9.54	\$4.76	\$3.34
722RA	Right angle PC mount, 0.080" diameter pin	9.54	4.76	3.34
732RA	Right angle PC mount, 0.050" diameter pin	4.06	3.05	2.54
L712RA	Right angle PC mount, 0.100" diameter pin, 0.319" long bushing	12.68	6.34	4.43
L722RA	Right angle PC mount, 0.080" diameter pin, 0.319" long bushing	12.68	6.34	4.43
L732RA	Right angle PC mount, 0.050" diameter pin, 0.319" long bushing	4.55	3.88	3.19



**AUTO LIGHTER PLUG**

Cat. No.	Net Price
31-089-0	\$5.55



**AUTO PLUG/CORD**

Cat. No.	Description	Net Price
31-097-0	2.5mm R/A Plug/Fuse/LED 6' Cord	\$1.50
31-099-0	2.1mm Plug 8' Cord	2.13

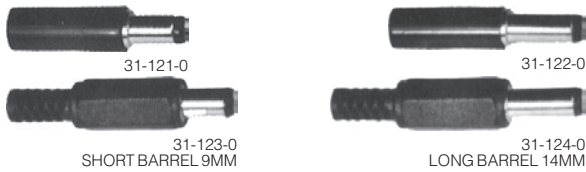

**DC POWER PLUGS**

Cat. No.	Description	Net Price
31-101-0	1.3mm short	\$5.53
31-121-0	2.1mm short	.47
31-122-0	2.1mm long	.52
31-123-0	2.1mm short S/R	.45
31-124-0	2.1mm long S/R	.50
31-141-0	2.5mm short	.43
31-142-0	2.5mm long	.48
31-143-0	2.5mm short S/R	.43
31-144-0	2.5mm long S/R	.48
31-161-0	3.0mm short	.73



**DC POWER JACKS**

Cat. No.	Description	Net Price
31-133-0	2.1mm plastic	\$2.25
31-152-0	2.5mm plastic	1.08



**DC POWER JACKS**

Single hole mounting. Isolated from chassis. 13mm chassis hole.

Cat. No.	Description	Net Price
31-134-0	2.1mm	\$8.83
31-154-0	2.5mm	.92



**DC POWER JACKS**

Compact isolated chassis mount DC power jacks. 8mm mounting hole.

Cat. No.	Description	Net Price
31-134M-0	2.1mm	\$1.18
31-154M-0	2.5mm	1.12

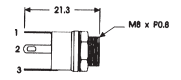

**DC POWER JACKS SINGLE HOLE MOUNTING**

Cat. No.	Description	Net Price
31-157-0	2.1mm	\$1.08
31-158-0	2.5mm	1.08

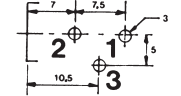
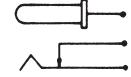

**PC MOUNT DC POWER JACKS**

Cat. No.	Description	Net Price
31-150-0	1.3mm	\$2.28
31-155-0	The material used in the manufacturing of this part is made with an ABS material and has a 150° melting point and therefore not suitable for wave soldering. 2.1mm	.32
31-156-0	Same as above, only 2.5mm	.32
31-155A-0	This part is made with an ABS material and has a 150° melting point and therefore not suitable for wave soldering. 2.1mm	.24
31-156A-0	Same as above, only 2.5mm	.24
31-155S-0	GE Valox 420SEO is the material used in making this part. It also has a melting point of approximately 250° C and is considered the best of the three. 2.1mm	.32
31-156S-0	Same as above, but 2.5mm	.36



2.5MM

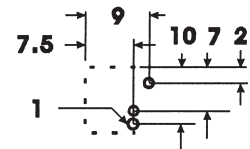

**PC MOUNT DC POWER JACKS**

Cat. No.	Net Price
31-159-0	\$1.00

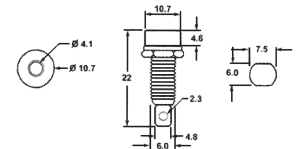

**MULTI-COLOUR CHASSIS MOUNTING BANANA JACKS**

Cat. No.	Colour	Net Price
31-410-2	1 black, 1 red	\$1.40
31-411-0	Black	.55
31-412-0	Red	.55
31-413-0	Orange	.60
31-414-0	Yellow	.55
31-415-0	Green	.55
31-416-0	Blue	.55
31-417-0	Violet	.55
31-419-0	White	.55
31-410-6	Multi-colour assortment	3.67

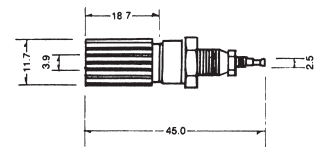
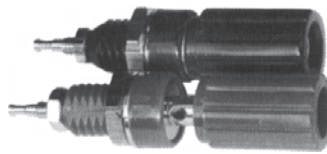

**BINDING POSTS**

Cat. No.	Description	Net Price
31-421-0	Black	\$9.98
31-425-0	Green	.98
31-422-0	Red	.98