

### SPADE TONGUE TERMINALS (PRE-INSULATED DIAMOND GRIP)

Cat. No.	Colour Code	Wire Size (AWG)	Tongue Material Thickness	Stud Size	Max. Insulation	Dimensions (in.)					Net Price Per 1000
						W	C	E	L	X	
327717	Red	22-16	.033	4	.140	.218	.156	.560	.674	.109	\$424.20
34541	Red	22-16	.033	6	.140	.250	.312	.716	.846	.125	98.08
32054	Red	22-16	.033	10	.140	.375	.312	.716	.908	.187	348.65
35559	Blue	16-14	.033	6	.170	.297	.203	.607	.753	.141	348.65
32059	Blue	16-14	.033	8	.170	.385	.312	.716	.908	.187	348.65
32589	Yellow	12-10	.042	10	.230	.406	.296	.887	1.095	.203	435.93

NOTE: Other stud sizes available. Please contact your Electro Sonic sales representative for more information.

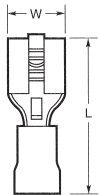

.250 SERIES

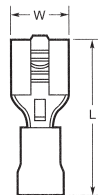

.205 SERIES

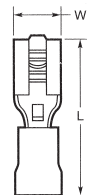

.187 SERIES

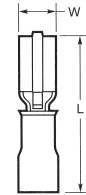

.110 SERIES-  
STANDARD

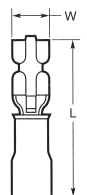

.110 SERIES-  
LOW INSERTION

### AMP FASTON RECEPTACLES (PRE-INSULATED DIAMOND GRIP)

Cat. No.	Colour Code	Wire Size (AWG)	Series	Max. Insulation	Receptacle Material	Stock Thickness	Fits Tab Thickness	Dimensions (in.)		Net Price Per 1000
								W	L	
<b>DIMPLE WITH WIRE STOP</b>										
640903-1	Red	22-18	.250	.140	Brass	.018	.032	.300	.900	\$112.18
640905-1	Blue	16-14	.250	.170	Brass	.018	.032	.300	.900	112.18
640907-1	Yellow	12-10	.250	.250	Brass	.018	.032	.300	1.012	164.26
640909-1	Red	22-18	.205	.140	Brass	.016	.020	.250	.800	149.13
640911-1	Red	22-18	.205	.140	Brass	.016	.032	.250	.800	149.13
640915-1	Blue	16-14	.205	.170	Brass	.016	.032	.250	.800	152.13
640917-1	Red	22-18	.187	.140	Brass	.016	.020	.230	.800	112.18
640919-1	Blue	16-14	.187	.170	Brass	.016	.020	.230	.800	149.13
<b>NO DIMPLE WITH WIRE STOP</b>										
640923-1*	Red	22-18	.110	.140	Brass	.016	.202	.160	.800	149.13
640925-1*	Red	22-18	.110	.140	Brass	.016	.032	.160	.800	149.13
640929-1	Blue	16-14	.110	.170	Brass	.016	.020	.160	.800	149.13

\*Low insertion.

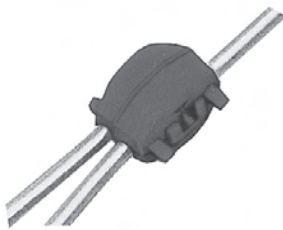

### ELECTRO-TAP® CONNECTORS

Easy two-step operation: (1) Butt tap-wire against wire stop, fold top cover half over to meet base, and squeeze with pliers until latch locks. (2) Lay run-wire in remaining section, fold over to meet base, and squeeze to latch as before.

Cat. No.	Wire AWG	Description	Net Price Per 1000
53440-2	20-18	UL/CSA for 20-18AWG solid, 18 AWG stranded with 20 AWG solid	\$258.09
53440-1	18-14	UL/CSA for 18-14AWG solid, 14 AWG stranded with 16 or 18 AWG solid	264.54



### CLOSED END AND WIRE CONNECTORS

Cat. No.	Description	Net Price Per 1000
<b>CLOSED END CONNECTORS</b>		
35653	22-10 AWG .375 minimum insulation opening dia.	\$79.23
<b>WIRE CONNECTORS</b>		
600699-1	Size: Small 11/32" maximum 2 each 16 AWG stranded	360.60
600699-2	Size: Medium 7/16" maximum 2 each 12 AWG stranded	657.60
600699-3	Size: Large 1/2" maximum 2 each 10 AWG stranded	910.61

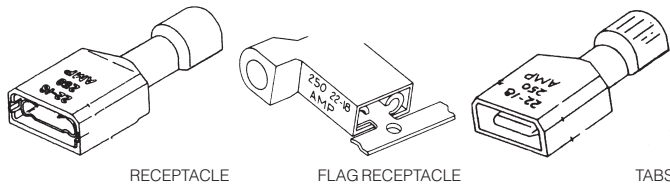

## AMP ULTRA-FAST FULLY INSULATED FASTON RECEPTACLES AND TABS

**MATERIAL:** Housing: Nylon type 6/6. Terminal: Tin-plated, copper. Terminal base material: Brass.

Cat. No.	Wire Range (AWG)	Ins. Dia. Max.	Mating Tab	Net Price
<b>RECEPTACLES, .187 SERIES, COLOUR CODE: RED (TRANSLUCENT)</b>				
2-520182-2	22-18	.135	.020 x .187	<b>\$.10</b>
2-520194-2	22-18	.135	.020 x .187	<b>.11</b>
<b>RECEPTACLES, .250 SERIES, COLOUR CODE: RED (TRANSLUCENT)</b>				
2-520184-2	22-18	.135	.032 x .250	<b>.11</b>
2-520264-2	22-18	.230	.032 x .250	<b>.13</b>
<b>RECEPTACLES, .250 SERIES, COLOUR CODE: BLUE (TRANSLUCENT)</b>				
3-350820-2	16-14	.160	.032 x .250	<b>.11</b>
3-520141-2	16-14	.260	.032 x .250	<b>.12</b>
<b>RECEPTACLES, .250 SERIES, COLOUR CODE: YELLOW (TRANSLUCENT)</b>				
4-520448-2	12-10	.320	.032 x .250	<b>.15</b>
<b>TABS, .250 SERIES, COLOUR CODE: RED (TRANSLUCENT)</b>				
2-520103-2	22-18	.135	.032 x .250	<b>.20</b>
<b>TABS, .250 SERIES, COLOUR CODE: BLUE (TRANSLUCENT)</b>				
3-520107-2	16-14	.160	.032 x .250	<b>.19</b>
<b>FLAG RECEPTACLES, .187 SERIES, COLOUR CODE: RED (TRANSLUCENT)</b>				
2-520337-2	22-18	.165	.032 x .187	<b>.19</b>
<b>FLAG RECEPTACLES, .250 SERIES, COLOUR CODE: RED (TRANSLUCENT)</b>				
2-520129-2	22-18	.165	.032 x .250	<b>.18</b>
<b>FLAG RECEPTACLES, .250 SERIES, COLOUR CODE: BLUE</b>				
3-520133-2	16-14	.185	.032 x .250	<b>.19</b>

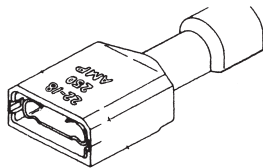

## AMP ULTRA-FAST PLUS—FULLY INSULATED FASTON RECEPTACLES

**MATERIAL:** Housing: Nylon. Terminal: Tin-plated, copper. Terminal base material: Brass.

Cat. No.	Wire Range (AWG)	Ins. Dia. Max.	Mating Tab	Net Price Per 1000
<b>RECEPTACLES, .187 SERIES, COLOUR CODE: RED (TRANSLUCENT)</b>				
2-520409-2	22-18	.060-.135	.020 x .187	<b>\$145.96</b>
<b>RECEPTACLES, .250 SERIES, COLOUR CODE: RED (TRANSLUCENT)</b>				
2-520407-2	22-18	.060-.135	.032 x .250	<b>159.07</b>
<b>RECEPTACLES, .250 SERIES, COLOUR CODE: BLUE (TRANSLUCENT)</b>				
3-520408-2	16-14	.090-.160	.032 x .250	<b>159.07</b>

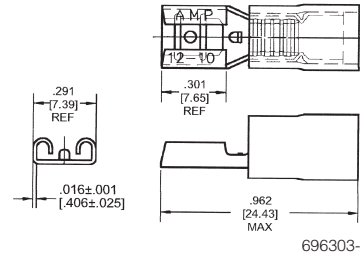
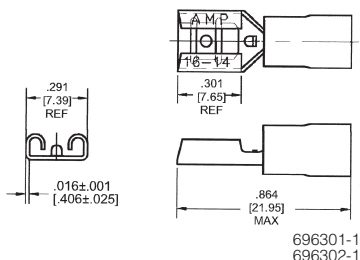

## BUDGET FASTON® RECEPTACLES

AMP Budget FASTON Receptacles consist of a tin-plated brass body with an insulated metal sleeve fitted over the terminal barrel. .250 x .032 series. Can accommodate 22-18, 16-14, and 12-10 wire ranges. Meets requirements of UL 310. **APPLICATIONS:** Automotive, lawn equipment, instrumentation, motors, and power supplies. **MATERIALS:** Terminal body: tin-plated brass. Insulator: PVC. Metal sleeve: tin-plated copper.

Cat. No.	Wire Size (AWG)	Net Price Per 1000
696301-1	22-18	<b>\$217.84</b>
696302-1	16-14	<b>223.89</b>
696303-1	12-10	<b>355.38</b>

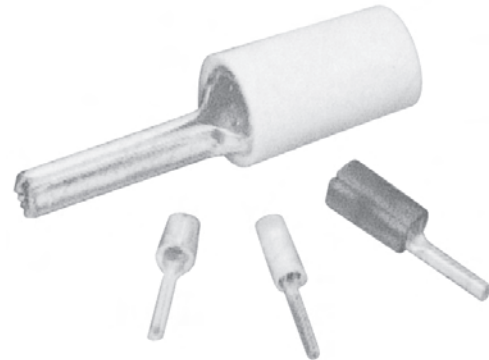

## AMP WIRE PINS

AMP Wire Pins consist of a solid metal pin either with or without plastic insulation on one end. They allow the easy and reliable connection of flexible leads with screw or spring clamps. The individual wires of the lead are crimped in the crimp section of the connector, providing a superior mechanical and electrical connection. Colour-coded insulation protects the crimped connection from contact. **APPLICATIONS:** Switching cabinets. Control units. Any equipment with row clamp or poke-in clamp connectors. **PIN MATERIAL:** Tin-plated copper.

Cat. No.	Type	Wire Range (AWG)	Length (In.)	Net Price Per 1000
736066	TERMINYL	6	1.543	<b>\$7485.16</b>
736067	TERMINYL	4	1.724	<b>2777.12</b>
736068	TERMINYL	2	2.067	<b>1965.92</b>
165142	PIDG	22-16	0.776	<b>613.17</b>
165168	PIDG	22-16	0.906	<b>975.83</b>
165046	PIDG	16-14	0.775	<b>592.44</b>
165172	PIDG	16-14	0.929	<b>1086.72</b>
165049	PIDG	12-10	1.122	<b>1291.87</b>
165143	PLASTIC-GRIP	22-16	0.807	<b>655.28</b>
165167	PLASTIC-GRIP	22-16	0.937	<b>577.03</b>
165075	PLASTIC-GRIP	16-14	0.815	<b>524.23</b>
165171	PLASTIC-GRIP	16-14	0.933	<b>496.39</b>
165085	PLASTIC-GRIP	12-10	1.150	<b>707.23</b>
165045	SOLISTRAND	16-14	0.565	<b>379.75</b>
165048	SOLISTRAND	12-10	0.815	<b>269.74</b>
736013	SOLISTRAND	6	1.236	<b>1947.61</b>
736014	SOLISTRAND	4	1.400	<b>4021.43</b>

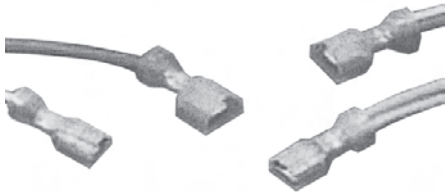

## AMP ULTRA-FAST TAB L.I.D. (LARGE INSULATION DIAMETER)

Fully insulated FASTON .250" x .032" tab, supporting 22-18 AWG and 16-14 AWG wire with large insulation diameters of .230" and .260", respectively. Mates to Ultra-Fast Receptacle L.I.D. product, providing a complete in-line disconnect solution for large or multiple wire designs. One-piece fully insulated tab housing promotes safer applications eliminating the chance of shorting. Recessed tab housing will accommodate 600V applications. Translucent housing allows for visual inspection of the crimp. Terminates solid, fused and stranded wire. UL Listed, CSA Certified and VDE Tested. **APPLICATIONS:** Used in HVAC, machine tools, power supplies and power applications. **MATERIALS:** Housing: Type 6/6 nylon. Tab: Tin plated brass.

Cat. No.	Wire Size (AWG)	Net Price Per 1000
2-521192-2	22-18	\$273.10
3-521191-2	16-14	273.10

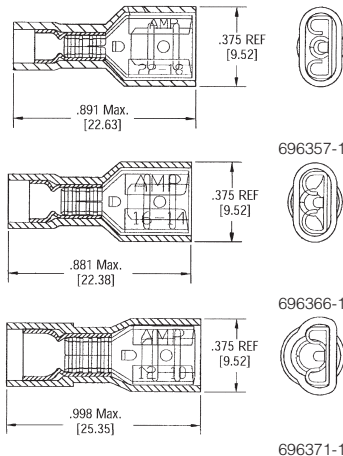

## FULLY INSULATED PIDG® FASTON RECEPTACLE

AMP fully insulated PIDG FASTON receptacles consist of a tin-plated brass FASTON body with full nylon insulation. A metal support sleeve fitted over the wire termination barrel provides circumferential insulation support to the wire after crimping. This allows the wire to be bent in any direction, without fraying the wire's insulation or breaking the conductor. .250 x .032 (6.35 x .81) series. **APPLICATIONS:** Power supplies, automotive, motors, instrumentation, and terminal blocks. **MATERIAL:** Insulation material: nylon. Support sleeve: copper. FASTON body: brass.

Cat. No.	Wire Size (AWG)	Net Price
696357-1	22-18	\$.28
696366-1	16-14	.27
696371-1	12-10	.41

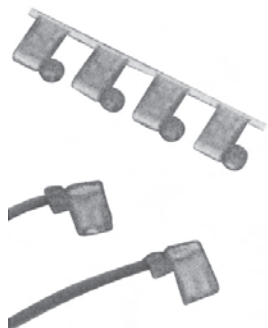

## AMP ULTRA-FAST .205 SERIES FASTON FLAG RECEPTACLE

Eliminates the need to post-insulate quick connects for applications in appliances, consumer electronics and industrial controls where .205 quick connect tabs are used. Permits tighter packaging of tabs without the concern over electrical shorts between contacts. Terminates 22-18 AWG stranded conductors with insulation diameters up to .165 inches. Uses same tooling as other Ultra-Fast product. Tin plated copper alloy contacts are thermal stress relieved for resistance to application overstressing. **APPLICATIONS:** Used in dishwashers, washers and dryers, refrigerators, ranges, small home appliances, lawn and garden equipment, HVAC units, vending machines, motorcycles, cars, trucks and other off-highway vehicles. **MATERIALS:** Housing: Type 6/6 nylon. Receptacle: Tin plated brass.

Cat. No.	Wire Size (AWG)	Net Price Per 1000
2-521192-2	22-18	\$273.10

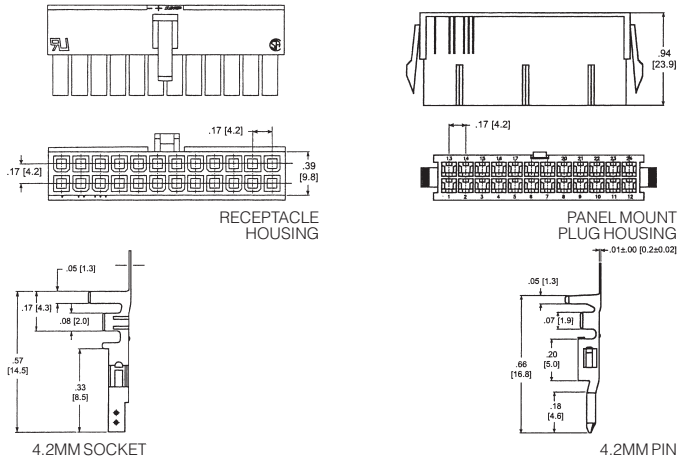

## SERIES PE LOW COST WIRE-TO-WIRE CONNECTORS WITH 4.2MM X 4.2MM CENTERLINE

Easy mate and unmate with positive latch design. 2-24 positions, receptacle and panel mount plug. Intermateable with Molex Mini-Fit, Jr, and AMP-DUAC connectors. Voltage: 600VAC. Current: 9 amps max. 2-position applications. Dielectric withstanding voltage: 1500VAC min. Insulation resistance: 1000 megohms min. UL/CSA. **APPLICATIONS:** Harness assemblies used in the vending, gaming, and appliance industries. **MATERIALS:** Housing: nylon, UL 94V-2. Contacts: brass, tin-plated.

Cat. No.	No. of Positions	Net Price
<b>PANEL MOUNT PLUG HOUSING</b>		
794953-2	2	\$.14
794953-4	4	.15
794953-6	6	.17
794953-8	8	.19
1-794953-0	10	.20
1-794953-2	12	.23
1-794953-4	14	.24
1-794953-6	16	.27
1-794953-8	18	.29
2-794953-0	20	.32
2-794953-2	22	.40
2-794953-4	24	.44
<b>RECEPTACLE HOUSING</b>		
794954-2	2	.14
794954-4	4	.15
794954-6	6	.16
794954-8	8	.19
1-794954-0	10	.20
1-794954-2	12	.23
1-794954-4	14	.25
1-794954-6	16	.27
1-794954-8	18	.30
2-794954-0	20	.32
2-794954-2	22	.35
2-794954-4	24	.39

Continued on next page...