

Cat. No.	"L" Length (Inches)	Net Price Per 1000		
		1-499	500-999	1000-Up
6-32 THREAD				
1903A	1/4 (.250)	\$466.68	\$328.53	\$212.14
1903B	3/8 (.375)	477.62	336.24	217.12
1903C	1/2 (.500)	497.57	350.29	226.19
1903F	5/8 (.625)	433.42	305.12	197.03
1903D	3/4 (.750)	639.18	449.98	290.56
1903G	7/8 (.875)	488.20	343.69	221.93
1903F	1 (1.000)	433.42	305.12	197.03
8-32 THREAD				
1904A	1/4 (.250)	466.68	328.53	212.14
1904B	3/8 (.375)	477.62	336.24	217.12
1904C	1/2 (.500)	497.57	350.29	226.19
1904F	5/8 (.625)	433.42	305.12	197.03
1904D	3/4 (.750)	639.18	449.98	290.56
1904G	7/8 (.875)	488.20	343.69	221.93
1904E	1 (1.000)	643.09	452.74	292.34

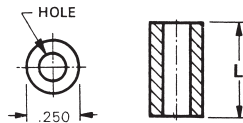
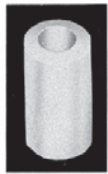

ROUND THRU-HOLE NYLON SPACERS

Economical for terminal or printed circuit board supports. **MATERIAL:** Nylon 6/6.

Cat. No.	"L" Length (Inches)	Net Price Per 1000		
		1-499	500-999	1000-Up
#4 SCREW, .120 HOLE				
875	1/8 (.125)	\$107.00	\$75.33	\$48.64
876	1/4 (.250)	116.18	81.79	52.81
877	3/8 (.375)	122.83	86.47	55.84
878	1/2 (.500)	130.26	91.71	59.21
879	5/8 (.625)	140.42	98.86	63.83
880	3/4 (.750)	142.78	100.51	64.91
881	7/8 (.875)	145.90	102.71	66.32
882	1 (1.000)	154.13	108.50	70.06
#6 SCREW, .140 HOLE				
883	1/8 (.125)	107.00	75.33	48.64
884	1/4 (.250)	116.18	81.79	52.81
885	3/8 (.375)	122.83	86.47	55.84
886	1/2 (.500)	130.26	91.71	59.21
887	5/8 (.625)	140.42	98.86	63.83
888	3/4 (.750)	142.78	100.51	64.91
889	7/8 (.875)	145.90	102.71	66.32
890	1 (1.000)	154.13	108.50	70.06
#8 SCREW, .171 HOLE				
891	1/8 (.125)	107.00	75.33	48.64
892	1/4 (.250)	116.18	81.79	52.81
893	3/8 (.375)	122.83	86.47	55.84
894	1/2 (.500)	130.26	91.71	59.21
895	5/8 (.625)	140.42	98.86	63.83
896	3/4 (.750)	142.78	100.51	64.91
897	7/8 (.875)	145.90	102.71	66.32
898	1 (1.000)	154.13	108.50	70.06

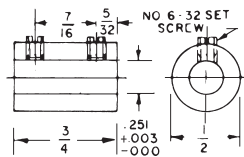

1/4" - 1/4" SHAFT COUPLING

Material: Brass, Nickel Plated (QQ-N-290). Two set screws hold shaft securely. Supplied unassembled.

Cat. No.	Net Price
1453	\$2.51

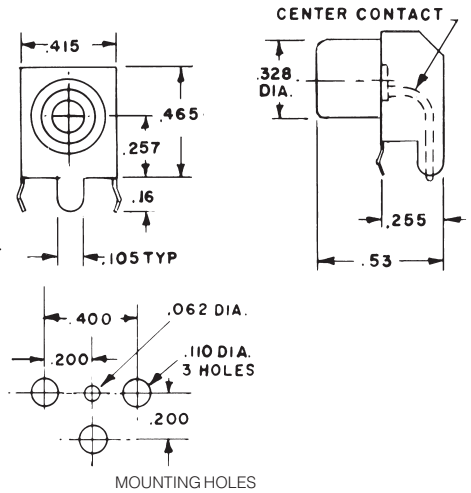
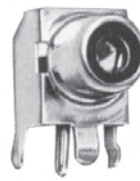

SNAP-FIT 90° PC PHONE JACK

Complete one piece jack for insertion into PC board. Time saving. No wiring required. **MATERIAL:** Shell: Steel. Contact: Brass.

Cat. No.	Description	Net Price Per 1000
901	Tin Plate	\$1163.35
900	Gold Plate	1401.17

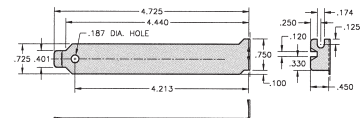
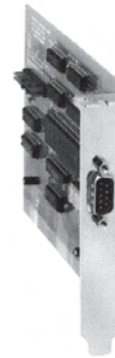

9200

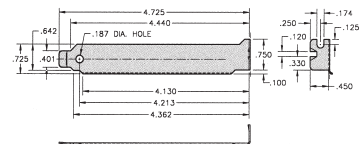

9201

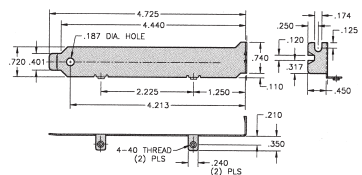

9202

Continued on next page....

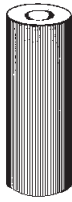

HH SMITH NICKEL PLATED BRASS SPACERS

ALL 1/4" O.D.

Cat. No.	Length	Clearance Hole
ROUND CLEARANCE		
2105	.250	#8
2340	.250	#4
2107	.500	#8
2108	.750	#8
2109	1.000	#8
ROUND THREADED		
2374	1.000	4-40

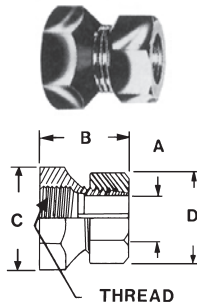

HH SMITH BRASS, NICKEL-PLATED SHAFT LOCK

Cat. No.	For Shaft Size	Dimensions				Thread Size
		A	B	C	D	
181	1/4"	.253"	1/2"	1/2"	7/16"	3/8-32

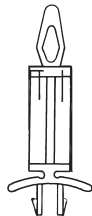

PRINTED CIRCUIT BOARD SUPPORTS

Made of flame retardant nylon. Snaps into circuit board and chassis. Fits in chassis hole .187 diameter. Fits in PC board hole .156.

Cat. No.	Length
4295	3/8"

NOTE: PLEASE CONTACT YOUR ELECTRO SONIC SALES REPRESENTATIVE FOR PRICING AND AVAILABILITY

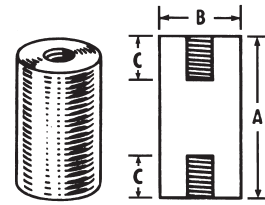

HH SMITH CERAMIC STANDOFFS OUTSIDE GLAZED

Cat. No.	Dimensions		
	A	B	C
2642	3/8"	3/8"	5/32"
2644	1/2"	1/2"	9/64"
2645	3/4"	1/2"	1/4"
2646	1"	1/2"	3/8"
2647	1-1/2"	1/2"	9/16"

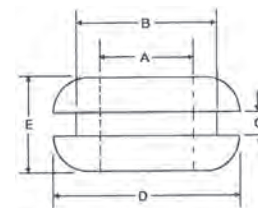

RUBBER GROMMETS

MATERIALS: Black Buna-S synthetic rubber (SBR), approximately 60 durometer.

Cat. No.	Dimensions (Inches)				
	A	B	C	D	E
2187	5/8	7/8	1/16	1-1/8	5/16

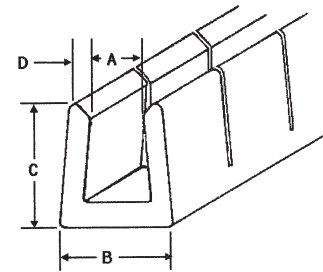

CATERPILLAR GROMMETS

MATERIALS: Black nylon, type 6/6. **APPLICATIONS:** "U" shaped nylon extrusion, with slits along length to make grommets fit and size (Minimum 1" dia.) or shape hole, in chassis from 1/32 to 1/8" thick.

Cat. No.	Chassis Thickness (Inches)	Dimensions (Inches)			
		A	B	C	D
2692	.032-.052	.052	.125	.190	.040
2693	.052-.085	.170	.205	.205	.045
2694	.084-.125	.125	.210	.220	.045

**MOVING? CHANGING JOBS?
PLEASE LET US KNOW TO KEEP OUR RECORDS
UP TO DATE AND KEEP YOU INFORMED.**