

ELECTRICAL

Cat. No.	Resonant Frequency (KHz)	Res. Resist. (Ohm max.)	Electro. Capacit. (nF) ($\pm 30\%$)	Shape	Net Price
AB1548B	4.8 \pm 0.5	2000	7.5	A	\$1.03
AB2020A	2.0 \pm 0.5	300	90	A	.64
AB2036AF	3.7 \pm 0.5	500	20	B	1.03
AB2038BF	3.8 \pm 0.5	350	17	B	.95
AB2040B	4.0 \pm 0.5	350	25	A	.24
AB2065B	6.5 \pm 1.0	300	14	A	.24
AB2720B	2.0 \pm 0.5	300	45	A	1.46
AB2720BF	2.0 \pm 0.5	500	35	B	1.86
AB2728B	2.8 \pm 0.5	300	30	A	1.30
AB2734B	3.4 \pm 0.5	1000	13	A	1.17
AB2737BF	3.7 \pm 0.5	400	20	B	1.22
AB2745BF	4.5 \pm 0.5	500	16	B	.90
AB2746B	4.6 \pm 0.5	250	16	A	.78
AB3526B	2.6 \pm 0.5	300	30	A	1.46
AB3529BF	2.9 \pm 0.5	500	25	B	1.51
AB4406B	0.6 \pm 0.3	1000	70	A	2.04

NOTE: All data at 25°C unless otherwise specified.

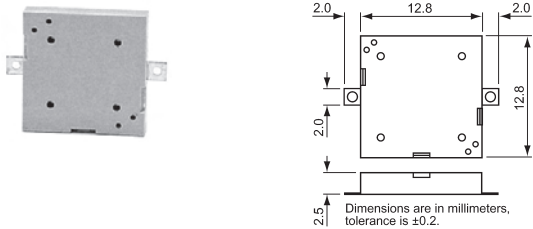

SERIES SMT-1325 PIEZO CERAMIC AUDIO TRANSDUCERS

FEATURES: Surface mounting. Compatible with convection, IR, and vapour phase. 4100 Hz resonant frequency. 2.5mm low profile miniature case configuration.

ELECTRICAL

Parameter	SMT-1325	Units
Operating Voltage (max.)	25	Vp-p
Rated Voltage	5	Vp-p
Rated Current (max.)	3	mA
Resonant Frequency	4100	Hz
Sound Press. Level @ 10cm (min.)	76	dBA
Capacitance @ 1KHz	16 \pm 30%	nF
Temp. Range: Operating/Storage	-20° to +70° / -30° to +80°	°C

NOTE: All data at 25°C unless otherwise specified.

Cat. No.	Net Price
SMT-1325	\$2.47

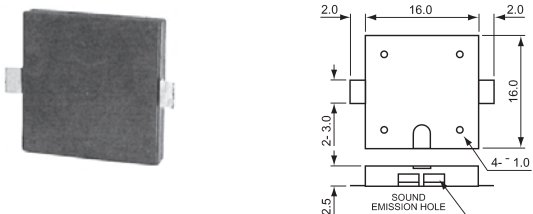

SERIES SMT-1625 PIEZO CERAMIC AUDIO TRANSDUCERS

FEATURES: Surface mounting. Compatible with convection, IR, and vapour phase. 4000 Hz resonant frequency. 2.5mm low profile miniature case configuration.

ELECTRICAL

Parameter	SMT-1625	Units
Operating Voltage (max.)	25	Vp-p
Rated Voltage	5	Vp-p
Rated Current (max.)	3	mA
Resonant Frequency	4000	Hz
Sound Press. Level @ 10cm (min.)	70	dBA
Capacitance @ 1KHz	14 \pm 30%	nF
Temp. Range: Operating/Storage	-20° to +70° / -30° to +80°	°C

NOTE: All data at 25°C unless otherwise specified.

Cat. No.	Net Price
SMT-1625	\$2.17

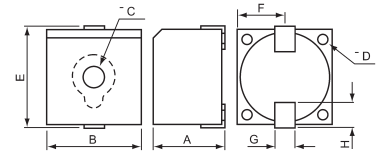

SERIES SMT-2114A AND SMT-2118 PIEZO CERAMIC SMD TRANSDUCERS

FEATURES: SMD mounting. Compatible with convection, IR, and vapour phase. Sealed for washing. 4300 Hz and 3000 Hz frequencies. Two voltages available: 1-20 and 1-30 Vp-p. Available in tubes of 35 pieces (SMT-2114A) and 25 pieces (SMT-2118). SPECIFICATIONS: Case: ABS, black. Weight: 0.11 oz. (3.2 grams). P.C. Pins: tin-plated brass.

ELECTRICAL

Parameter	SMT-2114A	SMT-2118	Units
Rated Voltage	5	5	Vp-p
Operating Voltage	3-20	3-30	Vp-p
Rated Current (max.)	8	7	mA
Resonant Frequency	3300	3700	Hz
Sound Pressure Level @ 10cm (typ.)	90	90	dBA
Temp. Range: Operating/Storage	-20° to +70° -30° to +80°		°C

NOTE: All data at 25°C unless otherwise specified.

Cat. No.	Dimensions								Net Price
	A	B	C	D	E	F	G	H	
SMT-2114A	10.7	14.2	3.0	1.5	14.8	7.1	3.0	4.2	\$3.79
SMT-2118	11.9	17.9	2.7	1.5	18.4	9.0	3.0	4.2	\$3.84

NOTE: Dimensions are in millimeters, tolerance is ± 0.3 .

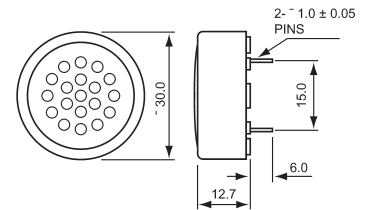

SERIES AT-41 SPEAKER AUDIO TRANSDUCERS

The AT-41 was designed to satisfy the need for a small, P.C. board-mountable speaker transducer for use in keyboards. It has a low profile and a sound output suitable for an office-type environment. Additional impedance and frequency outputs are available. Contact Electro Sonic for details. FEATURES: P.C. board mounting. 8 Ohms impedance—32 and 100 Ohms available. 1400 Hz frequency—800 and 1400 available. SPECIFICATIONS: Case: ABS, black. Weight: 0.35 oz. (10 grams). P.C. Pins: tin-plated copper.

ELECTRICAL

Parameter	AT-41	Units
Power Input (nom.)	0.15	Watt
Power Input (max.)	0.20	Watt
Impedance	8	Ohm
Operating Temperature Range	-40° to +70°	°C

NOTE: All data at 25°C unless otherwise specified.

Cat. No.	Net Price
AT-41	\$1.80

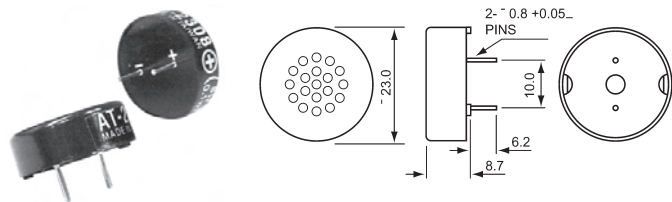

SERIES AT-2308 SPEAKER AUDIO TRANSDUCERS

The AT-2308 has been designed for a wide variety of applications where small size is important. Its low profile and broad frequency range make it an ideal choice for keyboard, hand-held devices, and other miniaturized systems. **FEATURES:** P.C. board mounting, Mylar cone, 8 Ohm standard impedance. Wave solderable. Low Profile. **SPECIFICATIONS:** Case: ABS, black. Weight: 0.11 oz. (3.2 grams.).

ELECTRICAL

Parameter	AT-2308	Units
Rated Input	.08	Watt
Maximum Input	0.15	Watt
Frequency Range	600-2000	Hz
Resonant Frequency	1500	Hz
Impedance	8±20%	Ohm
Operating Temperature Range	-20° to +60°	°C

NOTE: All data at 25°C unless otherwise specified.

Cat. No.	Net Price
AT-2308	\$5.03



PAPER CONE/MYLAR CONE
BOTH UNITS HAVE METAL CASE

SERIES AT-38008 THIN DYNAMIC SPEAKERS

FEATURES: Variety of sizes and impedances. Low profile. Paper or mylar cone. Light weight.

ELECTRICAL

Parameter	AT-38008	AT-40008	AT-45008	AT-50008	AT-57008	Units
	AT-38008M	AT-40008M	AT-45008M	AT-50008M	AT-57008M	
Rated Input	0.1	0.1	0.1	0.2	0.25	Watt
Frequency Range			F ₀ -4000			Hz
Lowest Resonant Freq. (F ₀)	700±50	700±50	500±80	450±80	400±60	Hz
Impedance	8±15% @ 1KHz					Ohm
Temp. Range:						°C
● Operating	-20° to +60°					
● Storage	-30° to +70°					°C

NOTE: All data at 25°C unless otherwise specified.

Cat. No.	Dimensions					Net Price
	A	B	C	D	E	
AT-38008M	38.0	34.0	8.0	5.0	2.0	\$8.62
AT-40008M	40.0	36.0	8.0	5.5	2.0	8.30
AT-45008M	45.0	40.0	8.3	5.8	2.5	8.62
AT-50008M	50.0	45.0	9.0	6.5	2.5	8.00
AT-57008M	57.0	52.0	9.6	7.3	2.5	8.62
AT-38008	38.0	34.0	8.0	5.0	2.0	8.35
AT-40008	40.0	36.0	8.0	5.5	2.0	8.35
AT-45008	45.0	40.0	8.3	5.8	2.5	6.39
AT-50008	50.0	45.0	9.0	6.5	2.5	5.96
AT-57008	57.0	52.0	9.6	7.3	2.5	8.00

NOTE: Dimensions are in millimeters, tolerance is ±0.3.

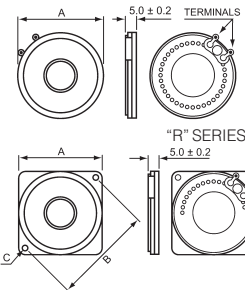

"S" SERIES

SERIES FS-30, FS-40, AND FS-50 SUPER THIN FLAT SPEAKERS

FEATURES: Super thin profile. Stainless steel diaphragm. Broad frequency range. Excellent temperature and humidity characteristics. **NOTES:** Square speakers can be mounted by conventional methods, taking care not to distort the speaker frame. If resonance occurs, the unit should be mounted on rubber or similar material. Round speakers can be mounted by using double-faced tape or an adhesive. Care should be taken not to deform the diaphragm when handling as this can effect performance.

ELECTRICAL

Parameter	All Models, except as noted
Rated Input, Watt	0.4
Max. Input, Watt	0.8
Impedance Ohm @ 1 KHz	8*
Sound Pressure Level @ 10cm, dB	70
Frequency Response, KHz	FS-30: 13-10,000 FS-40: 12-6000 FS-50: 9-4000
Distortion, KHz	FS-30: 10% max./4 FS-40: 10% max./3 FS-50: 10% max./2
Temperature Range:	
● Operating	-20° to +55°
● Storage	-40° to +80°
Humidity @ 40°C	90% RH

NOTE: All data at 25°C unless otherwise specified.







Cat. No.	Dimensions (mm)			Weight	Net Price
	A	B	C		
FS-30R	30 (tol. +0.3,-0)			7 grams	\$2.46
FS-40R	40 (tol. +0.4,-0)			9 grams	2.46
FS-50R	50 (tol. +0.5,-0)			12 grams	2.77
FS-30S	30 (tol. +0.3,-0)	36 (tol. +0,-0.3)	2.5	7 grams	2.46
FS-40S	40 (tol. +0.4,-0)	47 (tol. +0,-0.3)	3.0	10 grams	2.60
FS-50S	50 (tol. +0.5,-0)	59 (tol. +0,-0.3)	3.5	13 grams	2.51



Part's indicated with a leaf  are considered RoHS July 2006 compliant based on the manufacturer's confirmation at the time of publishing. For additional information please contact Electro Sonic.

Electrolytic Tough Pitch (ETP) HIGH CONDUCTIVITY Copper Speaker Cables

SPEAKER CABLES—TWO CONDUCTOR PVC INSULATED, HIGH CONDUCTIVITY COPPER



Description UL AWM Style	Cat. No. UL NEC C(UL) CEC Type	Standard Lengths		Std. Unit Lbs. ea.	Insulation Thickness		Nominal O.D.		
		ft.	m		Inch	mm	Inch	mm	
24 GAUGE STRANDED CONDUCTORS (7 × 32)									
 60°C Clear 75°C Chrome, Brown, White	8782	U-1000	U-304.8	6.5	.017	.43	.058	1.47	
		1000	304.8	6.2			× .115	× 2.92	
Product Description: Copper, PVC insulated, Parallel. 1 conductor bare, 1 conductor tinned. Suggested working voltage: 300V. Stock colours: Brown, White, Chrome, Clear.									
22 GAUGE STRANDED CONDUCTORS (7 × 30)									
 60°C	9712	U-500	U-152.4	4.8	.017	.43	.065	1.65	
		U-1000 1000	U-304.8 304.8	8.6 8.1			× .130	× 3.30	
Product Description: Copper, PVC insulated, Parallel. 1 conductor bare, 1 conductor tinned. Suggested working voltage: 300V. Stock colour: Clear.									
20 GAUGE STRANDED CONDUCTORS (7 × 28)									
 60°C Clear 75°C Chrome	8649	U-500	U-152.4	6.0	.018	.46	.073	1.85	
		500 U-1000 1000	152.4 U-304.8 304.8	5.7 11.3 11.0			× .146	× 3.71	
Product Description: Copper, PVC insulated, Parallel. 1 conductor bare, 1 conductor tinned. Suggested working voltage: 300V. Passes VW-1 Vertical Wire Flame Test. Stock colours: Chrome, Clear.									
18 GAUGE STRANDED CONDUCTORS (16 × 30)									
 60°C	9708	50	15.2	.9	.032	.81	.110	2.79	
		100 U-500 500 U-1000 1000	30.4 U-152.4 152.4 U-304.8 304.8	2.2 9.9 9.6 18.8 19.3			× .207	× 5.26	
Product Description: Copper, PVC insulated, Parallel. 1 conductor bare, 1 conductor tinned. Suggested working voltage: 300V. Stock colour: Clear.									
16 GAUGE STRANDED CONDUCTORS (26 × 30)									
 60°C	9716	U-500	U-152.4	13.3	.027	.69	.115	2.92	
		500 U-1000 1000	152.4 U-304.8 304.8	12.9 25.6 26.3			× .230	× 5.84	
Product Description: Copper, PVC insulated, Parallel. 1 conductor tinned, 1 conductor bare. Suggested working voltage: 300V. Stock colour: Clear.									
14 GAUGE STRANDED CONDUCTORS (19 × 27)									
 60°C	9717	100	30.4	4.1	.035	.89	.146	3.71	
		U-500 500 U-1000 1000	U-152.4 152.4 U-304.8 304.8	19.1 18.9 37.2 38.0			× .292	× 7.42	
Product Description: Copper, PVC insulated, Parallel. 1 conductor bare, 1 conductor tinned. Stock colour: Clear.									
12 GAUGE STRANDED CONDUCTORS (65 × 30)									
 60°C	9718	50	15.2	3.5	.045	1.14	.185	4.70	
		100 500 1000	30.4 152.4 304.8	6.8 32.4 63.2			× .370	× 9.40	
Product Description: Copper, PVC insulated, Parallel. 1 conductor bare, 1 conductor tinned. Stock colour: Clear.									

SPEAKER CABLES—TWISTED JACKETED CONSTRUCTIONS

Description UL AWM Style	Cat. No. UL NEC C(UL) CEC Type	Standard Lengths		Std. Unit Lbs. ea.	Insulation Thickness		Jacket Thickness		Nominal O.D.	
		ft.	m		Inch	mm	Inch	mm	Inch	mm
22 GAUGE STRANDED CONDUCTORS (7 × 30)										
	8442 NEC CMG CEC CMG	100	30.5	1.8	.015	.38	.025	.64	.170	4.32
		U-500 500 U-1000 1000	U-152.4 152.4 U-304.8 304.8	7.9 7.4 14.7 15.4	Product Description: Tinned copper, PVC insulated, twisted pair. Chrome PVC jacket. Colour code: Black, Red.					



Continued on next page...

For complete product selection please contact your Electro Sonic sales representative.

Description UL AWM Style	Cat. No. UL NEC C(UL) CEC Type	Standard Lengths		Std. Unit Lbs. ea.	Insulation Thickness		Jacket Thickness		Nominal O.D.	
		ft.	m		Inch	mm	Inch	mm	Inch	mm
20 GAUGE STRANDED CONDUCTORS (7 x 28)										
	8205	100	30.5	2.1	.013	.33	.025	.64	.180	4.57
	NEC CMG	U-500	U-152.4	9.5	Product Description: Tinned copper, PVC insulated, twisted pair. Chrome PVC jacket. Colour code: Black, Red.					
	CEC CMG	500	152.4	9.3						
	1000	U-304.8	18.0							
1000	304.8	19.0								
18 GAUGE STRANDED CONDUCTORS (7 x 28)										
	8461	100	30.5	3.3	.022	.56	.028	.71	.234	5.94
	NEC CMG	U-500	U-152.4	14.0	Product Description: Tinned copper, PVC insulated, twisted pair. Chrome PVC jacket. Colour code: Black, White.					
	CEC CMG	500	152.4	14.1						
	1000	U-304.8	27.2							
1000	304.8	28.0								
16 GAUGE STRANDED CONDUCTORS (19 x 29)										
 2598 300V 60°C	8471	U-500	U-152.4	18.9	.023	.58	.032	.81	.274	6.96
	NEC CMG	500	152.4	19.7	Product Description: Tinned copper, PVC insulated, twisted pair. Chrome PVC jacket. Colour code: Black, White.					
	CEC CMG	U-1000	U-304.8	37.0						
	1000	304.8	37.9							

USE FIT®-221 ALPHA HEAT SHRINK TUBING

SPEAKER CABLES—TWO CONDUCTOR PVC INSULATED, HIGH CONDUCTIVITY COPPER

Description UL AWM Style	Cat. No. UL NEC C(UL) CEC Type	No. of Cond.	Standard Lengths		Std. Unit Lbs. ea.	Insulation Thickness		Jacket Thickness		Nominal O.D.	
			ft.	m		Inch	mm	Inch	mm	Inch	mm
14 GAUGE STRANDED CONDUCTORS (42 x 30)											
 2587 600V 90°C	8473	2	U-500	U-152.4	29.2	.031	.79	.032	.81	.340	8.64
	NEC CL3		500	152.4	28.2	Product Description: Tinned copper, PVC insulated, twisted pair. Chrome PVC jacket. 600V Rating per AWM 2587. See NEC Guidelines for applicable CL3 voltage ratings. Colour code: Black, White.					
	CSA		1000	304.8	59.8						
	FAS90 FT 4										
12 GAUGE STRANDED CONDUCTORS (65 x 30)											
 2587 600V 90°C	8477	2	U-500	U-152.4	39.8	.031	.79	.035	.89	.386	9.80
	NEC CL3R		500	152.4	41.0	Product Description: Tinned copper, PVC insulated, twisted pair. Chrome PVC jacket. 600V Rating per AWM 2587. See NEC Guidelines for applicable CL3 voltage ratings. Colour code: Black, White.					
			1000	304.8	82.3						

Standard Analog Video Coax

75 OHM VIDEO CABLES

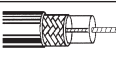
Description UL AWM Style	Cat. No. UL NEC C(UL) CEC Type	Standard Lengths		Std. Unit Lbs. ea.	AWG (stranding) [Dia. in In.] Nom. D.C.R.	Insulation & Nominal Core O.D.		Nominal O.D.		No. of Shields & Material Nom. D.C.R.	Nom. Imp. (ohms)	Nom. Vel. of Prop.	Nominal Capacitance		Nominal Attenuation		
		ft.	m			Inch	mm	Inch	mm				pF/ft.	pF/m	MHz	dB/ 100 ft.	dB/ 100 m
MINIATURE COAX																	
 1354 30V 60°C	8218	100	30.5	1.6	27(7 x 35)	Poly-ethylene .100 2.54	.150	3.81	Tinned copper braid 93% shield coverage 5.7Ω/M 18.7Ω/km	75	66%	20.5	67.3	Black PVC jacket.	1	1.2	3.9
	U-500	U-152.4	7.3	.017 bare	10										2.4	7.9	
	500	152.4	7.0	copper	50										4.2	13.8	
	U-1000	U-304.8	15.4	covered	100										5.7	18.7	
	1000	304.8	15.5	steel	200										8.3	27.2	
				120.0Ω/M 393.7Ω/km	400										12.1	39.7	
				700	16.5	54.1											
				900	19.0	62.3											
				1000	20.0	65.6											

Continued on next page...

For complete product selection please contact your Electro Sonic sales representative.



MODE UNIVERSAL SWITCHING ADAPTER REGULATED OUTPUT

This multi-output switching power supply can be used for the output voltages listed below with loads from 0-1.7 amps. The unit comes with an assortment of changeable plugs suitable for most requirements. The plugs can be easily changed to centre positive or negative. The output voltage is selected by a switch on the back of the adapter.

Cat. No.	Output Voltages	Current Rating	Net Price
68-519-1	3, 4.5, 6, 7.5, 9, and 12VDC	1.7A	\$20.83

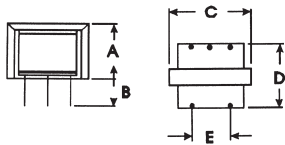
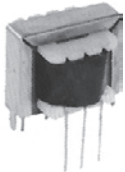

AUDIO TRANSFORMERS

Cat. No.	Type	Impedance		Dimensions					Net Price
		Primary	Secondary	A	B	C	D	E	
60-281-0	Output	500Ω c.t.	8Ω	16	12	20	15	8	\$1.92
60-282-0	Output	1.2KΩ c.t.	8Ω	16	12	20	15	8	1.92



L-PADS

8Ω 15 watt balanced impedance audio level control.

Cat. No.	Type	Net Price
61-111-0	Mono	\$4.75
61-112-0	Stereo	8.33

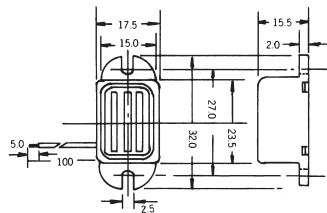
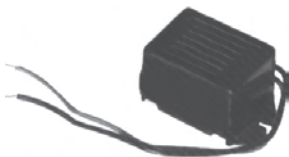

UNIT: MM

MINIATURE BUZZERS W/100MM WIRE LEADS

Input voltage: see chart
Rated current: 35mA
Sound output: 85db @ 20cm
Frequency: 2KHz

Cat. No.	Type	Net Price
61-211-0	4-8 VDC	\$1.58
61-212-0	8-16 VDC	1.25

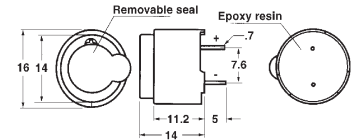

Current: 30mA
Output: 85db@10cm
Frequency: 2KHz
Complete with driver circuit

Cat. No.	Description	Net Price
61-223-0	4-7 Volts	\$1.50
61-224-0	8-15 Volts	1.50

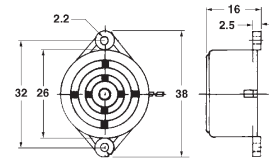

SPECIFICATIONS:

Current: 40mA
Output: 90db@30cm
Frequency: 2.8KHz
Panel mount buzzer with 100mm leads.

Cat. No.	Description	Net Price
61-231-0	4-8 Volts	\$2.00
61-233-0	20-28 Volts	2.08

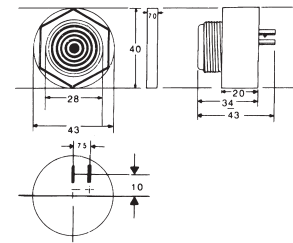

UNIT: MM

PANEL MOUNT AUDIO ALARMS

Input voltage: 4-28 VDC
Rated current: 15mA
Sound output: 80db @ 100cm
Frequency: 3.2KHz

Cat. No.	Type	Net Price
61-301-0	Continuous Tone	\$3.75
61-302-0	Pulsed Tone	3.75
61-303-0	Continuous and Pulsed Tone	4.17

NOTE: 61-303-0 input voltage: 16VDC maximum.

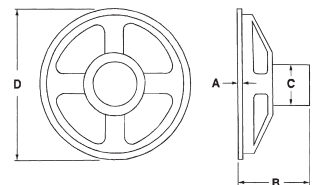

8 OHM MINIATURE SPEAKERS

Frequency range: 300Hz - 4KHz.

Cat. No.	Power	Size (D)	A	B	C	Net Price
61-640-0	100mW	40mm	2.5	16.7	17.9	\$1.50

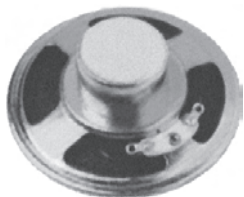

8Ω MINIATURE SPEAKERS W/ ALNICO MAGNETS

Cat. No.	Size	Power	Frequency	Type	Net Price
61-650-0	50mm (2")	200mW	300Hz-4KHz	Round	\$1.67



OUTDOOR HORNS

SPECIFICATIONS:

Impedance:	8Ω
Power rating:	15 watts
Frequency response:	360Hz-7.5KHz
Size:	5" x 8" Horn
Cord:	6" wire leads
Mounting:	Detachable bracket

Cat. No.	Net Price
70-703-1	\$28.33

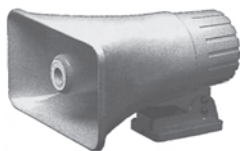

8 ohm @ 20 watts 360Hz - 7.5KHz 4.5" x 8" opening, 9 1/4" length, 12" wire leads. White ABS plastic.

Cat. No.	Net Price
70-704-1	\$30.83



OUTDOOR HORNS

SPECIFICATIONS:

Impedance:	8Ω
Power rating:	10 watts
Frequency response:	500Hz-7.8KHz
Size:	5" ø Horn
Cord:	6" wire leads
Mounting:	Swivel bracket

Cat. No.	Net Price
70-706-1	\$12.92



8 ohm @ 10 watts 500Hz - 7.8KHz 5" diameter opening 6" wire leads. White ABS plastic.

Cat. No.	Net Price
70-707-1	\$10.83



DESOLDERING TOOL

This pump type desoldering tool features Aluminum barrel, enclosed plunger, teflon tip and automatic cleaning. Replacement teflon tip available (84-111-0).

Cat. No.	Description	Net Price
84-110-1	Desoldering Tool	\$5.42
84-111-0	Replacement Tip	1.45



'HELPING HANDS'

Convenient holder with heavy cast base and adjustable arms with clips suitable for holding connectors and printed circuit boards for soldering.

Cat. No.	Net Price
84-122-1	\$6.67



CONNECTOR TOOL

Small size, inexpensive, easy to use tool for "snap-n-seal" type connectors.

Cat. No.	Net Price
84-157-1	\$23.33

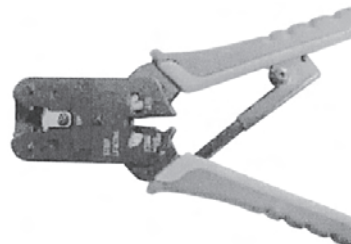

MODULAR CRIMP TOOL

FEATURES: 8P/8C (RJ45) precision crimper. Cuts and strips both flat and round modular cable. Extremely comfortable cushioned handles. Ratchet action with easy release.

Cat. No.	Net Price
12-309	\$34.58



HEAVY DUTY CRIMP TOOL

Heavy duty hexagonal crimp tool for F59 connectors. Suitable for RG59/U and RG62/U coaxial cable. Hex crimp sizes are .255" and .322" across flats. Comfortable cushion grip handles.

Cat. No.	Net Price
84-159-1	\$20.83

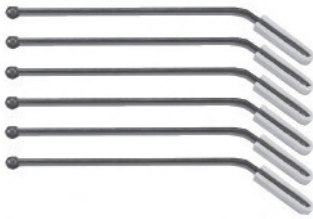

CHAMOIS CLEANING WANDS

These top quality wands are tipped with soft absorbent chamois and angled slightly to fit easily into hard-to-reach places. Reusable. Contents: 6 swabs to a package.

Cat. No.	Net Price
32-3088-0000	\$9.11



G-C MAG-NETIK RECORDING HEAD CLEANER

"Removes Oxide from Tape Recording Heads". Cleans without injury to the recording head that gradually loses its sensitivity if oxide accumulates. Clean and preserve at regular intervals.

Cat. No.	Description	Net Price
19-5302-0000	2 oz. bottle	\$9.79
19-5304-0000	4 oz. aerosol	4.07



REMOTE CONTROL A/B SWITCH

The infrared remote control video switch allows you to switch between two 75 ohm inputs (cable, antenna, satellite, or dual cable systems) and a 75 ohm output (probably a TV) without leaving the comfort of your chair. Complies with FCC part 15.6 and is recommended when switching between cable TV and antenna systems inputs. Isolation 80 dB. AC adapter. **SPECIFICATIONS:** Frequency range: 5-2050 MHz.

Cat. No.	Net Price
32-3221-0000	\$50.08



PILLOW SPEAKER

Enjoy listening to TV or radio without disturbing others. 8 ft. cord with 3.5mm miniature phone plug fits most transistor radios, tape recorders and many TV's. Dynamic type. 8 ohm impedance.

Cat. No.	Net Price
30-0160-0000	\$5.05



32-1830-0000



32-1827-0000
32-1820-0000
32-1813-0000

TELEVISION WALL MOUNTS

Space-saving television/monitor mounts are ideal for today's home or office. As space becomes more valuable in every room, GC mounts provide a modern alternative to bulky TV stands and home entertainment centres. The 10° shelf tilt angle and the 90° left/right swivel lets you position the television for optimum viewing from any point in the room. High-tech black or white, scratch resistant finish. All mounts include hardware for wood installation.

25"/27" TELEVISION MOUNT

TRAY WIDTH: 25". MAX. DEPTH of SET: 19½". LOAD RATING: 125 lbs. FITS: Most 25" and 27" sets.

Cat. No.	Description	Net Price
32-1827-0000	Black	\$96.33
32-1827-00CM	Ceiling Mount	96.33

19"/20" TELEVISION MOUNT

TRAY WIDTH: 20". MAX. DEPTH of SET: 18". LOAD RATING: 100 lbs. FITS: Most 19" and 20" sets.

Cat. No.	Description	Net Price
32-1816-0000	Black	\$70.21

13" TELEVISION MOUNT

TRAY WIDTH: 14". MAX. DEPTH of SET: 15½". LOAD RATING: 100 lbs. FITS: Most 13" sets.

Cat. No.	Description	Net Price
32-1815-0000	Black	\$64.64
32-1813-00WH	White	62.38

SATELLITE RECEIVER/VCR BRACKET

Attaches to wall or ceiling mount. Adjustable height and width. 2½" to 4½" high. 12½" to 17¼" wide.

Cat. No.	Description	Net Price
32-1830-0000	Black	\$37.51
32-1830-00WH	White	37.51

CEILING/WALL ANCHOR KIT WITH 4 BOLTS

For concrete walls.

Cat. No.	Net Price
32-1820-00AK	\$15.41



COMMERCIAL
S O U N D
S Y S T E M S



MODEL PA430 & PA430T

The PA430 30 watt paging projector is designed especially to exhibit a dispersion pattern that is constant over a 2KHz to 10 KHz frequency range, the critical range for good speech articulation. The PA430T has an input transformer to match 25V, 70.7 or 100V lines, with screw driver adjustable power taps, built into the rear housing. Frequency: 400Hz-6.5KHz. Impedance: 8 ohms. Beamwidth: 60°H and 40°V. Size: (H x W x D) 8.9" x 12.1" x 12.2" (22.6 x 30.7 x 12.2cm). Weight: 3 lbs (PA430) 4 lbs (PA430T).

Cat. No.	Net Price
PA430	\$108.43
PA430T	138.55



ID30CT

DRIVERS

Are high compression drivers designed for heavy duty, medium power public address installations where clear, penetrating coverage and maximum sound pressure levels are of prime concern.

Cat. No.	Frequency Response	Power Handling Capacity (RMS)	Voice Coil Impedance*	Dimensions	Net Price
ID30C8	50-4 KHz.	30 watts	8 ohms 1" throat	4 ³ / ₁₆ " Dia. x 5 ³ / ₁₆ " D.	\$126.50
ID30C16	50-4 KHz.	30 watts	16 ohms 1" throat	4 ³ / ₁₆ " Dia. x 5 ³ / ₁₆ " D.	126.50
ID30CT	50-4 KHz.	30 watts	70V or 25V line with taps	4 ³ / ₁₆ " Dia. x 5 ³ / ₁₆ " D.	100.68

*Check impedance of older drivers (usually 16 ohms) when replacing.

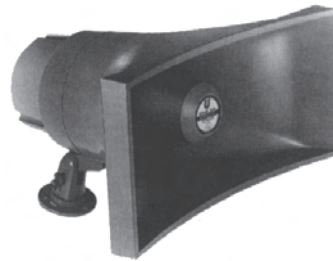

CFID32T



MIS8C

PAGING AND TALKBACK SPEAKERS

Cat. No.	Frequency Response	Power Rating RMS	Impedance	Dispersion	Sound Pressure Level (3)	Dimensions	Net Price
CFID32-8 CFID32T	220-14,500 Hz.	32 watts	8 ohms variable (1)	120°	123 dB	14 ¹ / ₁₆ " W x 7" H x 12 ³ / ₁₆ " D	\$170.39 216.86
MIS8C	350-13,000 Hz.	10 watts	8 ohms	120°	115 dB	5 ¹ / ₂ " Dia. x 4 ⁷ / ₁₆ " L	108.43

1. Model with built-in 70V and 25V line transformers with six screwdriver-selectable wattage taps.
3. Measurement taken at 4 feet on axis at rated power using pink noise, band limited from 500 to 3000 Hz.



MM-2



MM-2F

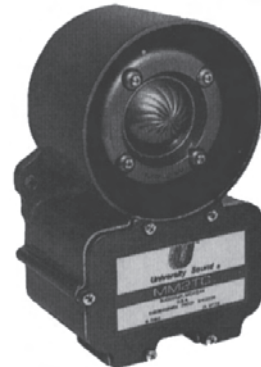

MM2TC

MODELS MM2, 25 WATT SUBMERGENCE PROOF SPEAKER

A 25 watt submergence proof design (U.S. Navy specification) with a serrated mounting bracket allowing for a 90° arc swivel. Ideal for use near water or spray. The grey MM2 features an 82° x 82° dispersion pattern and 16 ohm impedance. Each unit is fully protected against damage from high humidity, salt water and other environmental conditions. Frequency: 800Hz-5kHz, ±5dB. Sensitivity (dB SPL @ 1W, 1m). Dimensions (inches): 6.0 dia. x 5.0 D. Weight: 5.3 lbs (2.4 kg).

Cat. No.	Description	Net Price
MM2	Submergence Proof Speaker	\$409.63
MM2F	Same as MM2 except with a flush mount design for mounting on the front surface of bulkheads, walls or ceilings. Dimensions (inches): 7.3 dia. x 3.8 D. Weight: 6.0 lbs (2.7 kg).	409.63
MM2TC	Same as MM2 except with a surface/bulkhead mount and watertight internal matching transformer compartment. Requires Electro Voice 5030 transformer. Dimensions (inches): 10.0 H x 6.4W x 4.4 D. Weight: 8.8 lbs (4.0kg).	433.73



MS-10C/MS-10CE

Most Popular Floor Stand for budget conscious users. MS-10C includes chrome finished tube and circular cast iron base. MS-10CE is supplied with ebony finished tube and circular cast base. Height: 35"-63". Base: 10" dia. Weight: 10 lbs. MXS-10CE: Height 34"-61".

Cat. No.	Description	Net Price
MS-10C	Chrome	\$36.54
MS-10CE	Ebony	36.54



**INDUSTRY STANDARD OMNI-PURPOSE
TRANSFORMER-EQUIPPED LOUDSPEAKERS**

Patented environment-resistant, double re-entrant loudspeakers are available in 15 watt and 30 watt versions for medium and high-powered sound distribution. Those 25/70.7/100 volt loudspeakers have a screwdriver-adjust power tap selection for a variety of sound and signaling applications. Loudspeakers include the Omni-Purpose® bracket for vertical/horizontal positioning and have provisions for surface/strap mounting to pillars and I-beams. Colours: grey or beige with baked epoxy finish. Impedance: 8 ohms.

Cat. No.	Power Rating	Nominal Frequency	Dimensions WxHxD	Net Price
AP-15T	15 watts	400Hz-14kHz	7-7/8" x 8-3/4" x 9-5/16"	\$99.56
AP-30T	30 watts	300Hz-12kHz	10" x 10" x 10-1/2"	120.93



**PROFESSIONAL CONSTANT-DIRECTIVITY
TRANSFORMER-EQUIPPED LOUDSPEAKER**

Model APX40TN a conservatively rated 40 watt, constant-directivity paging loudspeaker for use in public address or paging applications. Environment-resistant units feature a 60° x 40° (±10 degrees) constant-dispersion pattern across the controlled frequency band of 1.25-10 kHz. APX models are equipped with an internal 25/70.7/100 volt transformer with screw terminal connections made beneath the rear cap. Rear cap will facilitate armoured cable. Loudspeaker mounts to die-cast zinc base. Finish in natural "X"-TRA VALUE FEATURES: The rotating bell pivots in precise 15° increments for exact on-site positioning of projection angles. A triple lock security mounting method saves installation time and provides long-term stability. Power stripe code around the driver assembly provides identification of power rating from a distance. 40 watt model includes 30 watt tap @ 70V. Quality materials. "X"-TRA EASY INSTALLATION: Pre-mount the base to a standard 1-gang, 2-gang, or 4" square E.O. box. If replacing AP Series speakers, simply remove the APX base and mount to the Omni-purpose® bracket. "X"-TRA PREDICTABILITY: Clear messaging and music. Consistent beamwidth control. Fewer speakers to provide quality communications. Impedance: 40 watt Xfmr. Power taps: 25V: .63, 1.25, 2.5, 3.75, 5, 10, 20, 40; 70.7V: 2.5, 10, 20, 30, 40; 100V: 5, 10, 20, 40.

Cat. No.	Power rating	Nominal Frequency*	Dimensions WxHxD	Net Price
APX40TN	40 watts	400-700Hz	14-1/2" x 10-1/4" x 13-1/4"	\$119.71

*±6dB.

electro sonic

Electro Sonic
appreciates your business

1-800-56-SONIC

www.e-sonic.com

info@e-sonic.com



C10, C20, C10MOH, C20MOH

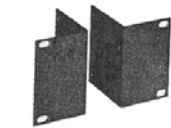

RPK50
RACK PANEL KIT
FOR C35/60/100 MODELS



C35, C60, C100

Model	# of Inputs	MIC precedence over AUX input(s)	Bass/Treble Control	4-, 8-, 16-ohm, 25V, 70V speaker outputs	MOH Outputs Built-in	VOX muting of AUX input (TEL input only)	Variable VOX threshold	Tape/Booster Output
C35/60/100	4 - 1 MIC, 1 AUX, 1 TEL, 1 MIC/AUX	●	●	●		●	●	●
C10/C20	3 - 1 MIC, 1 TEL, 1 MIC/AUX	●	*	●		●	●	
C10MOH/C20MOH	3 - 1 MIC, 1 TEL, 1 MIC/AUX	●	*	●	●	●	●	

* Treble Cut Only

BOGEN PUBLIC ADDRESS AMPLIFIERS CLASSIC SERIES

These public address mixer amplifiers provide mixing of microphones, telephone and auxiliary sources. Output jacks allow a tape recorder or an additional booster amplifier to be connected. Bogen's Classic Series amplifiers offer high-performance, flexibility, and reliability for most applications requiring a variety of inputs. **FEATURES:** 35, 60, and 100 watt models as well as 10 and 20 watt models with optional built-in MOH (music-on-hold) outputs. 4 inputs (C35/60/100 models): 1 MIC (Lo-Z), 1 AUX (Hi-Z), 1 TEL, plus 1 selectable MIC or AUX. 3 inputs (all C10, C20 models): 1 MIC (Lo-Z), 1 TEL, plus 1 selectable MIC or AUX. AUX muting with external contact closure or automatic with TEL. TEL input voice-activated (VOX) mute over AUX input. Variable threshold for voice-activated AUX mute. Separate volume controls for each input plus overall bass and treble (C35/60/100 models) or tone (all C10/20 models). Outputs for 4-ohm, 8-ohm, 16-ohm, 25V and 70V speaker systems. Screw terminal connection for microphones. MOH output: 600-ohm @ 1 V-ohm @ 1 W, and output level control (MOH models only). No paging heard in MOH output (MOH models only). Input Sensitivity: 600 mV, MIC; 85 mV, AUX; 75 mV, TEL. Thermal protection and electronic shutdown. Output jack to connect a tape recorder or booster amplifier (C35/60/100 models only). Easy-to-understand and easy-to-operate controls. Rack-mountable with accessory mounting kit (2 rack spaces). UL and CSA listed.

Cat. No.	Net Price
C20	\$162.00
C10MOH	302.49
C20MOH	367.02
C35	283.56
C60	385.99
C100	493.38
RPK50	44.67

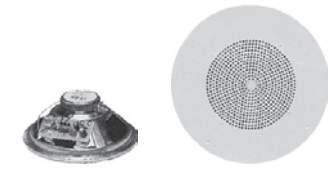

AS1

ASWG1



ASWB1



AH5A
AH15A

BOGEN AMPLIFIED SPEAKERS

Bogen's series of amplified speaker products are an alternative to 70V and 25V speaker systems. Each speaker has a built-in amplifier with volume control. All the speaker requires is 24VDC and a low-level audio signal. **FEATURES:** 8" cone speakers available in ceiling mount, wall baffle mount or unmounted versions. Two horn speaker models: 5W and 15W. Volume control on all speakers. Perfect for small or large paging systems.

Cat. No.	Power Requirements *	Power Rating	Max Sound Level (dBspl) **	Frequency Response	Net Price
UNMOUNTED CONE SPEAKER, 8" DIA x 3-1/4" D					
AS1	24VDC, 50mA	1W	92	100Hz-10kHz	\$46.11
ASWG1	24VDC, 50mA	1W	92	100Hz-10kHz	66.93
WALL BAFFLE WITH AS1, 9-1/2" W x 9-1/2" H x 5-1/4" D					
ASWB1	24VDC, 50mA	1W	92	100Hz-10kHz	68.54
HORN SPEAKERS, 9" DIA x 9-1/4" D					
AH5A	24VDC, 400mA	5W	116	275Hz-14kHz	144.95
AH15A	24VDC, 1A	15W	121	275Hz-14kHz	172.02

*For integrated music and speech input signals. **dBspl @ full power / 4ft.



PRASAC



PRS624DA

BOGEN POWER SUPPLIES

These power supplies are designed to supply the low voltage DC requirements for all of Bogen's products. Corded or outlet mounted, 120VAC primary supply input. Bogen makes it easy for you to install a complete paging system with only a power supply and speakers—it doesn't get any easier. **FEATURES:** Specially designed for use with BOGEN equipment. Wide range of voltages and current outputs. **Loop start paging interface built-in (PRS624DA and PRASAC models only).**

Cat. No.	Output	120VAC Input Style	Dimensions (W x H x D)	Net Price
SCREW TERMINALS				
PRASAC	24V @ 0.45A	Line Cord	2-3/4" x 4-1/2" x 2-1/2"	\$69.32
5-WAY BINDING POSTS				
PRS624DA	24V @ 4A and 24V @ 0.25A	Line Cord	4-3/8" x 6-5/8" x 6-1/4"	294.44



SPT15A, SPT30A
SP158A, SP308A



BDT30A

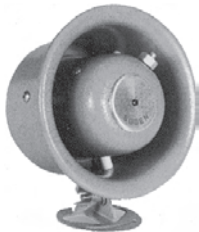

SPT5A
SP58A

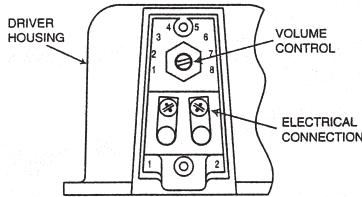

VOLUME CONTROL: SPT5A, SPT15A, SPT30A
AND BDT30A (ONLY)

BOGEN LOUDSPEAKERS

Bogen's horn loudspeakers offer high efficiency, excellent intelligibility. And sturdy, all metal construction. Tilt and swivel base, and rotary switch selected power taps, make installation quick and easy. SPT and BDT models are compatible with 70V and 25V paging systems, SP models are 8-ohm versions. **FEATURES:** Rotary switch-selected power taps on transformer models. Constant voltage (70V/25V) and 8-ohm versions. Tilts and swivel base for easy aiming. All metal construction with enamel finish. Weatherproof design. 12" connecting cable included for installation (SP58A, SPT5A only). Twin re-entrant horns for bi-directional projection (BDT30A only).

Cat. No.	Watts	Frequency Response	Max Sound Level (dBspl)**	Dimensions	Net Price
SCREW TERMINALS					
SPT15A	15	275Hz-14kHz	121	9" Dia. x 9-1/4" D	\$96.41
SP158A*					94.52
SP308A*					126.03
BDT30A	30	225Hz-14kHz	121***	16-1/2" Dia. x 9-3/4" D***	204.00
WIRE TERMINALS					
SPT5A	7.5	250Hz-14kHz	105	6" Dia. x 4" D	83.52

*8-ohm impedance. **dBspl@full power/4ft. ***Each horn.



BOGEN DYNAMIC DESKTOP MICROPHONE

The DDU250 is a high-quality, dynamic, gooseneck desktop microphone ideal for any PA system. The gooseneck permits the user to adjust the microphone's angle and height to suit the user's needs. **FEATURES:** Cardioid pickup pattern. Push-to-lock and push-to-talk switches. Excellent speech intelligibility with low ambient noise. Effective feedback control. 16" long, fully flexible gooseneck stalk shock-mounted to a heavy zinc die-cast base. 10 ft. cable with external contact closure outputs for the talk switches. 500-ohm impedance. Frequency response range of 100 Hz - 12 kHz. Sensitivity of -76 dB +/- 3 dB.

Cat. No.	Net Price
DDU-250	\$189.09



BOGEN INDUSTRIAL GOOSENECK MICROPHONE

The MGN19 is a dynamic, push-button activated microphone designed for all industrial and commercial public address and paging applications. **FEATURES:** Omni-directional pick-up pattern. Rugged, reliable design for quality, long-term use under strenuous handling conditions. 400-ohm impedance. Frequency response range of 50Hz - 12 kHz, w/2kHz boost. Sensitivity of -76dB +/-3dB. Push-to-talk switch on MIC housing. Chrome-plated screen and gooseneck with black Cycolac housing. 9 ft. cable included. 19" flexible neck with mounting flange. Size: 23-1/2" L x 1-1/4" dia. Weight: 1.25 lbs.

Cat. No.	Net Price
MGN19	\$145.55

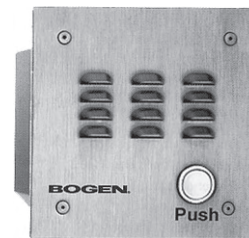

BOGEN HANDS FREE
ANALOG DOOR PHONE

BOGEN ANALOG DOOR PHONE

Bogen's Door Phone provides convenient remote, hands-free two-way communication. Between two locations. Durable, weather-resistant, stainless steel construction protect against vandals and varying weather conditions. **FEATURES:** Suitable for indoor or outdoor station, door, or gate communication. Secure entry access to commercial, industrial or residential locations. Pushbutton initiates the call at remote location. Connect directly to an analog PABX/KSU station programmed for ringdown operation. Adjustable microphone and speaker volume. Adjustable call timeout (15 seconds to 2 minutes). Call limit timer can be disabled. Responds to CPC pulses. Auto-answer features allows monitoring of remote location. Hands-free communication. Power by telephone line; no power supply needed. Brushed stainless steel face plate with mounting gasket and heavy-duty call button. Dimensions: 5" W x 5" H x 2-1/4" D. Weight: 4 lbs.

Cat. No.	Net Price
ADP1	\$385.00

1-800-56-SONIC
www.e-sonic.com