

1005  
1006  
1007  
1008

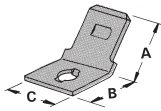

2004  
1271  
1280

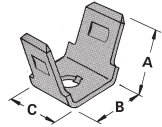

2005  
1263  
1258

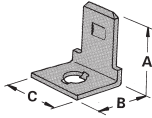

2002  
1261  
1256

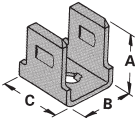

2003  
1262  
1257

## 45° AND 90° QUICK-FIT RIVET TYPE TERMINALS

MATERIAL: Bright Brass

Cat. No.	Tab Size	Material Thick	Dimension			Hole Dia.	Pairs	Net Price Each
			A	B	C			
<b>MULTIPLE 90°</b>								
1005	.250	.032	.703	.375	—	.130	2	<b>\$.43</b>
1006	.250	.032	1.075	.375	—	.130	3	<b>\$.47</b>
1007	.250	.032	1.422	.375	—	.130	4	<b>\$.55</b>
1008	.250	.032	1.837	.375	—	.130	5	<b>\$.77</b>
<b>45°</b>								
2004	.110	.020	.350	.270	.180	.096	—	<b>\$.14</b>
1271	.187	.020	.375	.250	.250	.099	—	<b>\$.18</b>
1280	.250	.032	.405	.312	.312	.130	—	<b>\$.09</b>
2005	.110	.020	.350	.383	.180	.096	—	<b>\$.16</b>
1263	.187	.020	.312	.375	.265	.135	—	<b>\$.14</b>
1258	.250	.032	.405	.343	.312	.130	—	<b>\$.11</b>
<b>90°</b>								
2002	.110	.020	.360	.250	.180	.096	—	<b>\$.14</b>
1261	.187	.020	.375	.250	.250	.099	—	<b>\$.14</b>
1256	.250	.032	.405	.312	.312	.130	—	<b>\$.09</b>
2003	.110	.020	.350	.383	.180	.096	—	<b>\$.16</b>
1262	.187	.020	.312	.250	.250	.099	—	<b>\$.20</b>
1257	.250	.032	.405	.343	.312	.130	—	<b>\$.11</b>

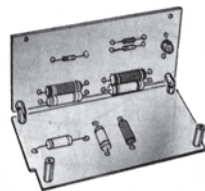
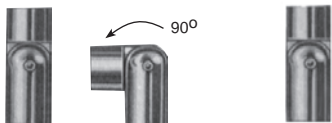

ONLY 2 SCREWS USED TO FASTEN BOARD IN PLACE OR OPEN THE HINGED BOARD.

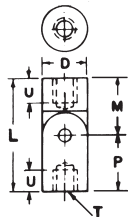

## KEYSTONE FEMALE/FEMALE HINGED STANDOFFS FOR TERMINAL BOARDS

## HINGE

Cat. No.	Dimensions						Net Price Each	
	T Thread	D Dia.	L Length	U	M	P	1-19	20-Up
351	4-40	.187	3/4	.172	.375	.375	<b>\$1.06</b>	<b>\$.95</b>
352	4-40	.187	1	.250	.375	.625	<b>1.13</b>	<b>1.02</b>
353	6-32	.250	3/4	.172	.375	.375	<b>1.48</b>	<b>1.32</b>
354	6-32	.250	1	.250	.375	.625	<b>1.52</b>	<b>1.36</b>
355	8-32	.250	3/4	.172	.375	.375	<b>1.35</b>	<b>1.20</b>
356	8-32	.250	1	.250	.375	.675	<b>1.42</b>	<b>1.28</b>

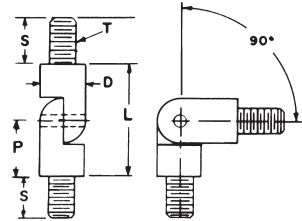

## KEYSTONE MALE/MALE HINGED STANDOFFS FOR TERMINAL BOARDS

## HINGE

Cat. No.	Dimensions					Net Price Each	
	T Thread	D Dia.	L Length	S	P	1-19	20-Up
357	4-40	.187	1/2	1/4	1/4	<b>\$1.42</b>	<b>\$1.28</b>
358	6-32	.250	1/2	5/16	1/4	<b>1.46</b>	<b>1.31</b>
359	8-32	.250	1/2	5/16	1/4	<b>1.62</b>	<b>1.45</b>

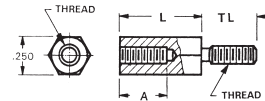

## MALE/FEMALE .250 HEX THREADED STANDOFFS 4-40 THREAD

MATERIAL: Brass, Nickel Plate. Aluminum, Clear Iridite Plate. Stainless Steel.

Thread Size	TL External	A Internal
4-40	3/16 (.187)	1/4 (.250)
6-32	1/4 (.250)	3/8 (.375)
8-32	3/8 (.375)	3/8 (.375)

Cat. No.	Length (Inches) "L"	Net Price Each		
		1-499	500-999	1000-Up
<b>STAINLESS STEEL</b>				
8712	1/4 (.250)***	<b>\$1.64</b>	<b>\$1.15</b>	<b>\$.74</b>
2087	3/8 (.375)**	<b>1.55</b>	<b>1.24</b>	<b>1.24</b>
2088	1/2 (.500)	<b>1.62</b>	<b>1.29</b>	<b>1.29</b>
2089	5/8 (.625)	<b>1.69</b>	<b>1.35</b>	<b>1.35</b>
2090	3/4 (.750)	<b>1.79</b>	<b>1.42</b>	<b>1.42</b>
2091	7/8 (.875)	<b>1.85</b>	<b>1.47</b>	<b>1.47</b>
2092	1 (1.000)	<b>1.88</b>	<b>1.49</b>	<b>1.49</b>
2093	1-1/8 (1.125)	<b>1.98</b>	<b>1.58</b>	<b>1.58</b>
2094	1-1/4 (1.250)	<b>2.05</b>	<b>1.64</b>	<b>1.64</b>
2095	1-3/8 (1.375)	<b>2.11</b>	<b>1.69</b>	<b>1.69</b>
2096	1-1/2 (1.500)	<b>2.15</b>	<b>1.71</b>	<b>1.71</b>
2097	1-5/8 (1.625)	<b>2.19</b>	<b>1.75</b>	<b>1.75</b>
2098	1-3/4 (1.750)	<b>2.22</b>	<b>1.77</b>	<b>1.77</b>
2099	2 (2.000)	<b>2.34</b>	<b>1.87</b>	<b>1.87</b>
<b>BRASS</b>				
8713	1/4 (.250)***	<b>.33</b>	<b>.23</b>	<b>.15</b>
8799	3/16 (.187)***	<b>.50</b>	<b>.35</b>	<b>.23</b>
7200	3/8 (.375)**	<b>.37</b>	<b>.26</b>	<b>.17</b>
1944	1/2 (.500)	<b>.48</b>	<b>.34</b>	<b>.22</b>
1945	5/8 (.625)	<b>.49</b>	<b>.34</b>	<b>.22</b>
1946	3/4 (.750)	<b>.58</b>	<b>.41</b>	<b>.26</b>
7201	7/8 (.875)	<b>.59</b>	<b>.41</b>	<b>.27</b>
1947	1 (1.000)	<b>.65</b>	<b>.46</b>	<b>.29</b>
7202	1-1/8 (1.125)	<b>.70</b>	<b>.49</b>	<b>.32</b>
1948	1-1/4 (1.250)	<b>.99</b>	<b>.70</b>	<b>.45</b>
1949	1-3/8 (1.375)	<b>1.02</b>	<b>.72</b>	<b>.46</b>
1950	1-1/2 (1.500)	<b>1.07</b>	<b>.75</b>	<b>.48</b>
7203	1-5/8 (1.625)	<b>1.08</b>	<b>.76</b>	<b>.49</b>
7205	1-3/4 (1.750)	<b>1.20</b>	<b>.85</b>	<b>.55</b>
1951	2 (2.000)	<b>1.21</b>	<b>.85</b>	<b>.55</b>

\*\*Internal Thread .250 Deep.  
\*\*\*Internal Thread .130/.150 Deep.

Continued on next page...

Cat. No.	Length (Inches) "L"	Net Price Each		
		1-499	500-999	1000-Up
<b>ALUMINUM</b>				
8714	1/4 (.250)***	\$ .29	\$ .20	\$ .13
8400	3/8 (.375)**	.32	.23	.15
8401	1/2 (.500)	.45	.32	.20
8402	5/8 (.625)	.49	.34	.22
8403	3/4 (.750)	.49	.35	.22
8404	7/8 (.875)	.54	.38	.24
8405	1 (1.000)	.57	.40	.26
8406	1-1/8 (1.125)	.69	.49	.32
8407	1-1/4 (1.250)	.70	.49	.32
8408	1-3/8 (1.375)	.82	.58	.37
8409	1-1/2 (1.500)	.84	.59	.38
8410	1-5/8 (1.625)	.86	.61	.39
8411	1-3/4 (1.750)	.88	.62	.40
8412	2 (2.000)	.91	.64	.42

\*\*Internal Thread .250 Deep.  
\*\*\*Internal Thread .130/.150 Deep.

Cat. No.	Length (Inches) "L"	Net Price Each		
		1-499	500-999	1000-Up
<b>ALUMINUM</b>				
8717	1/4 (.250)***	\$ .32	\$ .22	\$ .14
8413	3/8 (.375)**	.33	.24	.15
8414	1/2 (.500)	.34	.24	.15
8415	5/8 (.625)	.43	.30	.19
8416	3/4 (.750)	.43	.30	.20
8417	7/8 (.875)	.47	.33	.21
8418	1 (1.000)	.49	.35	.22
8419	1-1/8 (1.125)	.51	.36	.23
8420	1-1/4 (1.250)	.54	.38	.25
8421	1-3/8 (1.375)	.62	.43	.28
8422	1-1/2 (1.500)	.70	.50	.32
8423	1-5/8 (1.625)	.72	.50	.33
8424	1-3/4 (1.750)	.75	.53	.34
8425	2 (2.000)	.77	.54	.35

\*\*Internal Thread .250 Deep.  
\*\*\*Internal Thread .130/.150 Deep.

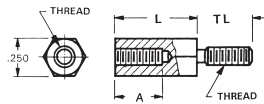

### MALE/FEMALE .250 HEX THREADED STANDOFFS 6-32 THREAD

MATERIAL: Brass, Nickel Plate, Aluminum, Clear Iridite Plate, Stainless Steel.

Thread Size	TL External	A Internal
4-40	3/16 (.187)	1/4 (.250)
6-32	1/4 (.250)	3/8 (.375)
8-32	3/8 (.375)	3/8 (.375)

Cat. No.	Length (Inches) "L"	Net Price Each		
		1-499	500-999	1000-Up
<b>STAINLESS STEEL</b>				
8715	1/4 (.250)***	\$1.41	\$ .99	\$ .64
2119	3/8 (.375)**	1.30	1.04	1.04
2120	1/2 (.500)	1.38	1.11	1.11
2121	5/8 (.625)	1.46	1.17	1.17
2122	3/4 (.750)	1.69	1.35	1.35
2123	7/8 (.875)	1.72	1.37	1.37
2124	1 (1.000)	1.79	1.42	1.42
2125	1-1/8 (1.125)	1.98	1.58	1.58
2126	1-1/4 (1.250)	2.15	1.71	1.71
2127	1-3/8 (1.375)	2.15	1.71	1.71
2128	1-1/2 (1.500)	2.19	1.75	1.75
2129	1-5/8 (1.625)	2.19	1.75	1.75
2130	1-3/4 (1.750)	2.26	1.81	1.81
2131	2 (2.000)	2.34	1.87	1.87

Cat. No.	Length (Inches) "L"	Net Price Each		
		1-499	500-999	1000-Up
<b>BRASS</b>				
8716	1/4 (.250)***	.32	.23	.15
7210	3/8 (.375)**	.38	.27	.17
1952	1/2 (.500)	.41	.29	.19
1953	5/8 (.625)	.52	.37	.24
1954	3/4 (.750)	.55	.39	.25
7211	7/8 (.875)	.63	.44	.29
1644	1 (1.000)	.65	.46	.30
7212	1-1/8 (1.125)	.69	.49	.32
1955	1-1/4 (1.250)	.82	.58	.37
1956	1-3/8 (1.375)	.89	.63	.40
1645	1-1/2 (1.500)	.90	.63	.41
7214	1-5/8 (1.625)	1.08	.76	.49
7215	1-3/4 (1.750)	1.20	.85	.55
1646	2 (2.000)	1.21	.85	.55

\*\*Internal Thread .250 Deep.  
\*\*\*Internal Thread .130/.150 Deep.

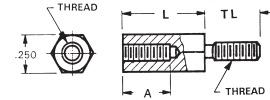

### MALE/FEMALE .250 HEX THREADED STANDOFFS 8-32 THREAD

MATERIAL: Brass, Nickel Plate, Aluminum, Clear Iridite Plate, Stainless Steel.

Thread Size	TL External	A Internal
4-40	3/16 (.187)	1/4 (.250)
6-32	1/4 (.250)	3/8 (.375)
8-32	3/8 (.375)	3/8 (.375)

Cat. No.	Length (Inches) "L"	Net Price Each		
		1-19	20-99	100-Up
<b>STAINLESS STEEL</b>				
2149	3/8 (.375)**	\$1.85	\$1.66	\$1.60
2150	1/2 (.500)	1.88	1.70	1.64
2151	5/8 (.625)	1.92	1.74	1.68
2152	3/4 (.750)	2.02	1.82	1.76
2153	7/8 (.875)	2.15	1.94	1.88
2154	1 (1.000)	2.22	2.02	1.94
2155	1-1/8 (1.125)	3.11	2.82	2.72
2156	1-1/4 (1.250)	3.27	2.95	2.85
2157	1-3/8 (1.375)	3.32	3.00	2.90
2158	1-1/2 (1.500)	3.36	3.04	2.94
2159	1-5/8 (1.625)	3.40	3.07	2.96
2160	1-3/4 (1.750)	3.45	3.12	3.01
2161	2 (2.000)	3.57	3.23	3.12

\*\*Internal Thread .250 Deep.  
\*\*\*Internal Thread .130/.150 Deep.

Cat. No.	Length (Inches) "L"	Net Price Per 1000		
		1-499	500-999	1000-Up
<b>BRASS</b>				
7220	3/8 (.375)**	\$438.88	\$308.97	\$199.51
1957	1/2 (.500)	443.19	312.01	201.47
1958	5/8 (.625)	616.49	434.00	280.25
1959	3/4 (.750)	647.40	455.77	294.30
7221	7/8 (.875)	708.80	498.99	322.21
1960	1 (1.000)	743.62	523.51	338.04
7222	1-1/8 (1.125)	797.60	561.51	362.58
1961	1-1/4 (1.250)	994.36	700.03	452.02
1962	1-3/8 (1.375)	1018.62	717.11	463.05
1963	1-1/2 (1.500)	1066.33	750.69	484.74
7224	1-5/8 (1.625)	1076.13	757.59	489.19
7225	1-3/4 (1.750)	1200.91	845.44	545.92
1964	2 (2.000)	1210.49	852.18	550.27

Cat. No.	Length (Inches) "L"	Net Price Each		
		1-499	500-999	1000-Up
<b>ALUMINUM</b>				
8426	3/8 (.375)**	443.19	312.01	201.47
8427	1/2 (.500)	450.63	317.25	204.85
8428	5/8 (.625)	485.46	341.76	220.68
8429	3/4 (.750)	516.36	363.51	234.73
8430	7/8 (.875)	573.86	404.00	260.87
8431	1 (1.000)	608.67	428.50	276.69
8432	1-1/8 (1.125)	816.38	574.74	371.12
8433	1-1/4 (1.250)	845.71	595.37	384.45
8434	1-3/8 (1.375)	912.99	642.74	415.03
8435	1-1/2 (1.500)	922.38	649.36	419.30
8436	1-5/8 (1.625)	931.75	655.95	423.56
8437	1-3/4 (1.750)	941.55	662.85	428.02
8438	2 (2.000)	951.32	669.73	432.46

\*\*Internal Thread .250 Deep.  
\*\*\*Internal Thread .130/.150 Deep.

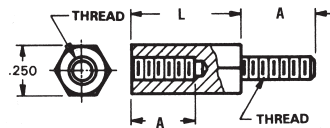

## NYLON MALE/FEMALE .250 HEX THREADED STANDOFFS

MATERIAL: Nylon 6/6.

Thread Size	"A"
4-40	3/16 (.187)
6-32	1/4 (.250)
8-32	3/8 (.375)

Cat. No.	Length (Inches) "L"	Net Price Per 1000		
		1-499	500-999	1000-Up
<b>4-40 THREAD</b>				
4799	3/16 (.187)	\$367.10	\$258.43	\$166.88
4800	1/4 (.250)	332.50	234.08	151.15
4801	3/8 (.375)	339.15	238.77	154.18
4802	1/2 (.500)	352.84	248.40	160.39
4803	5/8 (.625)	359.87	253.35	163.59
4804	3/4 (.750)	366.93	258.32	166.80
4805	7/8 (.875)	373.58	263.00	169.82
4806	1 (1.000)	380.21	267.67	172.84
4807	1-1/8 (1.125)	384.12	270.42	174.61
4808	1-1/4 (1.250)	387.26	272.63	176.05
4809	1-3/8 (1.375)	393.92	277.31	179.07
4810	1-1/2 (1.500)	400.97	282.28	182.27
4811	1-5/8 (1.625)	407.60	286.95	185.29
4812	1-3/4 (1.750)	414.63	291.90	188.48
4813	2 (2.000)	421.30	296.60	191.52

### 6-32 THREAD

4814	1/4 (.250)*	332.50	234.08	151.15
4815	3/8 (.375)	339.15	238.77	154.18
4816	1/2 (.500)	352.84	248.40	160.39
4817	5/8 (.625)	359.87	253.35	163.59
4818	3/4 (.750)	366.93	258.32	166.80
4819	7/8 (.875)	373.58	263.00	169.82
4820	1 (1.000)	380.21	267.67	172.84
4821	1-1/8 (1.125)	384.12	270.42	174.61
4822	1-1/4 (1.250)	387.26	272.63	176.05
4823	1-3/8 (1.375)	393.92	277.31	179.07
4824	1-1/2 (1.500)	400.97	282.28	182.27
4825	1-5/8 (1.625)	407.60	286.95	185.29
4826	1-3/4 (1.750)	414.63	291.90	188.48
4827	2 (2.000)	421.30	296.60	191.52

\*\*Internal Thread .130/.150 Deep.

\*\*\*Internal Thread .250 Deep.

Cat. No.	Length (Inches) "L"	Net Price Per 1000		
		1-499	500-999	1000-Up
<b>8-32 THREAD</b>				
4828	1/4 (.250)*	\$332.50	\$234.08	\$151.15
4829	3/8 (.375)**	339.15	238.77	154.18
4830	1/2 (.500)	352.84	248.40	160.39
4831	5/8 (.625)	359.87	253.35	163.59
4832	3/4 (.750)	366.93	258.32	166.80
4833	7/8 (.875)	373.58	263.00	169.82
4834	1 (1.000)	380.21	267.67	172.84
4835	1-1/8 (1.125)	384.12	270.42	174.61
4836	1-1/4 (1.250)	387.26	272.63	176.05
4837	1-3/8 (1.375)	393.92	277.31	179.07
4838	1-1/2 (1.500)	400.97	282.28	182.27
4839	1-5/8 (1.625)	407.60	286.95	185.29
4840	1-3/4 (1.750)	414.63	291.90	188.48
4841	2 (2.000)	421.30	296.60	191.52

\*\*Internal Thread .130/.150 Deep.

\*\*\*Internal Thread .250 Deep.

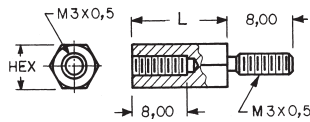

## METRIC M3 X 0.5MM MALE/FEMALE THREADED STANDOFFS

MATERIAL: Brass, Nickel Plated

Cat. No.	Dimensions			Net Price
	"L"	"A"	"B"	
<b>5.0MM HEX</b>				
4313	10.0	8.0	8.0	\$.56
4314	12.0	8.0	8.0	.57
4315	15.0	8.0	8.0	.60
4316	18.0	8.0	8.0	.64
4317	20.0	8.0	8.0	.66
4318	25.0	8.0	8.0	.73
<b>5.5MM HEX</b>				
4319	10.0	8.0	8.0	.58
4320	12.0	8.0	8.0	.59
4321	15.0	8.0	8.0	.63
4322	18.0	8.0	8.0	.68
4323	20.0	8.0	8.0	.70
4324	25.0	8.0	8.0	.78

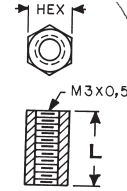

## METRIC M3 THREADED STANDOFFS

MATERIAL: Brass, ASTM-B16, Nickel Plate (QQ-N-290)

Cat. No.	Dimension "L"	Net Price
4390	5.0mm	\$.37
4391	10.0mm	.43
4392	15.0mm	.48
4393	20.0mm	.57
4394	25.0mm	.62
<b>5.5MM HEX</b>		
4395	5.0mm	.37
4396	10.0mm	.45
4397	15.0mm	.50
4398	20.0mm	.61
4399	25.0mm	.67

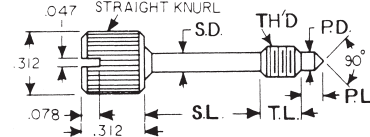

## STAINLESS STEEL CAPTIVE PANEL SCREWS

Cat. No.	TH'D	T.L.	S.D.	S.L.	P.D.	P.L.	Net Price
		+0.000 -0.015	+0.005	±0.010	+0.000 -0.010	±0.015	
8706	4-40	.125	.078	.171	.078	.078	\$2.68
8707	4-40	.125	.078	.296	.078	.078	2.94
8708	4-40	.125	.078	.421	.078	.078	3.15
8709	6-32	.218	.095	.187	.095	.093	2.94
8710	6-32	.218	.095	.312	.095	.093	3.15
8711	6-32	.218	.095	.437	.095	.093	3.36

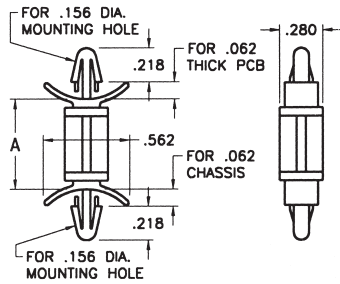

8815, 8816, 8817, 8818, 8819, 8820, 8821

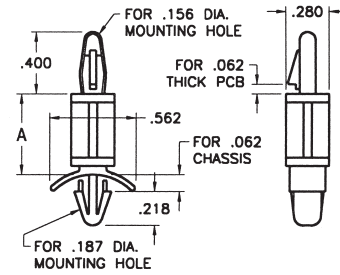

8807, 8808, 8809, 8810, 8811, 8812, 8813, 8814

## INSULATED PC LOCK-IN SUPPORTS

**FEATURES:** Easy snap-in assembly. Designed for .062 thick PC Boards and chassis. Releaseable for repairs. Strong dependable grip. No tools required for installation. **MATERIALS:** Nylon, UL Rated 94V-0.

Cat. No.	Dim. "A"	Description	Net Price Per 1000
8815	.187	One end locks into chassis, the other end into the PC Board	\$131.84
8816	.250		144.33
8817	.375		151.39
8818	.500		162.52
8819	.625		173.68
8820	.750		184.62
8821	.875		194.82
8807	.187	One end locks into chassis, the other end locks into the PC Board with easy release lever	119.32
8808	.250		127.14
8809	.375		133.39
8810	.500		143.17
8811	.625		153.34
8812	.750		163.12
8813	.875		173.30
8814	1.000		183.46

Cat. No.	Thread	O.D.	Length	Net Price Per 1000				
				1-499	500-999	1000-Up		
<b>HEX</b>								
1797A	2-56	.156 (5/32)	3/16 (.187)	\$479.57	\$337.62	\$218.00		
1797B			1/4 (.250)	514.79	362.41	234.01		
1797C			5/16 (.312)	535.91	377.27	243.62		
1797D			3/8 (.375)	406.62	286.26	184.84		
1891	4-40	.187 (3/16)	1/4 (.250)	254.07	178.87	115.49		
1892			3/8 (.375)	298.46	210.11	135.67		
1893			1/2 (.500)	328.59	231.33	149.37		
1894			5/8 (.625)	386.10	271.80	175.51		
1895			3/4 (.750)	427.96	301.28	194.54		
1896			7/8 (.875)	470.97	331.56	214.09		
1897			1 (1.000)	516.36	363.51	234.73		
2201			4-40	.250 (1/4)	1/4 (.250)	245.68	172.95	111.68
2202					3/8 (.375)	275.00	193.60	125.01
2203					1/2 (.500)	304.34	214.26	138.35
1808	5/8 (.625)	328.19			231.04	149.19		
2204	6-32	.250 (1/4)	3/4 (.750)	370.43	260.78	168.40		
1809			7/8 (.875)	422.07	297.13	191.87		
2205			1 (1.000)	470.97	331.56	214.09		
2206			1-1/2 (1.500)	802.30	564.82	364.72		
2207			2 (2.000)	925.69	651.69	420.81		
2208			1/4 (.250)	245.68	172.95	111.68		
2209			3/8 (.375)	275.00	193.60	125.01		
2210			1/2 (.500)	304.34	214.26	138.35		
1813			5/8 (.625)	346.97	244.26	157.73		
2211			3/4 (.750)	370.43	260.78	168.40		
1816	8-32	.250 (1/4)	7/8 (.875)	394.68	277.85	179.42		
2212			1 (1.000)	470.97	331.56	214.09		
1818			1-1/4 (1.250)	710.75	500.37	323.10		
2213			1-1/2 (1.500)	802.30	564.82	364.72		
1819			1-3/4 (1.750)	837.51	589.60	380.72		
2214			2 (2.000)	925.69	651.69	420.81		
1820			2-1/4 (2.250)	1027.61	723.44	467.14		
1825			2-1/2 (2.500)	1123.64	791.04	510.79		
2215			1/4 (.250)	245.68	172.95	111.68		
2216			3/8 (.375)	275.00	193.60	125.01		
2217	1/2 (.500)	304.34	214.26	138.35				
1827	8-32	.375 (3/8)	5/8 (.625)	336.01	236.55	152.74		
2218			3/4 (.750)	362.23	255.01	164.66		
1828			7/8 (.875)	449.85	316.68	204.49		
2219			1 (1.000)	470.97	331.56	214.09		
2220			1-1/2 (1.500)	802.30	564.82	364.72		
2221			2 (2.000)	925.69	651.69	420.81		
1926A			3/8 (.375)	414.63	291.90	188.48		
1926B			1/2 (.500)	434.21	305.68	197.38		
1926C			5/8 (.625)	568.38	400.14	258.38		
1926D			3/4 (.750)	660.31	464.85	300.17		
1926E	1 (1.000)	801.13	563.99	364.18				
<b>ROUND</b>								
1801A	2-56	.156 (5/32)	3/16 (.187)	450.25	316.97	204.68		
1801B			1/4 (.250)	445.53	313.65	202.53		
1801C			5/16 (.312)	482.32	339.55	219.25		
1901D			3/8 (.375)	00.00	00.00	00.00		
2025	4-40	.187 (3/16)	1/4 (.250)	251.92	177.35	114.52		
2026			3/8 (.375)	290.64	204.61	132.12		
2027			1/2 (.500)	320.77	225.82	145.82		
2028			5/8 (.625)	378.66	266.57	172.13		
2029			3/4 (.750)	422.07	297.13	191.87		
2030			7/8 (.875)	462.36	325.50	210.18		
2031			1 (1.000)	516.36	363.51	234.73		
3478			4-40	.250 (1/4)	1/4 (.250)	222.98	156.98	101.36
3479					3/8 (.375)	246.84	173.77	112.21
3480					1/2 (.500)	277.34	195.25	126.07
1839	5/8 (.625)	300.80			211.76	136.74		
3481	3/4 (.750)	337.99			237.94	153.64		
1846	7/8 (.875)	415.82			292.74	189.02		
3482	1 (1.000)	459.64			323.59	208.94		
3483	1-1/2 (1.500)	776.09			546.37	352.80		
3484	2 (2.000)	898.92	632.84	408.64				

NOTE: Spacers over 1.000" long are tapped .375" deep each end.

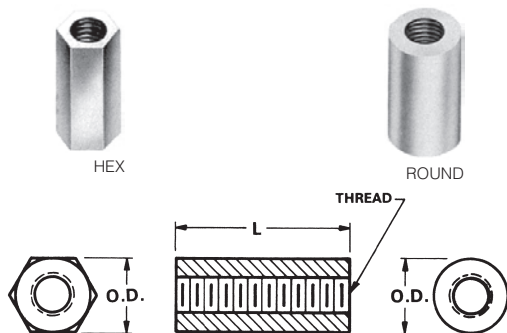

HEX AND ROUND THREADED STANDOFFS  
ALUMINUM IRIDITE FINISH

Continued on next page....

Cat. No.	Thread	O.D.	Length	Net Price Per 1000				
				1-499	500-999	1000-Up		
<b>ROUND (CONTINUED)</b>								
3485	6-32	.250 (1/4)	1/4 (.250)	\$222.98	\$156.98	\$101.36		
3486			3/8 (.375)	246.84	173.77	112.21		
3487			1/2 (.500)	277.34	195.25	126.07		
1847			5/8 (.625)	329.36	231.86	149.72		
3488			3/4 (.750)	337.99	237.94	153.64		
1848			7/8 (.875)	371.03	261.21	168.67		
3489			1 (1.000)	459.64	323.59	208.94		
1853			1-1/4 (1.250)	696.49	490.33	316.61		
3490			1-1/2 (1.500)	776.09	546.37	352.80		
1855			1-3/4 (1.750)	823.61	579.82	374.40		
3491			2 (2.000)	898.92	632.84	408.64		
1856			2-1/4 (2.250)	1000.62	704.44	454.87		
1857			2-1/2 (2.500)	1096.46	771.90	498.44		
3492			8-32	.250 (1/4)	1/4 (.250)	222.98	156.98	101.36
3493					3/8 (.375)	246.84	173.77	112.21
3494	1/2 (.500)	277.34			195.25	126.07		
1858	5/8 (.625)	300.80			211.76	136.74		
3495	3/4 (.750)	337.99			237.94	153.64		
1859	7/8 (.875)	371.03			261.21	168.67		
3496	1 (1.000)	459.64			323.59	208.94		
3497	1-1/2 (1.500)	776.09			546.37	352.80		
3498	2 (2.000)	898.92			632.84	408.64		
2315A	8-32	.375 (3/8)			3/8 (.375)	612.96	431.52	278.64
2315B					1/2 (.500)	688.46	484.67	312.97
2315C					5/8 (.625)	741.65	522.12	337.15
2315D					3/4 (.750)	795.64	560.13	361.69
2315E					1 (1.000)	948.98	668.08	431.39

NOTE: Spacers over 1.000" long are tapped .375" deep each end.

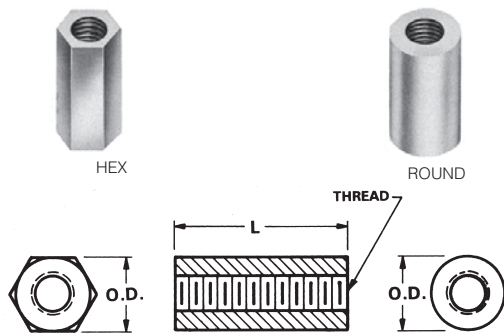

### HEX AND ROUND THREADED STANDOFFS BRASS ZINC PLATE

Cat. No.	Thread	O.D.	Length	Net Price Per 1000		
				1-499	500-999	1000-Up
<b>HEX</b>						
1798A	2-56	.156 (5/32)	3/16 (.187)	\$562.90	\$396.28	\$255.88
1798B			1/4 (.250)	471.75	332.11	214.45
1798C			5/16 (.312)	729.16	513.32	331.46
1798D			3/8 (.375)	677.49	476.95	307.98
1450	4-40	.187 (3/16)	1/4 (.250)	284.78	200.48	129.46
1803			3/8 (.375)	333.67	234.91	151.68
1656			1/2 (.500)	391.58	275.67	178.00
1804			5/8 (.625)	476.07	335.15	216.41
1656A			3/4 (.750)	537.88	378.67	244.51
1805			7/8 (.875)	659.90	464.57	299.98
1656B	1 (1.000)	693.54	488.25	315.28		
1450A	4-40	.250 (1/4)	1/4 (.250)	265.99	187.26	120.91
1450B			3/8 (.375)	333.27	234.62	151.50
1450C			1/2 (.500)	385.31	271.25	175.16
1829			5/8 (.625)	520.27	366.27	236.51
1450D			3/4 (.750)	595.37	419.14	270.64
1830			7/8 (.875)	632.94	445.59	287.72
1450E			1 (1.000)	670.08	471.73	304.61
1831			1-1/2 (1.500)	1268.57	893.07	576.67
1832			2 (2.000)	1300.25	915.37	591.08

NOTE: Spacers over 1.000" long are tapped .375" deep each end.

Cat. No.	Thread	O.D.	Length	Net Price Per 1000				
				1-499	500-999	1000-Up		
<b>HEX (CONTINUED)</b>								
1451A	6-32	.250	1/4 (.250)	\$265.99	\$187.26	\$120.91		
1451B			3/8 (.375)	333.27	234.62	151.50		
1451C			1/2 (.500)	385.31	271.25	175.16		
1451D			5/8 (.625)	520.27	366.27	236.51		
1474A	8-32	.250 (1/4)	1/4 (.250)	265.99	187.26	120.91		
1474B			3/8 (.375)	333.27	234.62	151.50		
1474C			1/2 (.500)	385.31	271.25	175.16		
1834			5/8 (.625)	520.27	366.27	236.51		
1474D			3/4 (.750)	595.37	419.14	270.64		
1836			7/8 (.875)	632.94	445.59	287.72		
1474E			1 (1.000)	670.08	471.73	304.61		
1452A			8-32	.375 (3/8)	3/8 (.375)	534.14	376.03	242.81
1452B					1/2 (.500)	686.89	483.57	312.25
1452C					5/8 (.625)	887.95	625.12	403.65
1452D	3/4 (.750)	957.59			674.14	435.31		
1452E	1 (1.000)	1235.90			870.08	561.83		
1876	7/8 (.875)	623.54			438.97	283.45		
1547E	1 (1.000)	694.71			489.07	315.80		
1877	1-1/2 (1.500)	1230.83			866.50	559.52		
1878	2 (2.000)	1257.62			885.36	571.70		
1802A	2-56	.156 (5/32)			3/16 (.187)	445.53	313.65	202.53
1802B			1/4 (.250)	479.19	337.35	217.84		
1802C			5/16 (.312)	496.38	349.45	225.65		
1802D			3/8 (.375)	496.38	349.45	225.65		
1548E			3/4 (.750)	537.48	378.39	244.33		
1879			7/8 (.875)	593.81	418.04	269.94		
1548F			1 (1.000)	616.89	434.29	280.43		
1881			1-1/4 (1.250)	856.27	602.81	389.25		
1882			1-1/2 (1.500)	1230.83	866.50	559.52		
1883			1-3/4 (1.750)	1257.62	885.36	571.70		
1884	2 (2.000)	1257.62	885.36	571.70				
1885	2-1/4 (2.250)	1289.69	907.94	586.28				
1886	2-1/2 (2.500)	1326.85	934.10	603.17				
1547	4-40	.187 (3/16)	1/4 (.250)	286.32	201.57	130.16		
1864			3/8 (.375)	329.36	231.86	149.72		
1657			1/2 (.500)	387.26	272.63	176.05		
1865			5/8 (.625)	474.09	333.76	215.51		
1657A			3/4 (.750)	523.58	368.60	238.01		
1866			7/8 (.875)	658.73	463.74	299.45		
1657B			1 (1.000)	687.69	484.13	312.62		
1889			1-1/2 (1.500)	1230.83	866.50	559.52		
1899			2 (2.000)	1322.56	931.08	601.22		
1547A			4-40	.250 (1/4)	1/4 (.250)	306.68	215.90	139.42
1547B	3/8 (.375)	358.70			252.53	163.06		
1547C	1/2 (.500)	437.52			308.01	198.89		
1867	5/8 (.625)	494.05			347.80	224.59		
1547D	3/4 (.750)	553.12			389.39	251.44		

NOTE: Spacers over 1.000" long are tapped .375" deep each end.

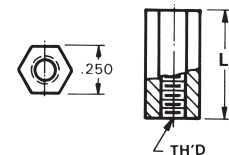

### HEX THREADED NYLON STANDOFFS

Economical for terminal or printed circuit board supports. **MATERIAL:** Nylon 6/6.

Cat. No.	"L" Length (Inches)	Net Price Per 1000		
		1-499	500-999	1000-Up
<b>4-40 THREAD</b>				
1902A	1/4 (.250)	\$466.68	\$328.53	\$212.14
1902B	3/8 (.375)	477.62	336.24	217.12
1902C	1/2 (.500)	497.57	350.29	226.19
1902F	5/8 (.625)	433.42	305.12	197.03
1902D	3/4 (.750)	639.18	449.98	290.56
1902G	7/8 (.875)	488.20	343.69	221.93
1902E	1 (1.000)	643.09	452.74	292.34

Continued on next page....

Cat. No.	"L" Length (Inches)	Net Price Per 1000		
		1-499	500-999	1000-Up
<b>6-32 THREAD</b>				
1903A	1/4 (.250)	\$466.68	\$328.53	\$212.14
1903B	3/8 (.375)	477.62	336.24	217.12
1903C	1/2 (.500)	497.57	350.29	226.19
1903F	5/8 (.625)	433.42	305.12	197.03
1903D	3/4 (.750)	639.18	449.98	290.56
1903G	7/8 (.875)	488.20	343.69	221.93
1903F	1 (1.000)	433.42	305.12	197.03
<b>8-32 THREAD</b>				
1904A	1/4 (.250)	466.68	328.53	212.14
1904B	3/8 (.375)	477.62	336.24	217.12
1904C	1/2 (.500)	497.57	350.29	226.19
1904F	5/8 (.625)	433.42	305.12	197.03
1904D	3/4 (.750)	639.18	449.98	290.56
1904G	7/8 (.875)	488.20	343.69	221.93
1904E	1 (1.000)	643.09	452.74	292.34

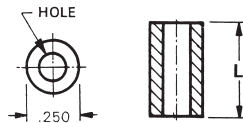
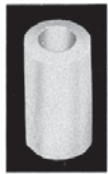

### ROUND THRU-HOLE NYLON SPACERS

Economical for terminal or printed circuit board supports. **MATERIAL:** Nylon 6/6.

Cat. No.	"L" Length (Inches)	Net Price Per 1000		
		1-499	500-999	1000-Up
<b>#4 SCREW, .120 HOLE</b>				
875	1/8 (.125)	\$107.00	\$75.33	\$48.64
876	1/4 (.250)	116.18	81.79	52.81
877	3/8 (.375)	122.83	86.47	55.84
878	1/2 (.500)	130.26	91.71	59.21
879	5/8 (.625)	140.42	98.86	63.83
880	3/4 (.750)	142.78	100.51	64.91
881	7/8 (.875)	145.90	102.71	66.32
882	1 (1.000)	154.13	108.50	70.06
<b>#6 SCREW, .140 HOLE</b>				
883	1/8 (.125)	107.00	75.33	48.64
884	1/4 (.250)	116.18	81.79	52.81
885	3/8 (.375)	122.83	86.47	55.84
886	1/2 (.500)	130.26	91.71	59.21
887	5/8 (.625)	140.42	98.86	63.83
888	3/4 (.750)	142.78	100.51	64.91
889	7/8 (.875)	145.90	102.71	66.32
890	1 (1.000)	154.13	108.50	70.06
<b>#8 SCREW, .171 HOLE</b>				
891	1/8 (.125)	107.00	75.33	48.64
892	1/4 (.250)	116.18	81.79	52.81
893	3/8 (.375)	122.83	86.47	55.84
894	1/2 (.500)	130.26	91.71	59.21
895	5/8 (.625)	140.42	98.86	63.83
896	3/4 (.750)	142.78	100.51	64.91
897	7/8 (.875)	145.90	102.71	66.32
898	1 (1.000)	154.13	108.50	70.06

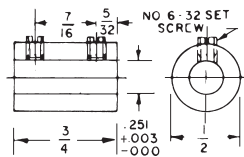

### 1/4" - 1/4" SHAFT COUPLING

**Material:** Brass, Nickel Plated (QQ-N-290). Two set screws hold shaft securely. Supplied unassembled.

Cat. No.	Net Price
1453	\$2.51

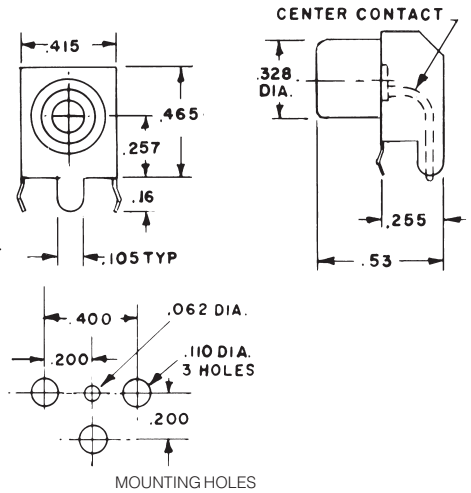
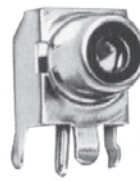

### SNAP-FIT 90° PC PHONE JACK

Complete one piece jack for insertion into PC board. Time saving. No wiring required. **MATERIAL:** Shell: Steel. Contact: Brass.

Cat. No.	Description	Net Price Per 1000
901	Tin Plate	\$1163.35
900	Gold Plate	1401.17

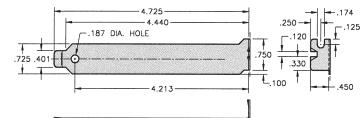
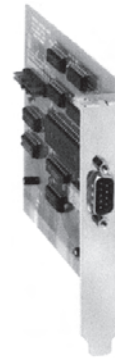

9200

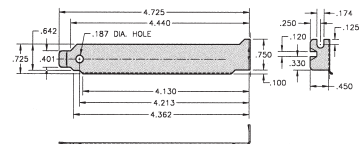

9201

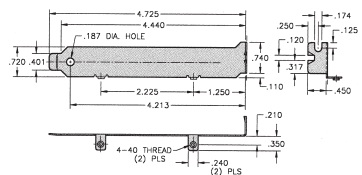

9202

Continued on next page....

## HH Smith

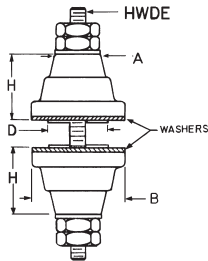

### STEATITE INSULATED THRU-PANEL BUSHINGS

Consists of a pair of steatite insulators along with cushion washers and hardware. The 9555 assembly has interlocking insulators which are self centering in mounting hole and may be used on very thin panels. Cushion washers are "Champak" compressed paper or cork. These insulators are ideal for high-voltage, high temperature applications.

Cat. No.	Dimension				Hdwre
	H	B	D	A	
9550AA	1/2"	3/4"	1/2"	3/8"	6-32
9552AA	1-1/8"	1-3/4"	1-1/4"	7/8"	1/4"-20

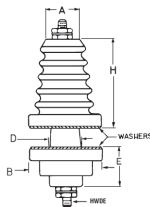
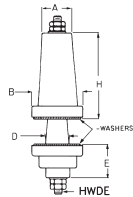

### THRU-PANEL HIGH VOLTAGE INSULATORS

These insulators are ideal for high-voltage, high-temperature standoff and/or feedthru applications. They are not intended for high-vacuum or hermetically sealed use, nor with heavy shear-loads. Compression mounted by means of a stud throughout the entire length of the unit. Extrusion of insulator base extends thru mounting hole, increasing the voltage breakdown rating. Units have flat mounting surfaces and are furnished with cushion washer. Types with jacks have terminal permitting connection above, as well as below panel.

#### STEATITE

Cat. No.	Illus.	H	B	D	E	A	Hdwre.
9542AA	L	7/8"	3/4"	1/8"	3/8"	1/2"	10-32
9540AB	L	1-1/4"	15/16"	7/16"	1/2"	19/32"	10-32

#### PORCELAIN

Cat. No.	Illus.	H	B	D	E	A	Hdwre.
9545	N	1-3/8"	1-1/4"	1/2"	1 1/16"	5/8"	10-32
9546AA	L	2-3/4"	1-3/8"	1 1/16"	1"	15/16"	1/4"-20
9547AA	L	4-1/2"	2-1/8"	3 1/32"	1-1/2"	1-1/16"	1/4"-20

**NOTE: PLEASE CONTACT YOUR ELECTRO SONIC SALES REPRESENTATIVE FOR PRICING AND AVAILABILITY**

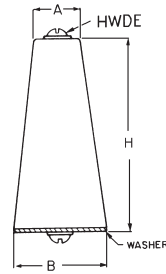

### STEATITE CONE INSULATORS

Constructed of grade L-423 or better steatite, with threaded holes. Insulators are furnished complete with two nickel-plated machine screws, nickel-plated brass washers, with cork cushion washer.

Cat. No.	H	B	A	Hdwre
9500	2 1/32"	5/8"	7/16"	6-32
9501	1-1/32"	3/4"	1/2"	8-32

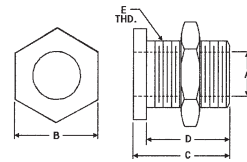

### PANEL BEARING

**MATERIAL:** Brass, nickel-plated. Supplied with hex nut. Thread: 3/8-32. For 1/4 shaft.

Cat. No.	Dimensions (Inches)			
	A	B	C	D
119	.253	7/16	1/2	7/16

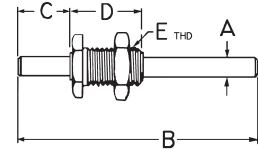

### HH SMITH PANEL BEARING ASSEMBLIES

Brass, nickel-plated for 1/4" and 1/8" shafts.

Cat. No.	Dimensions				
	A	B	C	D	E
148	.250"	3"	1/2"	1/2"	3/8"-32
149	.250"	6"	1/2"	1/2"	3/8"-32

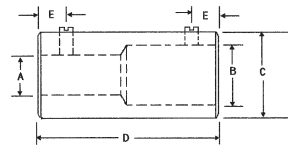

### SHAFT COUPLERS

**MATERIAL:** Brass, nickel-plated. #2 screws.

Cat. No.	Dimensions (Inches)				
	A	B	C	D	E
120	1/4	1/4	7/16	3/4	3/16

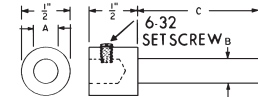

### HH SMITH SHAFT EXTENDERS LONG SHAFT TYPE

Cat. No.	A	B	C	Material
150	1/4"-1/4"		1-1/4"	Brass
160	1/4"-1/4"		3/8"	Brass