

8815, 8816, 8817, 8818, 8819, 8820, 8821

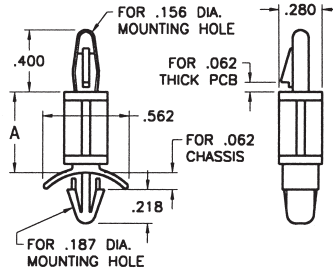
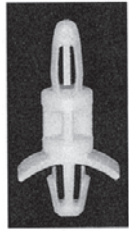

8807, 8808, 8809, 8810, 8811, 8812, 8813, 8814

INSULATED PC LOCK-IN SUPPORTS

FEATURES: Easy snap-in assembly. Designed for .062 thick PC Boards and chassis. Releaseable for repairs. Strong dependable grip. No tools required for installation. **MATERIALS:** Nylon, UL Rated 94V-0.

Cat. No.	Dim. "A"	Description	Net Price Per 1000
8815	.187	One end locks into chassis, the other end into the PC Board	\$131.84
8816	.250		144.33
8817	.375		151.39
8818	.500		162.52
8819	.625		173.68
8820	.750		184.62
8821	.875		194.82
8807	.187	One end locks into chassis, the other end locks into the PC Board with easy release lever	119.32
8808	.250		127.14
8809	.375		133.39
8810	.500		143.17
8811	.625		153.34
8812	.750		163.12
8813	.875		173.30
8814	1.000		183.46



HEX



ROUND

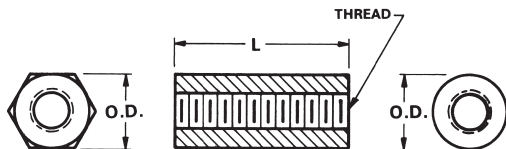

HEX AND ROUND THREADED STANDOFFS
ALUMINUM IRIDITE FINISH

Cat. No.	Thread	O.D.	Length	Net Price Per 1000				
				1-499	500-999	1000-Up		
HEX								
1797A	2-56	.156 (5/32)	3/16 (.187)	\$479.57	\$337.62	\$218.00		
1797B			1/4 (.250)	514.79	362.41	234.01		
1797C			5/16 (.312)	535.91	377.27	243.62		
1797D			3/8 (.375)	406.62	286.26	184.84		
1891	4-40	.187 (3/16)	1/4 (.250)	254.07	178.87	115.49		
1892			3/8 (.375)	298.46	210.11	135.67		
1893			1/2 (.500)	328.59	231.33	149.37		
1894			5/8 (.625)	386.10	271.80	175.51		
1895			3/4 (.750)	427.96	301.28	194.54		
1896			7/8 (.875)	470.97	331.56	214.09		
1897			1 (1.000)	516.36	363.51	234.73		
2201			4-40	.250 (1/4)	1/4 (.250)	245.68	172.95	111.68
2202					3/8 (.375)	275.00	193.60	125.01
2203					1/2 (.500)	304.34	214.26	138.35
1808	5/8 (.625)	328.19			231.04	149.19		
2204	6-32	.250 (1/4)	3/4 (.750)	370.43	260.78	168.40		
1809			7/8 (.875)	422.07	297.13	191.87		
2205			1 (1.000)	470.97	331.56	214.09		
2206			1-1/2 (1.500)	802.30	564.82	364.72		
2207			2 (2.000)	925.69	651.69	420.81		
2208			1/4 (.250)	245.68	172.95	111.68		
2209			3/8 (.375)	275.00	193.60	125.01		
2210			1/2 (.500)	304.34	214.26	138.35		
1813			5/8 (.625)	346.97	244.26	157.73		
2211			3/4 (.750)	370.43	260.78	168.40		
1816	8-32	.250 (1/4)	7/8 (.875)	394.68	277.85	179.42		
2212			1 (1.000)	470.97	331.56	214.09		
1818			1-1/4 (1.250)	710.75	500.37	323.10		
2213			1-1/2 (1.500)	802.30	564.82	364.72		
1819			1-3/4 (1.750)	837.51	589.60	380.72		
2214			2 (2.000)	925.69	651.69	420.81		
1820			2-1/4 (2.250)	1027.61	723.44	467.14		
1825			2-1/2 (2.500)	1123.64	791.04	510.79		
2215			1/4 (.250)	245.68	172.95	111.68		
2216			3/8 (.375)	275.00	193.60	125.01		
2217	1/2 (.500)	304.34	214.26	138.35				
1827	8-32	.375 (3/8)	5/8 (.625)	336.01	236.55	152.74		
2218			3/4 (.750)	362.23	255.01	164.66		
1828			7/8 (.875)	449.85	316.68	204.49		
2219			1 (1.000)	470.97	331.56	214.09		
2220			1-1/2 (1.500)	802.30	564.82	364.72		
2221			2 (2.000)	925.69	651.69	420.81		
1926A			3/8 (.375)	414.63	291.90	188.48		
1926B			1/2 (.500)	434.21	305.68	197.38		
1926C			5/8 (.625)	568.38	400.14	258.38		
1926D			3/4 (.750)	660.31	464.85	300.17		
1926E	1 (1.000)	801.13	563.99	364.18				
ROUND								
1801A	2-56	.156 (5/32)	3/16 (.187)	450.25	316.97	204.68		
1801B			1/4 (.250)	445.53	313.65	202.53		
1801C			5/16 (.312)	482.32	339.55	219.25		
1901D			3/8 (.375)	00.00	00.00	00.00		
2025	4-40	.187 (3/16)	1/4 (.250)	251.92	177.35	114.52		
2026			3/8 (.375)	290.64	204.61	132.12		
2027			1/2 (.500)	320.77	225.82	145.82		
2028			5/8 (.625)	378.66	266.57	172.13		
2029			3/4 (.750)	422.07	297.13	191.87		
2030			7/8 (.875)	462.36	325.50	210.18		
2031			1 (1.000)	516.36	363.51	234.73		
3478			4-40	.250 (1/4)	1/4 (.250)	222.98	156.98	101.36
3479					3/8 (.375)	246.84	173.77	112.21
3480					1/2 (.500)	277.34	195.25	126.07
1839	5/8 (.625)	300.80			211.76	136.74		
3481	3/4 (.750)	337.99			237.94	153.64		
1846	7/8 (.875)	415.82			292.74	189.02		
3482	1 (1.000)	459.64			323.59	208.94		
3483	1-1/2 (1.500)	776.09			546.37	352.80		
3484	2 (2.000)	898.92			632.84	408.64		

NOTE: Spacers over 1.000" long are tapped .375" deep each end.

Continued on next page....

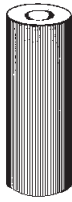

HH SMITH NICKEL PLATED BRASS SPACERS

ALL 1/4" O.D.

Cat. No.	Length	Clearance Hole
ROUND CLEARANCE		
2105	.250	#8
2340	.250	#4
2107	.500	#8
2108	.750	#8
2109	1.000	#8
ROUND THREADED		
2374	1.000	4-40

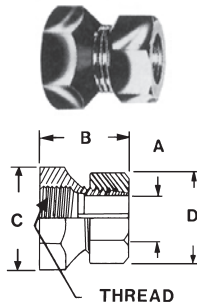

HH SMITH BRASS, NICKEL-PLATED SHAFT LOCK

Cat. No.	For Shaft Size	Dimensions				Thread Size
		A	B	C	D	
181	1/4"	.253"	1/2"	1/2"	7/16"	3/8-32

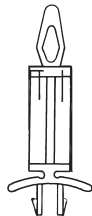

PRINTED CIRCUIT BOARD SUPPORTS

Made of flame retardant nylon. Snaps into circuit board and chassis. Fits in chassis hole .187 diameter. Fits in PC board hole .156.

Cat. No.	Length
4295	3/8"

NOTE: PLEASE CONTACT YOUR ELECTRO SONIC SALES REPRESENTATIVE FOR PRICING AND AVAILABILITY

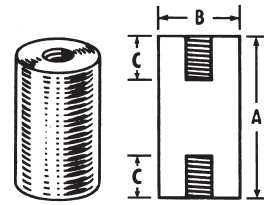

HH SMITH CERAMIC STANDOFFS OUTSIDE GLAZED

Cat. No.	Dimensions		
	A	B	C
2642	3/8"	3/8"	5/32"
2644	1/2"	1/2"	9/64"
2645	3/4"	1/2"	1/4"
2646	1"	1/2"	3/8"
2647	1-1/2"	1/2"	9/16"

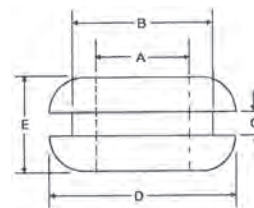

RUBBER GROMMETS

MATERIALS: Black Buna-S synthetic rubber (SBR), approximately 60 durometer.

Cat. No.	Dimensions (Inches)				
	A	B	C	D	E
2187	5/8	7/8	1/16	1-1/8	5/16

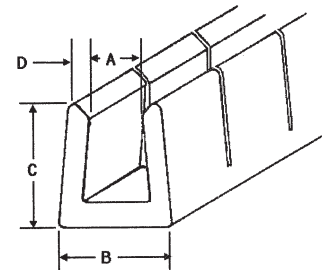

CATERPILLAR GROMMETS

MATERIALS: Black nylon, type 6/6. **APPLICATIONS:** "U" shaped nylon extrusion, with slits along length to make grommets fit and size (Minimum 1" dia.) or shape hole, in chassis from 1/32 to 1/8" thick.

Cat. No.	Chassis Thickness (Inches)	Dimensions (Inches)			
		A	B	C	D
2692	.032-.052	.052	.125	.190	.040
2693	.052-.085	.170	.205	.205	.045
2694	.084-.125	.125	.210	.220	.045

**MOVING? CHANGING JOBS?
PLEASE LET US KNOW TO KEEP OUR RECORDS
UP TO DATE AND KEEP YOU INFORMED.**