

## VOLTAGE REGULATORS

Cat. No.	Regulated Voltage Out (Volts) $V_{OUT}$	Case Style	Voltage In (Volts) $V_{IN}$		Output Current (Amps) $I_o$	Power Dissipation (Watts) $P_D$	Net Price
			Min	Max			
<b>POSITIVE, 3 TERMINAL (<math>\pm 5\%</math>)</b>							
NTE960	5V	TO220	7	35	1	15	\$2.54
NTE977	5V	TO92	7	30	0.1	1	2.10
NTE962	6V	TO220	8	35	1	15	2.27
NTE964	8V	TO220	10.5	35	1	15	2.84
NTE950	12V	TO92	14.5	35	0.1	1	2.72
NTE966	12V	TO220	14.8	35	1	15	2.54
NTE968	15V	TO220	17.5	35	1	15	2.54
NTE972	24V	TO220	27	40	1	15	2.54
<b>POSITIVE ADJUSTABLE</b>							
NTE935	1.2V to 32V	TO3	3	35	5	50	24.16
NTE970	1.2V to 32V	TO3	3	35	3	50	18.50
NTE956	1.2V to 33V	TO220	3	40	1.5	15	3.41
<b>NEGATIVE ADJUSTABLE</b>							
NTE961	-5V	TO220	-7	-35	1	15	2.54
NTE967	-12V	TO220	-14.5	-35	1	15	2.54
NTE969	-15V	TO220	-17.5	-35	1	15	2.54
<b>PRECISION, POSITIVE OR NEGATIVE SUPPLY (0.01% LINE AND LOAD REGULATION)</b>							
NTE923	$\pm 2V$ to $\pm 37V$	10-Lead Metal Can	9.5	40	0.15	0.8	7.77
NTE923D	$\pm 2V$ to $\pm 37V$	14-Lead DIP	9.5	40	0.15	1	2.32

## INTEGRATED CIRCUITS, LINEAR

Cat. No.	Package Type	Description	Net Price
NTE987	14-Lead DIP	Quad OP Amplifier	\$3.27
NTE1289	12-Lead DIP	TV Vertical Deflection System	19.14
NTE1561	9-Lead SIP	5-LED VU Level Meter	6.00
NTE1674	9-Lead SIP	TV Vertical Deflection Output Circuit	5.86
NTE1690	16-Lead DIP	CMOS, Telephone Dual Tone Multi-Frequency Dialer (DTMF)	7.78
NTE1720	16-Lead DIP	Pulse Width Modulator (PWM) Regulator	5.81
NTE1729	16-Lead DIP	Pulse Width Modulator (PWM) Control Circuit	6.63
NTE1773	7-Lead SIP	Color TV Vertical Deflection Output Circuit	4.58

## INTEGRATED CIRCUITS, TTL

Cat. No.	Package Type	Description	Net Price
NTE7400	14-Lead DIP	Quad 2-Input Positive NAND Gate	\$2.12
NTE7402	14-Lead DIP	Quad 2-Input Positive NOR Gate	2.42
NTE7404	14-Lead DIP	Hex Inverter	1.77
NTE7406	14-Lead DIP	Hex Inverter Buffer/Driver w/ Open Collector High Voltage Outputs	2.09
NTE7407	14-Lead DIP	Hex Buffer Driver w/ Open Collector High Voltage Outputs	1.99
NTE7408	14-Lead DIP	Quad 2-Input Positive AND Gate	2.59
NTE7420	14-Lead DIP	Dual 4-Input NAND Gate	1.42
NTE7432	14-Lead DIP	Quad 2-Input OR Gate	2.59
NTE7473	14-Lead DIP	Dual J-K Flip-Flop w/ Clear	4.66
NTE7474	14-Lead DIP	Dual D-Type Positive Edge Triggered Flip-Flop w/ Preset and Clear	1.32
NTE7476	16-Lead DIP	Dual J-K Flip-Flop w/ Preset and Clear	3.54
NTE7490	14-Lead DIP	Decade Counter Divide by 2 & 5	3.39
NTE74C00	14-Lead DIP	Quad 2-Input Positive NAND Gate	3.01

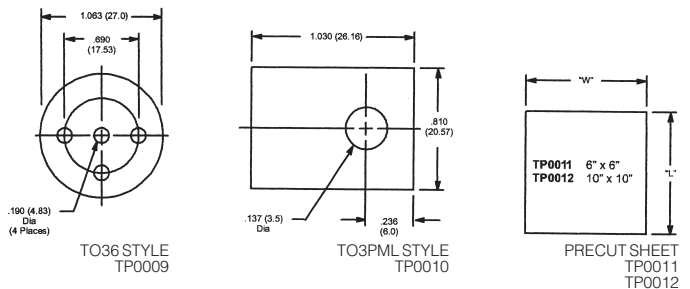
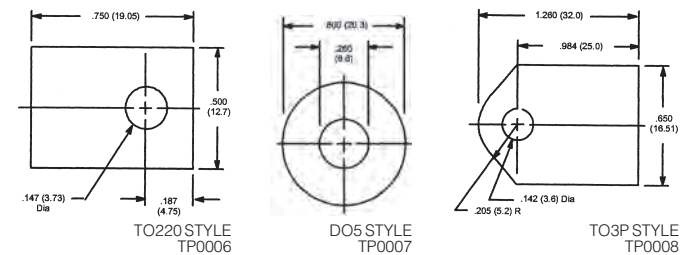
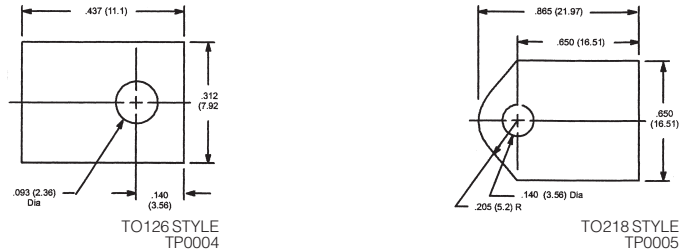
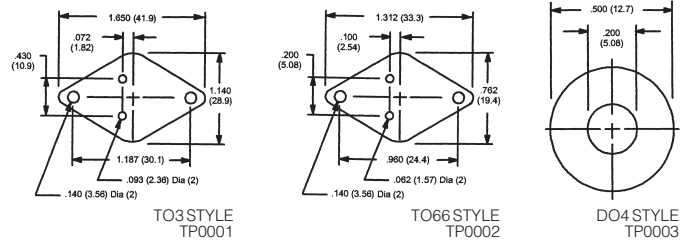

## NTE THERMAL PADS AND THERMAL COMPOUND

These thermally conductive insulators offer low heat transfer resistance while still providing high electrical isolation between the parts of the assembly. The elastomeric material combines the electrical isolation of rigid insulators with the ability to conform to rough surfaces and reduce contact resistance. Proper selection and use of these THERMO-PADS results in a securely-mounted power semiconductor and minimum resistance to the heat transfer between it and the heat sink.

Cat. No.	Description	Net Price
<b>HEAT SINK COMPOUND</b>		
NTE303	1 Gram Tube of Thermal Grease (5 Tubes/pkg)	\$2.47
<b>THERMO PADS</b>		
TP0001	TO3 Style (5/pkg)	3.14
TP0002	TO66 Style (5/pkg)	2.64
TP0003	DO4 Style (5/pkg)	1.89
TP0004	TO126 Style (5/pkg)	1.79
TP0005	TIP/TO218 Style (5/pkg)	2.37
TP0006	TO220 Style (5/pkg)	2.30
TP0007	DO5 Style (5/pkg)	2.30
TP0008	TO3P Style (5/pkg)	2.92
TP0010	TO3PML Style (5/pkg)	4.59
<b>INSULATOR KITS (EACH KIT INCLUDES MICA INSULATOR AND NYLON BUSHINGS)</b>		
NTE413	Insulator kit for TO3 type pkg (2/pkg)	2.67
NTE422	Insulator kit for type pkg (2/pkg)	2.30
NTE438	Insulator kit for DO4/TO64 type pkg	.90
NTE439	Insulator kit for DO5/TO48 type pkg	.95

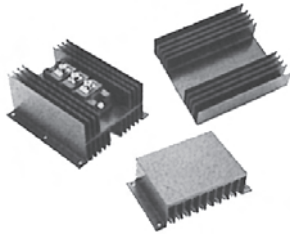

## 394, 395, 396 SERIES PERFORMANCE, LOW PROFILE HEAT SINKS FOR POWER MODULES

Cat. No.	Overall Dimensions: in. (mm)			Device Base Mounting Area (mm)
	Length	Height	Width	
394-1AB	3.000 (76.2)	1.500 (38.1)	5.000 (127.0)	101 x 76
394-2AB	5.500 (139.7)	1.500 (38.1)	5.000 (127.0)	101 x 139
395-1AB	3.000 (76.2)	2.500 (63.5)	5.000 (127.0)	50 x 76
395-2AB	5.500 (139.7)	2.500 (63.5)	5.000 (127.0)	50 x 139
396-1AB	3.000 (76.2)	1.380 (35.1)	5.000 (127.0)	50 x 76
396-2AB	5.500 (139.7)	1.380 (35.1)	5.000 (127.0)	50 x 139

Cat. No.	Base Mounting Holes	Thermal Resistance at Typical Load		Net Price
		Natural Convection ( $\theta_{SA}$ ) <sup>1</sup> (°C/W)	Forced Convection ( $\theta_{SA}$ ) (°C/W@500LFM)	
394-1AB	4	1.85	0.90	\$24.85
394-2AB	6	1.51	0.60	31.71
395-1AB	4	1.10	0.50	25.03
395-2AB	6	0.90	0.32	33.96
396-1AB	4	1.85	1.07	22.29
396-2AB	6	1.51	0.64	28.97

Note: <sup>1</sup>Thermal resistance values shown are for black anodized finish at 50°C rise above ambient.



## WAKEFIELD 510 & 511 SERIES HIGH FIN DENSITY HEAT SINKS

The 510 and 511 series are unique extrusions which provide maximum cooling efficiency per unit volume. The broad flat base is ideally suited for cooling multiple power-generating components.

Cat. No.	Width	Height	Length	Net Price
<b>510 SERIES (UNFINISHED ALUMINUM FINISH, UNMACHINED BASE)</b>				
5103U	7.4"	3.136"	3"	\$27.01
5106U	7.4"	3.136"	6"	46.36
5109U	7.4"	3.136"	9"	66.21
51012U	7.4"	3.136"	12"	85.87
<b>510 SERIES (UNFINISHED ALUMINUM FINISH, MACHINED BASE)</b>				
5103M	7.4"	3.076"	3"	50.56
5106M	7.4"	3.076"	6"	72.95
5109M	7.4"	3.076"	9"	94.79
51012M	7.4"	3.076"	12"	115.96
<b>511 SERIES (UNFINISHED ALUMINUM FINISH, UNMACHINED BASE)</b>				
5113U	5.3"	2.335"	3"	17.95
5116U	5.3"	2.335"	6"	30.11
5119U	5.3"	2.335"	9"	72.11
51112U	5.3"	2.335"	12"	84.98
<b>511 SERIES (UNFINISHED ALUMINUM FINISH, MACHINED BASE)</b>				
5113M	5.3"	2.305"	3"	41.50
5116M	5.3"	2.305"	6"	56.70
5119M	5.3"	2.305"	9"	71.56
51112M	5.3"	2.305"	12"	84.24

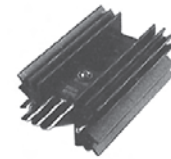

## 657 SERIES HIGH-PERFORMANCE NOTCHED HEAT SINKS FOR VERTICAL BOARD MOUNTING

Cat. No.	Height Above PC Board	Thermal Performance at Typical Load		Net Price
		Natural Convection	Forced Convection	
657-10ABPN	1.000 in. (25.4)	41°C@6W	3.7°C/W@200LFM	\$1.99
657-15ABPN	1.500 in. (38.1)	38°C@6W	3.3°C/W@200LFM	2.06
657-20ABPN	2.000 in. (50.8)	32°C@6W	2.9°C/W@200LFM	2.42
657-25ABPN	2.500 in. (63.5)	25°C@6W	2.7°C/W@200LFM	2.55



## WAKEFIELD 120 THERMAL JOINT COMPOUND

### WAKEFIELD 120 THERMAL JOINT COMPOUND

Cat. No.	Container Size	Net Price
120-2	2 oz. jar	\$8.11
120-5	5 oz. tube	15.41
120-8	8 oz. jar	22.24
120-80	5 lb. can	134.09

### WAKEFIELD 126 THERMAL JOINT COMPOUND

Cat. No.	Size	Net Price
126-2	2 oz. jar	\$12.82
126-4	4 oz. tube	19.59



## WAKEFIELD DELTA BOND 152

### WAKEFIELD DELTA 150 EPOXY SYSTEMS

Cat. No.	Contents	Net Price
152-1-A	1 oz BiPack Resin and Hardener "A"	\$21.67
152-K-A	7 oz Resin, .5 oz Hardener "A"	88.58
152-Q	1 quart Adhesive Resin only	111.99



### WAKEFIELD HARDENERS (FOR USE WITH DELTA BOND 152 AND DELTA CAST 153)

Cat. No.	Thermal Resistivity	Working Time @77°F	Cure Time		Shear Strength Bond @77°F 1" Overlap - PSI	
			Initial Time @250°F	Post Time (hrs) @200°F	152	153
WA-4	47°C/W	45 min	20 min	4	2900	2500
WB-4	42°C/W	30 min	15 min	4	2300	1900

### WAKEFIELD HARDENERS (FOR USE WITH DELTA BOND 152 AND DELTA CAST 153)

Cat. No.	Parts of Hardener reqd. per 100 Parts of Resin	Bottle Size	Net Price
A-4	7.5	4.8 oz	\$44.73
B-4	3.5	4.8 oz	24.98

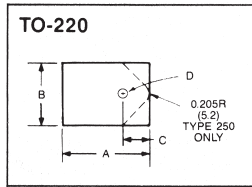
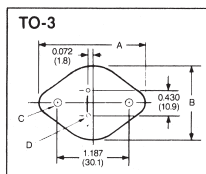
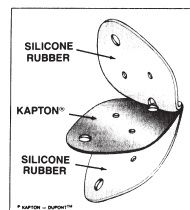

### WAKEFIELD 175 SERIES GREASELESS, THERMALLY CONDUCTIVE KAPTON™ REINFORCED INSULATORS

A highly effective, thermally conductive, greaseless way to interface transistors to heat sinks. New improved Kapton™ film gives a high dielectric, physically tough insulator that withstands high voltages. No messy thermal grease is required. These insulators are the most effective products of their type. Available in standard shapes to fit TO-3 and TO-220 semiconductors.

Cat. No.	Dimensions Inches (mm)			
	A	B	C	D
<b>FITS TO-3 CASE</b>				
1756310P	1.593 (40,5)	1.100 (27,9)	0.156 (4,0)	0.062 (1,6)
1756320P	1.650 (41,9)	1.140 (29,0)	0.122 (3,1)	0.062 (1,6)
1756330P	1.650 (41,9)	1.140 (29,0)	0.140 (3,6)	0.093 (2,4)
<b>FITS TO-220 CASE</b>				
1756210P	0.687 (17,4)	0.562 (14,3)	0.218 (5,5)	0.125 (3,2)
1756220P	0.710 (18,0)	0.500 (12,7)	0.160 (4,1)	0.141 (3,6)
1756230P	0.750 (19,1)	0.500 (12,7)	0.187 (4,7)	0.125 (3,2)
1756240P	0.750 (19,1)	0.500 (12,7)	0.187 (4,7)	0.147 (3,7)
1756250P	0.865 (22,0)	0.650 (16,5)	0.250 (5,2)	0.140 (3,6)

### WAKEFIELD 175 SERIES KAPTON REINFORCED INSULATORS

Cat. No.	Thermal Resistance	Dielectric Strength	Thermal Conduct.	Net Price
<b>FITS TO-3 CASE</b>				
1756310P	0.40°C/W	6000V	1.2 × 10 <sup>-3</sup>	\$44
1756320P				.71
1756330P				.33
<b>FITS TO-220 CASE</b>				
1756210P	0.40°C/W	6000V	1.2 × 10 <sup>-3</sup>	.24
1756220P				.21
1756230P				.17
1756240P				.18
1756250P				.29



156 SERIES

### WAKEFIELD DELTA BOND 156

This adhesive is designed for permanent mounting of components where heat must be efficiently transmitted. Replaces mechanical fasteners and compressible pads, silicon grease, and epoxies; eliminates air entrapment and other variables related to epoxy mixing. A modified acrylic adhesive which, when used with DeltaBOND Activator, fixtures at room temperature in less than five minutes. Full strength is developed in 4 to 12 hours and fillets become dry to the touch in 24 hours. Only recommended for use with DeltaBOND Activator.

NOTE: This adhesive contains a metallic filler which, in certain applications, may have an effect on electrical properties. Therefore, test each particular application to ensure that electrical properties are as required.

Cat. No.	Description	Net Price
<b>THERMALLY CONDUCTIVE ADHESIVE KIT</b>		
156K	25 ml Syringe and Activator Kit	\$47.76

# electro sonic

Electro Sonic  
appreciates your business

1-800-56-SONIC

www.e-sonic.com

info@e-sonic.com

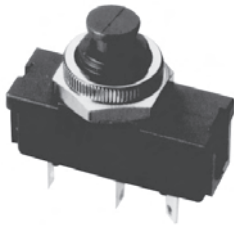

1410-G111



1410-L210

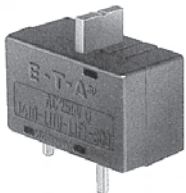

1410-L1

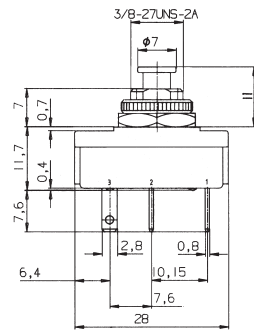
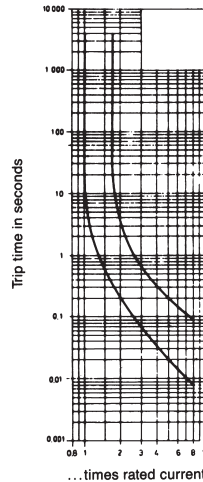

1410-G111-L2F1-S01

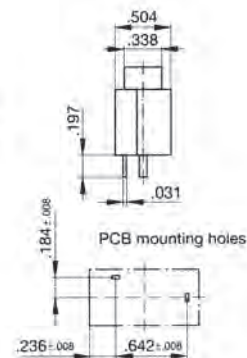
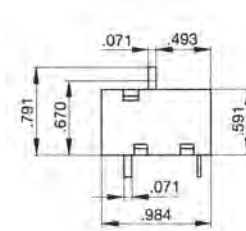
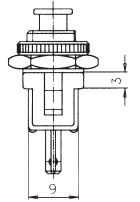

1410-L110-L1F1-S01

## E-T-A HIGH-SPEED THERMAL CIRCUIT BREAKERS

The 1410 Series are High-speed Thermal Circuit Breakers particularly suited to PC board and electronic component protection. They are 100% tested and each version comes with one normally open auxiliary contact for trip indication. **FEATURES:** Extremely small physical size. PC board, single hold threadneck or snap-in mounting. PC board pins or blade terminals. Manual reset. Temperature stable. **TECHNICAL DATA:** maximum voltage rating: 125V AC 48V DC. Typical life a 2x rated current: 300 operations. Switch capacities: 8x rated current UL 1077 tested and approved to 200 amps. **APPROVALS:** CSA, UL and VDE. Amperages from 0.63 to 8 amp available.

### STANDARD CURRENT RATINGS AND TYPICAL INTERNAL RESISTANCE VALUES

Current rating (A)	Internal resistance (Ω)	Current rating (A)	Internal resistance (Ω)
0.63	1.8	3.15	< 0.12
0.8	1.7	4	< 0.1
1	< 1.3	4.5	< 0.1
1.25	1.0	5	< 0.1
1.5	< 1.0	6.3	< 0.1
1.8	< 1.0	8.0	< 0.1
2	< 1.0	10.0	< 0.1
2.5	< 0.12		

Cat. No.	Amps	Net Price
----------	------	-----------

#### PC BOARD MOUNT

1410-L210-L2F1-S02-1	1.0	\$12.41
----------------------	-----	---------

#### THREADNECK MOUNT

1410-G111-P2F1-S01-1	1.0	12.41
----------------------	-----	-------

**NOTE:** Fixed prices from 1 amp upwards see price table. Ordering information and current rating tables shown above.

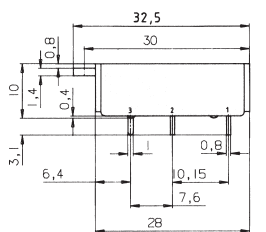

1410-L210-L2F1-S02

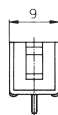

**NOTE:** Visit the E-T-A link at [www.e-sonic.com](http://www.e-sonic.com) for parts configuration



1410 SERIES

### E-T-A HIGH-SPEED ROCKER SWITCH THERMAL CIRCUIT BREAKERS

Miniaturized single pole rocker switch/thermal circuit breaker combining ON/OFF switching and extremely fast overload performance in a single component (S-type TO CBE to EN 50934). Under overload conditions an internal neon (filament bulb for low voltages) illuminates to give a clear signal of the tripped status of the mechanism and thereby the cause of power interruption, suffix-B. Alternatively the illumination can be conventionally wired to indicate the ON status of the device, suffix-E. Returning the rocker switch through the OFF position and back ON will reset the mechanism and restore the supply.

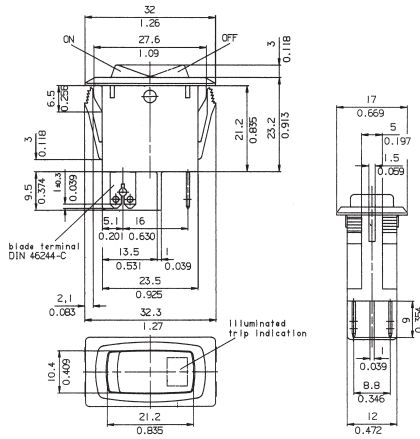

Current rating (A)	Internal resistance (Ω)	Current rating (A)	Internal resistance (Ω)
0.63	1.05	3.15	< 0.1
0.8	1.0	4	< 0.1
1	< 1	5	< 0.1
1.5	< 1	6.3	< 0.1
1.8	< 0.8	8	< 0.1
2	< 0.8	10	< 0.1
2.5	< 0.12		

#### SNAP-IN ROCKER SWITCHES

Cat. No.	Amps	Net Price
1410-F110-P1F1-W14Q-2	2.0	\$24.30
1410-F110-P1F1-W14Q-2.5	2.5	24.30
1410-F110-P1F1-W14Q-5	5.0	24.30
1410-F110-P1F1-W14Q-6.3	6.3	20.25

**NOTE:** Fixed prices from 2 amp upwards see price table. Ordering information and current rating tables shown above.

**NOTE:** Visit the E-T-A link at [www.e-sonic.com](http://www.e-sonic.com) for parts configuration

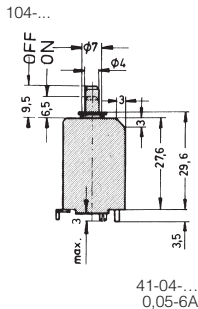

41-04-...  
0,05-6A

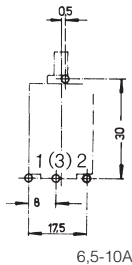

6,5-10A

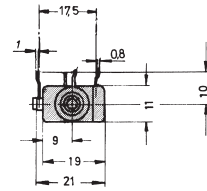

41-06-...

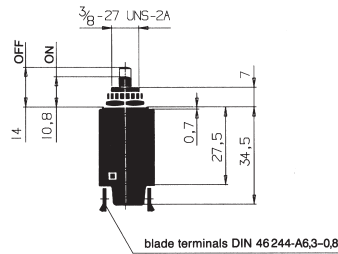
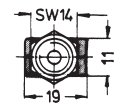
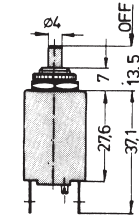

1140-G...

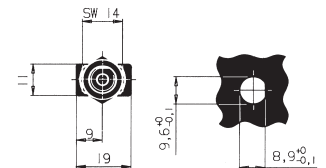
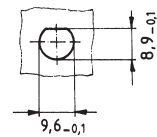
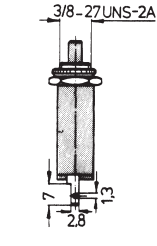
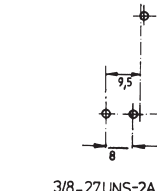

### E-T-A MINIATURE THERMAL CIRCUIT BREAKERS

These full-featured circuit breakers are well-suited for the protection of transformers, power supplies, instrumentation and more. They are individually calibrated and 100% tested for precise delay characteristics. **FEATURES:** Small physical size. PC board or single hole threadneck mounting. PC board or .250" blade terminals. Manual reset. Trip-free, tease-free mechanism. **TECHNICAL DATA:** Maximum voltage rating: 250V AC 48V DC. Typical life at 2x rated current: .5A-3.0A 5000 operations, 3.5A-15.0A 1000 operations. Switching capacities: 104 PR/106 P10/106 P30: 0.5-2.0A max 6x rated current, 2.5-10.0A max 5X rated current. 1140-G: 8.0A-15.0A max 120A. UL 1077 tested and approved to 2000 amps (104-PR) (106-P10) (106-P30), 1000 amps (1140-G). **APPROVALS:** CSA, UL, VDE.

#### STANDARD CURRENT RATINGS AND TYPICAL INTERNAL RESISTANCE VALUES

Current rating (A)	Internal resistance (Ω)	Current rating (A)	Internal resistance (Ω)
0.05	285	1.8	0.28
0.08	134	2	0.25
0.1	81	2.5	0.18
0.2	22	3	0.11
0.3	8.7	3.5	0.076
0.4	5.5	4	0.067
0.5	3.3	4.5	0.051
0.6	2.45	5	≤0.05
0.7	1.6	6	≤0.05
0.8	1.45	7	≤0.05
1	0.9	8	≤0.05
1.2	0.6	10	≤0.05
1.5	0.4		

Continued on next page....

# E-T-A Circuit Breakers

## MINIATURE THERMAL CIRCUIT BREAKERS

Cat. No.	Amps	Net Price
<b>PC BOARD MOUNT</b>		
104-PR-0.5A	0.5	\$21.72
104-PR-1A	1.0	21.72
<b>SINGLE HOLE MOUNT (BLADE TERMINAL 6.3 × 0.8MM)</b>		
106-P10-0.5	0.5	21.72
106-M2-P10-1A	1.0	20.25
<b>SINGLE HOLE MOUNT (BLADE TERMINAL 2.8 × 0.8MM)</b>		
106-M2-P30-0.5A	0.5	20.25
106-M2-P30-1A	1.0	20.25

**NOTE:** Fixed prices from 1.0 amp upwards see price table. Ordering information and current rating tables shown above.

## PANEL MOUNT

Cat. No.	Amps	Net Price
1140-G111-P1M1-8	8.0	\$15.87
1140-G111-P1M1-10	10.0	.00
1140-G111-P1M1-12	12.0	.00
1140-G111-P1M1-15	15.0	15.87

**NOTE:** Visit the E-T-A link at [www.e-sonic.com](http://www.e-sonic.com) for parts configuration



1658...

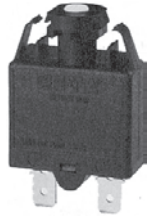

1658-F

### E-T-A SERIES 1658

Very cost effective design to meet international requirements. No exposed metal parts which are, or could become, current-carrying except for terminals. R-type TO CBE to EN 60934. **FEATURES:** Manual reset, cycling trip free mechanism. Extremely small and lightweight. UL, CSA, VDE and EN 60934 (IEC 60934) approved.

### STANDARD CURRENT RATINGS AND TYPICAL VOLTAGE DROP VALUES

Current rating (A)	Voltage drop (mV)	Current rating (A)	Voltage drop (mV)
5	≤ 150	12	≤ 140
6	≤ 150	15	≤ 240
7	≤ 150	16	≤ 240
8	≤ 150	20	≤ 240
9	≤ 150	25	≤ 240
10	≤ 140	30	≤ 240

### SERIES 1658

Cat. No.	Amps	Net Price
1658-G41-02-P10-5	5.0	\$4.65
1658-G41-02-P10-10	10.0	4.65
1658-G41-02-P10-15	15.0	4.65
1658-G41-02-P10-20	20.0	5.49
1658-G41-02-P10-25	25.0	5.49

**NOTE:** Fixed prices from 20.0 amp upwards see price table. Ordering information and current rating tables shown above.

**NOTE:** Visit the E-T-A link at [www.e-sonic.com](http://www.e-sonic.com) for parts configuration



3120-F...

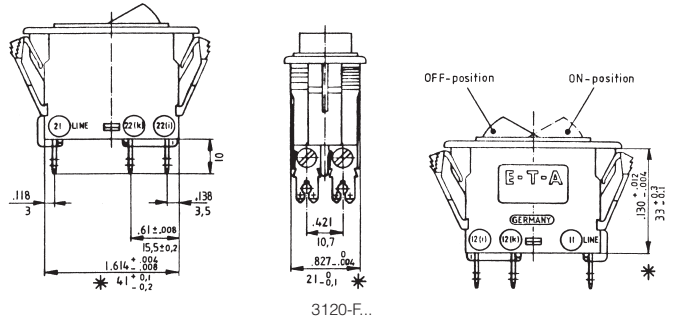

3120-F...

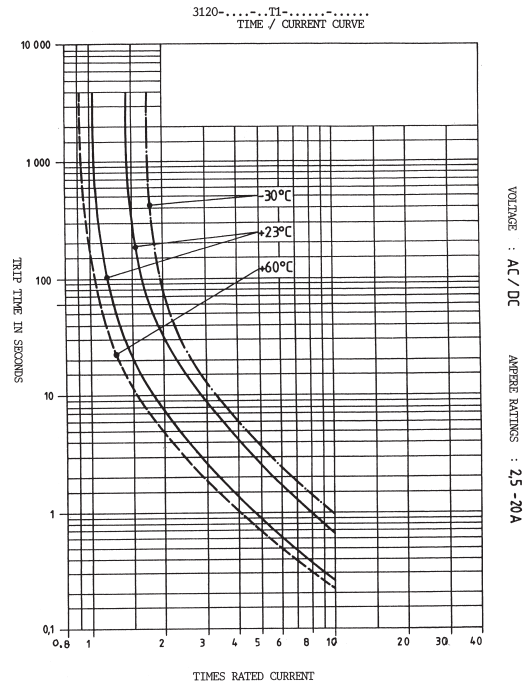

### E-T-A ON/OFF SWITCH CIRCUIT BREAKER

Our 3120 Series offers a comprehensive line-up of features and options. Available with or without illumination, single or two pole rocker. The 3120 is individually calibrated and 100% tested for foolproof operation. **FEATURES:** On-off switch breaker. Neon bulb illumination. Snap in mounting. Rocker returns to off position on overload. Trip-free mechanism. **TECHNICAL DATA:** Maximum voltage rating: 250 AC, 28V DC. Typical life at rated current: ≥50,000 operations. Switching capacities: ≤2A, 10 x rated current, 2.5—20A 300A max. UL 1077 tested and approved to 350 amps. **APPROVALS:** CSA, UL, VDE.

Continued on next page...

## SINGLE POLE CIRCUIT BREAKERS

Cat. No.	Amps	Net Price
<b>UNLIGHTED, WITH RED ROCKER HANDLE</b>		
3120-F311-P7T1-W04X-1A	1.0	\$23.09
3120-F311-P7T1-W04X-2A	2.0	21.62
3120-F311-P7T1-W04X-3A	3.0	19.25

## LIGHTED, WITH RED TRANSLUCENT ROCKER HANDLE, (115 VAC)

3120-F311-P7T1-W14X-B3-1A	1.0	28.80
3120-F311-P7T1-W14X-B3-2A	2.0	33.60
3120-F311-P7T1-W14X-B3-3A	3.0	19.25

## E-T-A DOUBLE POLE CIRCUIT BREAKERS

### UNLIGHTED, WITH RED ROCKER HANDLE

3120-F321-P7T1-W04X-1A	1.0	49.17
3120-F321-P7T1-W04X-2A	2.0	49.17
3120-F321-P7T1-W04X-3A	3.0	35.08

### LIGHTED, WITH RED TRANSLUCENT ROCKET HANDLE, (115 VAC)

3120-F321-P7T1-W14X-B3-0.5A	0.5	47.86
3120-F321-P7T1-W14X-B3-1A	1.0	47.86
3120-F321-P7T1-W14X-B3-2A	2.0	47.86
3120-F321-P7T1-W14X-B3-3A	3.0	42.25

**NOTE:** Fixed prices from 3.0 amp upwards see price table. Ordering information and current rating tables shown above.

**NOTE:** Visit the E-T-A link at [www.e-sonic.com](http://www.e-sonic.com) for parts configuration.

**NOTE:** Visit the E-T-A link at [www.e-sonic.com](http://www.e-sonic.com) for parts configuration



2-5700-...

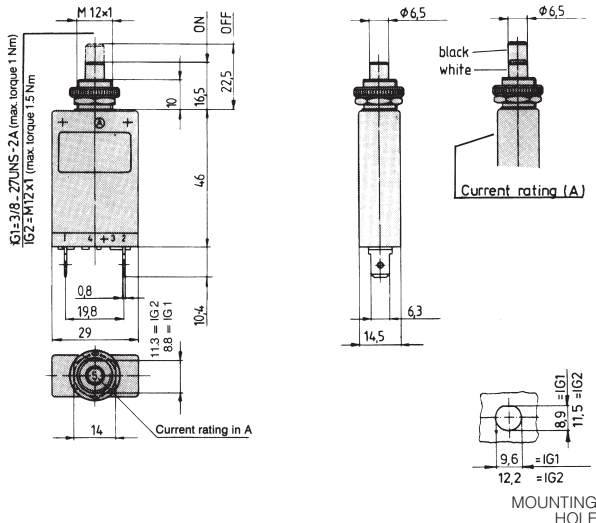

## E-T-A 2-5700 SERIES FULL FEATURE THERMAL CIRCUIT BREAKERS

The 2-5700 Series is a full featured fool-proof circuit breaker, well-suited to a wide variety of applications such as motors, transformers and solenoids as well as low voltage wiring protection. They are individually calibrated and 100% tested for precise delay characteristics. **FEATURES:** Robust design for dependability. Single hole threadneck mounting. Manual reset version 45-700-IG1-P10. On-off switch version, 45-700-IG1-P10-DD. Tease-free, Trip-free mechanism.

**TECHNICAL DATA:** Maximum voltage rating: 250V AC 28V DC. Typical life at 2x rated current: 5000 operations. Switching capacities: 8x rated current ( $\leq 2.5A$ ), 20x rated current (3-5A), 200 amps max. (6-12A), 400 amps max. (15A). UL 1077 tested and approved to 2000 amps. **APPROVALS:** CSA, UL, VDE.

### STANDARD CURRENT RATINGS AND TYPICAL INTERNAL RESISTANCE VALUES

Current rating (A)	Internal resistance ( $\Omega$ )	Current rating (A)	Internal resistance ( $\Omega$ )
0.05	280	3	0.09
0.08	100	3.5	0.064
0.1	110	4	0.064
0.2	29	4.5	0.05
0.3	14	5	0.05
0.4	7.0	6	0.02
0.5	4.9	7	0.02
0.6	3.4	8	< 0.02
0.7	2.5	10	< 0.02
0.8	1.8	12	< 0.02
1	1.2	13	< 0.02
1.2	0.84	15	< 0.02
1.5	0.6	16	< 0.02
1.8	0.37	20	< 0.02
2	0.27	22	< 0.02
2.5	0.2	25	< 0.02

### FULL FEATURE THERMAL CIRCUIT BREAKERS

Cat. No.	Amps	Net Price
2-5700-IG1-P10-1	1.0	\$16.92
2-5700-IG1-P10-2	2.0	19.71
2-5700-IG1-P10-3	3.0	19.04
2-5700-IG1-P10-3.5	3.5	19.04
2-5700-IG1-P10-5	5.0	18.95
2-5700-IG1-P10-10	10.0	18.95

### ON/OFF SWITCH VERSION

2-5700-IG1-P10-DD-1	1.0	22.29
2-5700-IG1-P10-DD-2	2.0	21.53
2-5700-IG1-P10-DD-5	5.0	21.94
2-5700-IG1-P10-DD-10	10.0	22.71

**NOTE:** Fixed prices from 10.0 amp upwards see price table. Ordering information and current rating tables shown above.

**NOTE:** Visit the E-T-A link at [www.e-sonic.com](http://www.e-sonic.com) for parts configuration.

**NOTE:** Visit the E-T-A link at [www.e-sonic.com](http://www.e-sonic.com) for parts configuration