

LETTERS—UPPER CASE

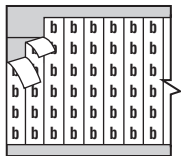

LOWER CASE

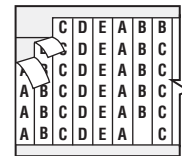

CONSECUTIVE LETTERS

LEGEND—LETTERS

	B-500 Vinyl Cloth	B-702 Vinyl Film	B-605 Over- Laminated	B-184 Aluminum Foil	B-12 Acetate Cloth	Markers Per Card	
						1.500" (38.10 mm)	0.750" (19.05 mm)
A B C and so on thru Z	WM-A WM-B WM-C and so on thru WM-Z	TWM-A TWM-B TWM-C and so on thru TWM-Z	OLWM-A OLWM-B OLWM-C and so on thru OLWM-Z	AF-A AF-B AF-C and so on thru AF-Z	HH-A HH-B HH-C and so on thru HH-Z	36 36 36	72 72 72
a b c and so on thru z	WM-A-SML WM-B-SML WM-C-SML and so on thru WM-Z-SML					36 36 36	72 72 72
A-Z A-Z plus A-J a-z	WM-A-Z WM-A-Z, AJ WM-A-Z-SML	TWM-A-Z TWM-A-Z-SML	OLWM-A-Z	AF-A-Z		26 36	52 72
						26	52

NOTE: For pricing please contact your Electro Sonic sales representative.

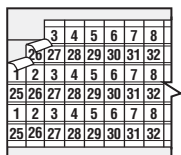

TERMINAL MARKERS

LEGEND—TERMINAL MARKERS

	Catalogue Number	Markers Per Card 0.312" x 0.187" (8.00 mm x 5.00 mm)
1-48	WM-1-48-TM	144
49-96	WM-49-96-TM	144
A-Z*	WM-A-Z-TM	144

*Terminal Markers have no "I" or "O".

NOTE: For pricing please contact your Electro Sonic sales representative.

Electrical Application Labels

PTL-21-400
 TLS2200 technology Die # 21, 1.00 x 2.50 Material B-400, White Vinyl

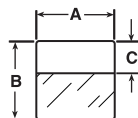

DIA. 1

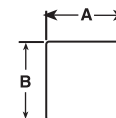

DIA. 2

CABLE MARKING LABELS

PART NUMBER EXPLANATION: Most Brady part numbers for printable labels follow the same three-part format: the first code indicates the technology, the second part is a number indicating the die size used (where applicable), and the third part indicates the Brady material used (where applicable).

REPOSITIONAL VINYL CLOTH (B-498), SELF-LAMINATING VINYL (B-427), NYLON CLOTH (B-499), SELF-LAMINATING TEDLAR® (B-642)

Cat. No.	Diagram	Labels Per Roll	Label Dimensions Inch (mm) A	Write-On Height Inch (mm) B	Maximum Characters Inch (mm) C	Maximum Lines Per Line For Font:			Maximum Lines Of Text For Font:			Net Price
						2	7	10	2	7	10	
PTL-21-498	2	100	1.00 (25.40)	2.50 (63.50)	0.75 (19.05)	24	10	7	23	14	9	\$36.55
PTL-21-427*	1	100	1.00 (25.40)	2.50 (63.50)	0.75 (19.05)	24	10	7	8	4	2	30.36
BPTL-21-427	1	1000	1.00 (25.40)	2.50 (63.50)	0.75 (19.05)	24	10	7	8	4	2	237.57
PTL-21-499	2	100	1.00 (25.40)	2.50 (63.50)	0.75 (19.05)	24	10	7	8	4	2	43.10
PTL-21-642	1	100	1.00 (25.40)	2.50 (63.50)	0.75 (19.05)	24	10	7	8	4	2	46.71
PTL-23-427*	1	100	1.00 (25.40)	4.00 (101.60)	1.00 (25.40)	24	10	7	10	5	3	36.00
PTL-33-427*	1	100	1.50 (38.10)	4.00 (101.60)	1.00 (25.40)	37	15	10	10	5	3	48.98
PTL-34-427*	1	50	1.50 (38.10)	6.00 (152.40)	1.50 (38.10)	37	15	10	16	8	5	40.63

NOTE: Tedlar® is a registered trademark of DuPont.

*Also available in: **OR**= orange, **GN**= green, **GY**= grey, **PL**= purple, **BL**= blue, **BR**= brown, **YL**= yellow, **RD**= red. To order a colour, add a dash "-" after the material number, then add the colour suffix. Standard product: contact your Electro Sonic customer service representative for ordering information.