

## BC COMPONENTS LONG-LIFE ELECTROLYTIC CAPACITORS

### FEATURES:

- Useful Life 2000 to 1000 hours at 105°C
- Temperature Range: -40 to +105°C
- Tolerance on Cr: +/-20%

Cat. No.	Cap (µF)	Voltage	Dimensions (mm) (D x L)	Ripple Current	Net Price
2222 138 35101	16	100	7.7 x 12.7	130	\$1.31
2222 138 35471	16	470	10 x 18	360	1.39
2222 138 15102	16	1000	10 x 30	630	1.40
2222 138 36229	25	22	6.3 x 12.7	61	1.19
2222 138 36479	25	47	7.7 x 12.7	96	1.31
2222 138 36101	25	100	6.5 x 18	160	1.03
2222 138 36221	25	220	10 x 18	270	1.39
2222 138 36471	25	470	10 x 25	440	1.68
2222 138 16102	25	1000	12.5 x 30	790	1.60
2222 138 37101	40	100	8 x 18	180	1.11
2222 138 37221	40	220	10 x 25	350	1.68
2222 138 17471	40	470	12.5 x 30	650	1.48
2222 138 17102	40	1000	15 x 30	970	2.06
2222 138 38229	63	22	6.5 x 18	100	1.03
2222 138 38479	63	47	8 x 18	150	1.11
2222 138 38101	63	100	10 x 25	280	1.68
2222 138 18221	63	220	12.5 x 30	560	1.47
2222 138 18471	63	470	15 x 30	860	2.02
2222 138 18102	63	1000	18 x 40	1460	3.21
2222 138 19101	100	100	12.5 x 30	410	1.55
2222 138 19221	100	220	15 x 30	650	2.17
2222 138 19471	100	470	18 x 40	1130	3.44

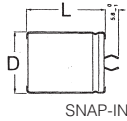
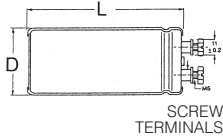

## BC COMPONENTS LONG-LIFE SNAP-IN CAPACITORS

**FEATURES:** Long life up to 10000 hours at 105°C. Low ESR, high ripple current capability. **SPECIFICATIONS:** Temperature range: -40 to 105°C. Tolerance: ±20%. Shelf life at 40°C and 1.9xI<sub>r</sub> applied: 500 hours. Climatic category IEC 60068: 40/105/56.

Cat. No.	Cap (µF)	Diameter D x L (mm)	Ripple Current (A)	Max. ESR Ohms 120 Hz +20°C	Net Price
<b>40VDC</b>					
222205857222	2200	22 x 30	2.04	87	\$3.54
222205857332	3300	25 x 30	2.43	71	3.98
222205857472	4700	30 x 30	2.96	59	4.67
222205857103	10000	35 x 40	4.18	46	6.76
<b>63VDC</b>					
222205858222	2200	30 x 30	2.27	101	4.62
222205858332	3300	30 x 40	3.07	70	5.45
222205858472	4700	35 x 40	3.65	60	6.62
222205858682	6800	35 x 50	4.58	46	7.89
222205859102	1000	30 x 30	1.79	163	4.67

## BC COMPONENTS SCREW TERMINAL HIGH RIPPLE POWER CAPACITORS

**FEATURES:** Long life. Pressure relief in the sealing. **SPECIFICATIONS:** Temperature range: -40 to +85°C. Tolerance: ±20%. Shelf life at 0V, 85°C: 500 hours. Climatic category IEC 60068: 40/085/56.

Cat. No.	Cap (µF)	Diameter D x L (mm)	Ripple Current (A)	Max. ESR Ohms 120 Hz +20°C	Net Price
<b>25VDC</b>					
222210126333	33000	50 x 80	9	19	\$21.82
222210116473	47000	35 x 105	12.1	15	21.45
<b>40VDC</b>					
222210127473	47000	50 x 105	14.6	12	31.18
<b>63VDC</b>					
222210128103	10000	35 x 105	8.1	27	20.25
222210128223	22000	50 x 105	11.1	19	29.78
222210128333	33000	65 x 105	12.9	14	42.17
<b>100VDC</b>					
222210129332	3300	35 x 80	6	42	18.98
222210129103	10000	50 x 105	10.5	21	32.92
<b>250VDC</b>					
222210223682	6800	76 x 146	18.1	21	51.89
<b>450VDC</b>					
222210227102	1000	50 x 105	5.7	118	32.35

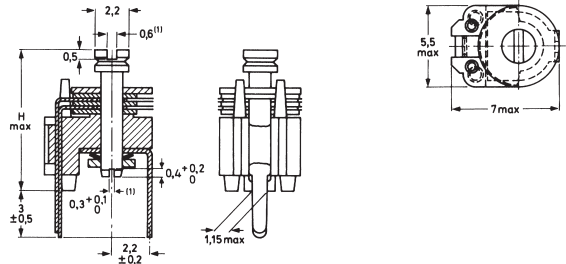

## BC COMPONENTS 808 FILM DIELECTRIC TRIMMER CAPACITORS

The 808 series trimmer capacitors has been designed primarily for UHF and VHF industrial communications. These high stability trimmers are designed for professional or consumer use, vertical or horizontal mounting and are intended for printed circuit board usage. The vanes are stacked on a straight mopolen base with plastic dielectric foils. The top end of the rotor spindle has a screw-driver slot which facilitates adjustment of the trimmer. **SPECIFICATIONS:** Working voltage: 250VDC. Temperature range: -40°C to +70°C.

Cat. No.	Max. Cap. pF	Min. Cap. pF	Temp. Coeff. PPM	Colour of Base	Net Price
<b>5MM VERSION</b>					
222280823508	1.5	5.0	-200±300	Grey	\$0.83
222280823109	2.0	10	-200±300	Yellow	.82
222280823159	2.5	15	-50±200	Blue	.96
222280823209	4.0	20	-50±300	Green	1.09
<b>7.5MM VERSION</b>					
222280811558	1.4	5.5	-400±300	Grey	.68
222280811109	2.0	9.0	-450±450	Yellow	.68
222280811229	2.0	22	-250±350	Green	.68
222280811279	2.0	27	-250±300	Red	.68
222280811339	3.0	33	-250±300	Brown	.82
222280811409	3.0	40	-100±300	Violet	.83
222280811509	3.0	50	-100±300	Black	.99
<b>10MM VERSION</b>					
222280831809	6.0	80	-100±300	Red	1.12
222280831101	7.0	100	-100±300	Violet	1.27
222280832659	5.5	65	-200±300	Yellow	1.11

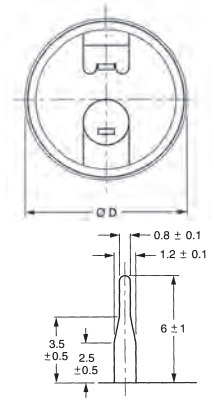
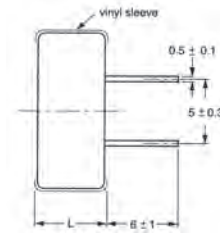
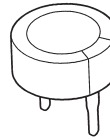

## BC COMPONENTS ELECTRIC DOUBLE LAYER CAPACITORS

Suitable for energy storage, for backup of semiconductor memories, telecommunication, audio-video, EDP, general industrial, clock and timer systems. **Specifications:** Operating Temperature Range: -25° to +70°C. Tolerance: -20% to +80%. Working Voltage: 55 WVDC. **Features:** Unlimited charge and discharge cycle numbers. No charge-discharge control circuitry and no series resistor necessary. Available in both vertical and low-profile version. Polarized capacitor with high charge density, alternative product to re-chargeable backup batteries.

Cat. No.	Cap	Diameter D x L (mm)	Inflow Current (µA)	Internal Resistance Ω(1KHz)	Net Price
<b>5.5VDC</b>					
222219612104	0.10F	13 x 7	100	75	\$1.95
222219612224	0.22F	13 x 7	135	75	2.12
222219612474	0.47F	12 x 7.5	216	30	5.30
222219612105	1.0F	12 x 7.5	315	30	5.51