

## INSULATED VERTICAL TEST JACK PC MOUNT

The vertical test jack is designed for use on circuit boards of audio, digital and RF circuitry where dependable, low cost test points are required. The contact, in formed or machined versions, is insulated to prevent accidental hand contact. The new formed contact features a unique spring loaded shank which retains the jack in the circuit board throughout the wave soldering operation.

Cat. No.	Colour	Net Price
<b>MACHINED CONTACT, SILVER PLATING</b>		
105-0852-001	Red	\$1.39
105-0853-001	Black	1.39
105-0854-001	Green	1.39
<b>FORMED CONTACT, SILVER PLATING</b>		
105-2201-201	White	1.30
105-2202-201	Red	1.30
105-2203-201	Black	1.30

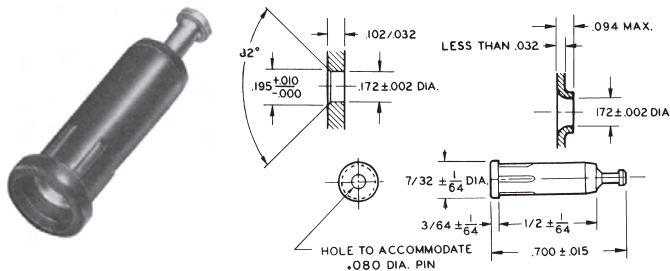

## RIB-LOC® PRESS-IN TIP JACKS

Installs by pressing into mounting hole, no mounting hardware required. Closed entry blocks access of probes greater than .085" (2.16mm). Nylon UL approved for self extinguishing. Silver-plated beryllium copper contact spring. Brass solder terminal silver-plated and iridized for good solderability. Accepts .080" tip plug. Current: 5 amps. Voltage breakdown: 3500 Vrms min. Contact-to-panel: 1 pF nominal.

Cat. No.	Colour	Net Price
105-1041-001	White	\$2.41
105-1042-001	Red	2.41
105-1043-001	Black	2.41
105-1044-001	Green	2.41

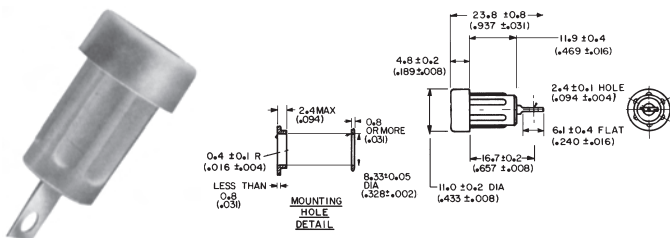

108-2300-801

## FOR STANDARD BANANA PLUG 4.44mm (.175") DIA.

**Formed Contact:** Current rating: 15 amps, breakdown voltage: 7000 Vrms min., contact resistance: 0.010 ohms max., contact panel-to-panel: 2.4pF nominal.

### RIB-LOC INSULATED BANANA JACKS

Cat. No.	Colour	Net Price
<b>FOR STANDARD BANANA PLUG .175" FORMED CONTACT</b>		
108-2301-801	White	\$1.05
108-2302-801	Red	1.05
108-2303-801	Black	1.05
108-2304-801	Green	1.05
108-2307-801	Yellow	1.05
108-2310-801	Blue	1.05

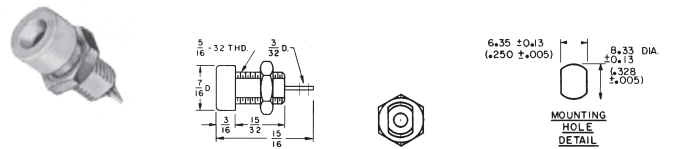

108-0900-001

## INSULATED BANANA JACKS THREADED BODY TYPE

These threaded nylon (Per Mil-P-20693A) insulated body type Banana Jacks with brass, cadmium plated, machined or formed contact comes with nickel plated mounting nut.

### FOR STANDARD BANANA PLUG 4.44mm (.175") DIA.

**Formed Contact:** Current rating: 15 amps., breakdown voltage: 7000 Vrms min., contact resistance: 0.010 ohms max., contact-to-panel: 2.4pF nominal.

**Machined Contact:** Same specifications as Formed Contact.

### INSULATED BANANA JACKS THREADED BODY TYPE

Cat. No.	Colour	Net Price
<b>FOR STANDARD PLUGS .175" DIA. FORMED CONTACT</b>		
108-0901-001	White	\$1.23
108-0902-001	Red	1.23
108-0903-001	Black	1.23
108-0904-001	Green	1.36
108-0907-001	Yellow	1.23
108-0908-001	Brown	1.36
108-0910-001	Blue	1.23

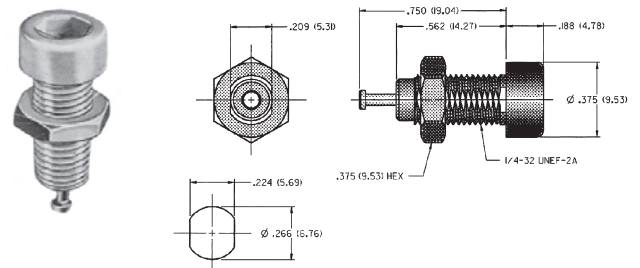

## DELUXE TIP JACK

For standard tip plug, 2 mm (.080") dia. Molded body with recessed closed entry design contact. Silver-plated beryllium copper contact spring. Brass solder terminal is hot tin dipped. Current rating: 10 amps. Voltage breakdown: 11000 VDC. Capacity to 1/8" panel: 2.0 pf. 1/4-32 nut furnished.

Cat. No.	Colour	Net Price
105-0601-001	White	\$2.52
105-0602-001	Red	2.52
105-0603-001	Black	2.52
105-0604-001	Green	2.52
105-0607-001	Yellow	2.52
105-0610-001	Blue	2.52

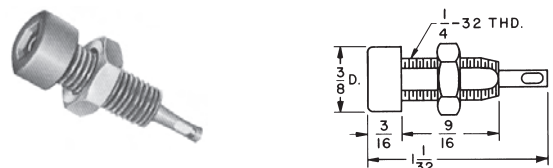

## INSULATED STANDARD TIP JACK

Molded Nylon body. Accepts .080" dia. tip plug. Contact: Phosphor bronze. Finish: Bright tin. Current: 10 amps. Breakdown voltage: 5700 Vrms min. Contact-to-contact: 2pF nominal.

Cat. No.	Colour	Net Price
105-0801-001	White	\$1.45
105-0802-001	Red	1.45
105-0803-001	Black	1.45
105-0804-001	Green	1.45
105-0807-001	Yellow	1.45
105-0810-001	Blue	1.46