

### SOCKETS FOR TO-5 & TO-100

Fully molded compact construction. Speeds transistor assembly. Incorporates ultra high quality, closed entry, sleeve type contacts. Accepts .016 to .020 diameter leads and .010 x .018 rectangular transistor leads.

**MATERIAL: Insulator:** Glass Filled Polyester, UL rated 94V-0; **Contact Pin:** Brass, Tin Plate; **Contact Spring:** Beryllium Copper, .000030 min. Gold Plate.

Cat. No.	Description	Net Price
4590	FORTO-5 (3 PIN)	\$1.06
4591	FORTO-5 (4 PIN)	1.42
4592	FORTO-5 (8 PIN)	2.68
4593	FORTO-5 (8 PIN)	2.68
4594	FORTO-5 (10 PIN)	3.17

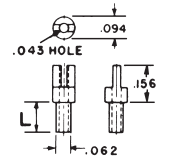
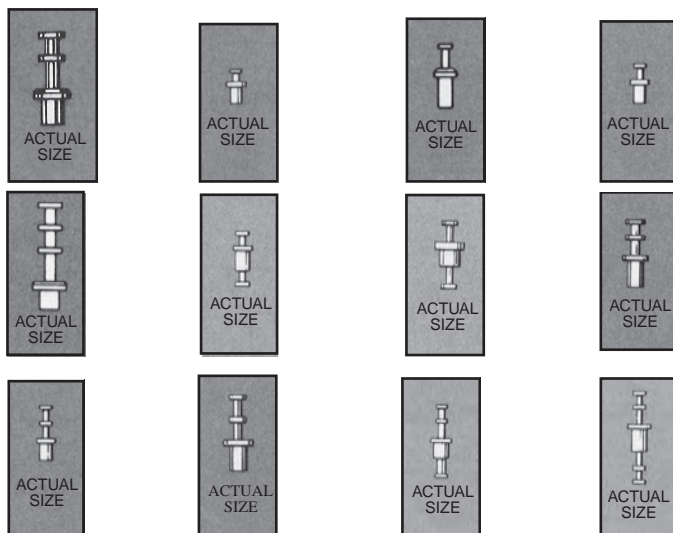

1526  
STAKING TOOL NO. TL-3

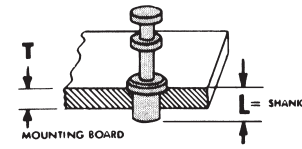

### TERMINALS

Specify catalogue number of terminal selected and add the dash number or mention the thickness of the insulator to be used, for example: **1503-1** for 1/32" insulator, **1503-2** for 1/16" insulator etc.—**1** for insulating board 1/32" thick—**2** for insulating board 1/16" thick—**3** for insulating board 3/32" thick—**4** for insulating board 1/8" thick

### STAKING TOOLS

Catalogue No. TL-series designates a set of tools, consisting of **TOP (staking)** and **BOTTOM (holder)**. Some sets of tools can be used for other terminals with similar dimensions. Tools are made of 1/4" dia. steel and **cadmium plated. Precision Machined** and carefully **hardened** to insure long wear.

Cat. No.	Net Price
TL-*	\$20.45

\*Add number suffix for desired staking tool.

Cat. No.	L	T	Net Price Per 1000		
			1-499	500-999	1000-Up
1503-1	.078	1/32	\$236.67	\$166.61	\$107.59
1503-2	.109	1/16	236.67	166.61	107.59
1503-3	.141	3/32	236.67	166.61	107.59
1503-4	.172	1/8	236.67	166.61	107.59
1508-1	.053	1/32	89.57	63.05	40.72
1508-2	.084	1/16	89.57	63.05	40.72
1508-3	.115	3/32	89.57	63.05	40.72
1508-4	.147	1/8	89.57	63.05	40.72
1520-1	.078	1/32	126.95	89.37	57.71
1520-2	.109	1/16	126.95	89.37	57.71
1520-3	.141	3/32	126.95	89.37	57.71
1520-4	.172	1/8	126.95	89.37	57.71
1572-1	.051	1/32	86.83	61.12	39.47
1572-2	.082	1/16	94.65	66.63	43.03
1572-3	.113	3/32	86.83	61.12	39.47
1572-4	.145	1/8	86.83	61.12	39.47
1527-1	.078	1/32	319.58	224.99	145.28
1527-2	.109	1/16	319.58	224.99	145.28
1527-3	.141	3/32	319.58	224.99	145.28
1527-4	.172	1/8	319.58	224.99	145.28
1574-1	.051	1/32	94.65	66.63	43.03
1574-2	.082	1/16	94.65	66.63	43.03
1574-3	.113	3/32	94.65	66.63	43.03
1574-4	.145	1/8	107.08	75.38	70.33
1502-1	.078	1/32	115.01	80.96	52.28
1502-2	.109	1/16	115.01	80.96	52.28
1502-3	.141	3/32	115.01	80.96	52.28
1502-4	.172	1/8	115.01	80.96	52.28
1573-1	.051	1/32	94.65	66.63	43.03
1573-2	.082	1/16	94.65	66.63	43.03
1573-3	.113	3/32	94.65	66.63	43.03
1573-4	.145	1/8	94.65	66.63	43.03
1514-1	.078	1/32	182.88	128.75	83.14
1514-2	.109	1/16	182.88	128.75	83.14
1514-3	.141	3/32	182.88	128.75	83.14
1514-4	.172	1/8	182.88	128.75	83.14
1525-2	.109	1/16	341.90	240.69	155.42
1525-3	.141	3/32	341.90	240.69	155.42
1525-4	.172	1/8	341.90	240.69	155.42
1526-1	.054	1/32	160.38	112.91	72.91
1526-2	.084	1/16	160.38	112.91	72.91
1526-3	.115	3/32	160.38	112.91	72.91
1526-4	.147	1/8	160.38	112.91	72.91
1582-1	.075	.032	244.87	172.38	111.31
1582-2	.105	.062	244.87	172.38	111.31
1582-3	.135	3/32	244.87	172.38	111.31
1582-4	.165	.125	244.87	172.38	111.31