

1005
1006
1007
1008

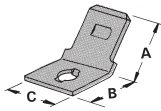

2004
1271
1280

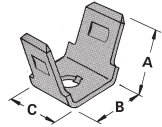

2005
1263
1258

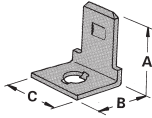

2002
1261
1256

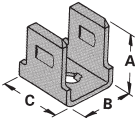

2003
1262
1257

45° AND 90° QUICK-FIT RIVET TYPE TERMINALS

MATERIAL: Bright Brass

Cat. No.	Tab Size	Material Thick	Dimension			Hole Dia.	Pairs	Net Price Each
			A	B	C			
MULTIPLE 90°								
1005	.250	.032	.703	.375	—	.130	2	\$.43
1006	.250	.032	1.075	.375	—	.130	3	\$.47
1007	.250	.032	1.422	.375	—	.130	4	\$.55
1008	.250	.032	1.837	.375	—	.130	5	\$.77
45°								
2004	.110	.020	.350	.270	.180	.096	—	\$.14
1271	.187	.020	.375	.250	.250	.099	—	\$.18
1280	.250	.032	.405	.312	.312	.130	—	\$.09
2005	.110	.020	.350	.383	.180	.096	—	\$.16
1263	.187	.020	.312	.375	.265	.135	—	\$.14
1258	.250	.032	.405	.343	.312	.130	—	\$.11
90°								
2002	.110	.020	.360	.250	.180	.096	—	\$.14
1261	.187	.020	.375	.250	.250	.099	—	\$.14
1256	.250	.032	.405	.312	.312	.130	—	\$.09
2003	.110	.020	.350	.383	.180	.096	—	\$.16
1262	.187	.020	.312	.250	.250	.099	—	\$.20
1257	.250	.032	.405	.343	.312	.130	—	\$.11

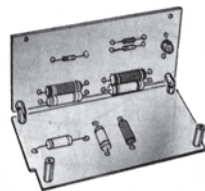
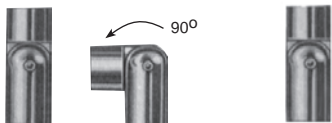

ONLY 2 SCREWS USED TO FASTEN BOARD IN PLACE OR OPEN THE HINGED BOARD.

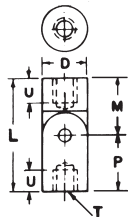

KEYSTONE FEMALE/FEMALE HINGED STANDOFFS FOR TERMINAL BOARDS

HINGE

Cat. No.	Dimensions						Net Price Each	
	T Thread	D Dia.	L Length	U	M	P	1-19	20-Up
351	4-40	.187	3/4	.172	.375	.375	\$1.06	\$.95
352	4-40	.187	1	.250	.375	.625	1.13	1.02
353	6-32	.250	3/4	.172	.375	.375	1.48	1.32
354	6-32	.250	1	.250	.375	.625	1.52	1.36
355	8-32	.250	3/4	.172	.375	.375	1.35	1.20
356	8-32	.250	1	.250	.375	.675	1.42	1.28

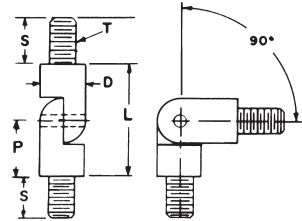

KEYSTONE MALE/MALE HINGED STANDOFFS FOR TERMINAL BOARDS

HINGE

Cat. No.	Dimensions					Net Price Each	
	T Thread	D Dia.	L Length	S	P	1-19	20-Up
357	4-40	.187	1/2	1/4	1/4	\$1.42	\$1.28
358	6-32	.250	1/2	5/16	1/4	1.46	1.31
359	8-32	.250	1/2	5/16	1/4	1.62	1.45

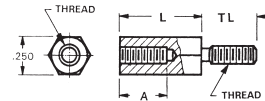

MALE/FEMALE .250 HEX THREADED STANDOFFS 4-40 THREAD

MATERIAL: Brass, Nickel Plate. Aluminum, Clear Iridite Plate. Stainless Steel.

Thread Size	TL External	A Internal
4-40	3/16 (.187)	1/4 (.250)
6-32	1/4 (.250)	3/8 (.375)
8-32	3/8 (.375)	3/8 (.375)

Cat. No.	Length (Inches) "L"	Net Price Each		
		1-499	500-999	1000-Up
STAINLESS STEEL				
8712	1/4 (.250)***	\$1.64	\$1.15	\$.74
2087	3/8 (.375)**	1.55	1.24	1.24
2088	1/2 (.500)	1.62	1.29	1.29
2089	5/8 (.625)	1.69	1.35	1.35
2090	3/4 (.750)	1.79	1.42	1.42
2091	7/8 (.875)	1.85	1.47	1.47
2092	1 (1.000)	1.88	1.49	1.49
2093	1-1/8 (1.125)	1.98	1.58	1.58
2094	1-1/4 (1.250)	2.05	1.64	1.64
2095	1-3/8 (1.375)	2.11	1.69	1.69
2096	1-1/2 (1.500)	2.15	1.71	1.71
2097	1-5/8 (1.625)	2.19	1.75	1.75
2098	1-3/4 (1.750)	2.22	1.77	1.77
2099	2 (2.000)	2.34	1.87	1.87
BRASS				
8713	1/4 (.250)***	.33	.23	.15
8799	3/16 (.187)***	.50	.35	.23
7200	3/8 (.375)**	.37	.26	.17
1944	1/2 (.500)	.48	.34	.22
1945	5/8 (.625)	.49	.34	.22
1946	3/4 (.750)	.58	.41	.26
7201	7/8 (.875)	.59	.41	.27
1947	1 (1.000)	.65	.46	.29
7202	1-1/8 (1.125)	.70	.49	.32
1948	1-1/4 (1.250)	.99	.70	.45
1949	1-3/8 (1.375)	1.02	.72	.46
1950	1-1/2 (1.500)	1.07	.75	.48
7203	1-5/8 (1.625)	1.08	.76	.49
7205	1-3/4 (1.750)	1.20	.85	.55
1951	2 (2.000)	1.21	.85	.55

**Internal Thread .250 Deep.
***Internal Thread .130/.150 Deep.

Continued on next page...