



## CNX 480/482 Series .399" (10.1mm) Ruggedized LED Panel Mount Indicator

CNX480/482 Series offer a robust anodized aluminum body with a low profile for anti-vandalism, ESD protection and NEMA4\*

\*CNX482 offer with moisture seal

### Applications

- instrument panels
- disinfection and sterilization environments
- transportation dashboards
- safety applications
- outdoor signage
- aircraft and military
- industrial machinery
- electrical control panels
- vending and gaming machines

### Key features

- designed for harsh and outdoor environments
- wide angle viewable
- low profile for anti-vandalism
- direct sunlight visibility
- resistant to shock and vibration
- ESD protection
- custom LEDs, lens and body colors available
- RoHS compliant

### Dimensions

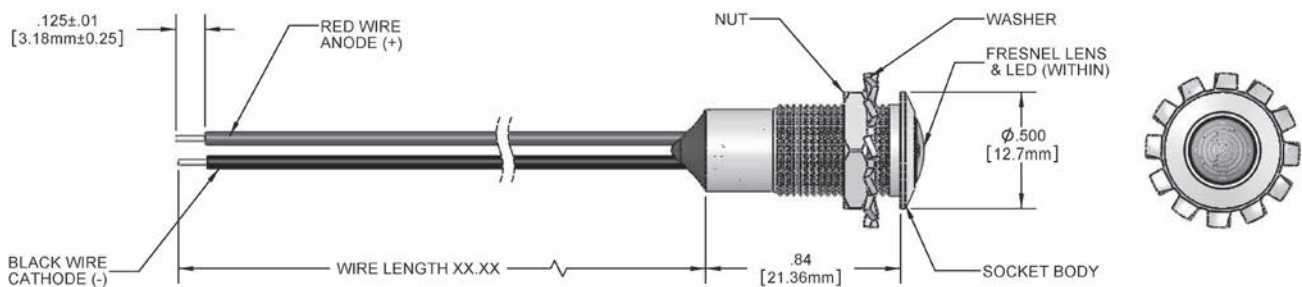

CNX480 without moisture-seal

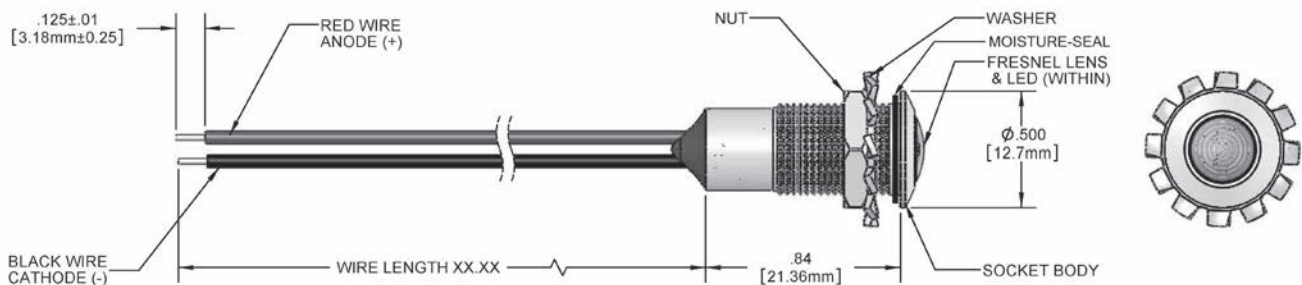

CNX482 with moisture seal

## Product specifications

LED output		
LED color**	typ intensity, mcd	forward voltage, V (typ)
red	245-345	1.8
green	345-485	1.9
white	3500-4900	2.8
blue	950-1300	3.0
yellow	280-380	1.9

Materials	
socket body	aluminum alloy
lens	polycarbonate, UL rating 94-V2
washer	steel, zinc plated, UL rating 94-V0
retaining nut	aluminum alloy
wire	24 AWG 1007/1569 red = anode(+) black = cathode (-)
moisture seal	EPDM

Installation specification	
mounting hole	.399±.004 (10.1mm±.1)
panel thickness	.059(1.5mm) min to .320 (8.1mm) max

Operating parameters	
operating temperature	-40°F (-40°C) to 176°F (80°C)
LED output current	20mA

## Ordering data

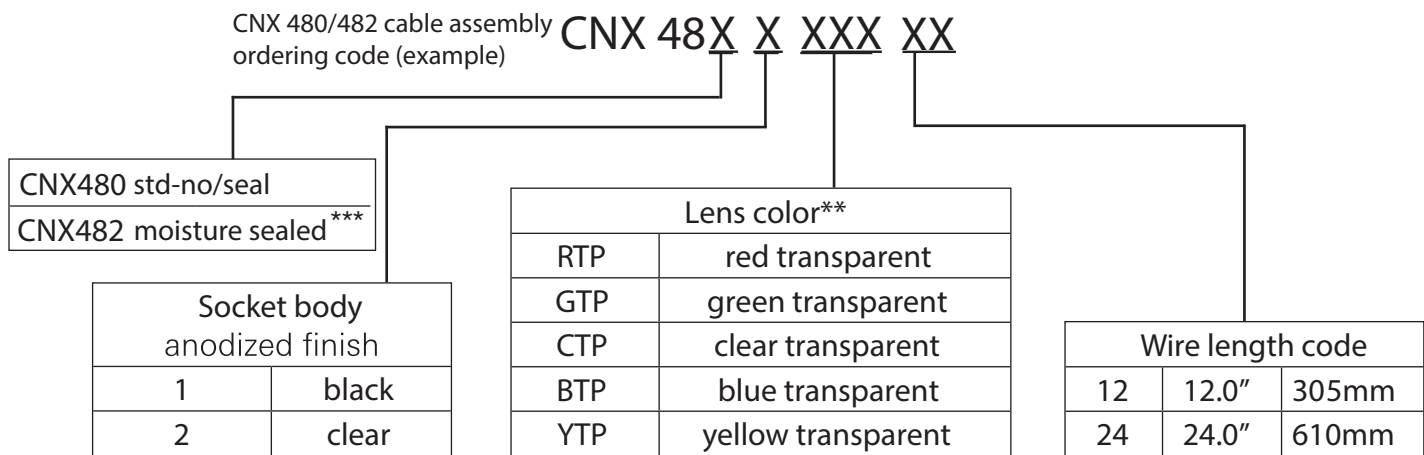

\*\*LED color same as the lens color.  
Example: Red LED comes with a red lens.

\*\*\*NEMA4 rated



# CNX714 Series 0.551" (14mm) Ruggedized LED Panel Mount Indicator



Ruggedized CNX714 Series with built-in LED offers fast, easy installation in harsh environments.

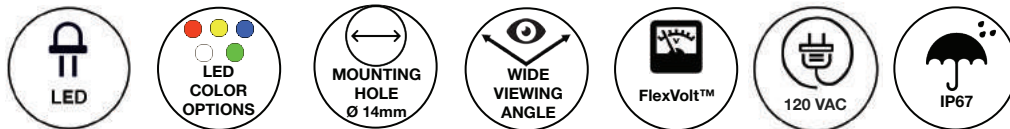

## Applications

- Industrial Machinery
- Transportation Dashboards
- Instrument Panels
- Control Cabinets
- Safety Applications
- Disinfection and Sterilization
- Switching Stations
- Slot, Gaming and Vending Machines
- Outdoor Signs
- Military Aircraft

## Key Features

- For panel hole diameter: 0.551" (14mm)
- Designed for extreme harsh and outdoor environments.
- Variety of connection options for fast, easy installation.
- Built-in LED can be used with FlexVolt™ (5 to 28 VDC) or 120VAC circuits
- Fast pitch threads ease assembly, requiring only one turn.
- Nut assembly by finger-tightening or with 1 inch hex key.
- Outdoor visibility in direct sunlight.
- Available in six solid colors (red, green, white, blue, soft yellow and yellow).
- Wide Viewing Angle
- Resistant to shock and vibration.
- Moisture sealed, IP67, protected from total dust ingress and withstanding water immersion between 15 cm and 1 meter for 30 minutes.
- Lead wire options with custom wire length available.
- Other colors (single or bicolor) are available upon request.
- RoHS and REACH Compliant.

## Ordering Data

The CNX714 Series is available in a range of standard features and options. To specify your Panel Mount Indicator, select one option from each column.

LED Color		Voltage		Termination Style	
CNX714C				<b>W</b>	
CNX714C: Colored Body					
<b>200</b>	Red			<b>W</b> Wire Leads	
<b>400*</b>	Soft Yellow				
<b>401</b>	Yellow				
<b>500</b>	Green				
<b>600</b>	Blue	<b>FV</b>	5-28VDC		
<b>900</b>	White	<b>120</b>	120VAC		

Example:  
CNX714C600120W  
Blue  
120VAC  
Wire Leads



\* Not Available for the 120VAC Version

## Product Dimensions

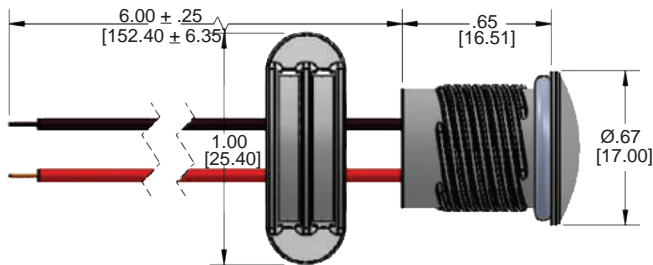

Recommended Mounting Hole

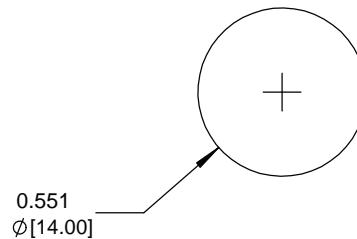

All Dimensions in inches [mm]

Tolerances are:  $\pm 0.01$  inches [ $\pm 0.25$  mm] unless otherwise specified

## Product Specifications

Flex Voltage Version:

LED output		
LED color	Luminous intensity typ. (mcd)	I (mA)
red	1300-2700	20
soft yellow	80-400	20
yellow	450-1120	20
green	1000-1400	20
blue	280-710	20
white	1300-1800	20

120VAC Version:

LED output		
LED color	Luminous intensity typ. (mcd)	I (mA)
red	550	8
yellow	245	8
green	924	8
blue	67	8
white	644	8

### Installation Specification

mounting hole	0.551" (14.0mm)
panel thickness	Up to .250" (6.3mm)
spacing	minimum 1.5" center to center
retainer width	1" (25.4 mm)

### Temperatures

operating temperature	-40°F (-40°C) to 176°F (80°C)
storage temperature	-40°F (-40°C) to 212°F (100°C)

### Materials

body	polycarbonate, UL94-V2
retaining nut	PBT/Glass Filled, UL94-V0
wire	24 AWG - Black/Red** 20 AWG - Black***
lens	polycarbonate, UL94-V2
moisture seal	EPDM

\*\* Flex Voltage Version

\*\*\* 120 VAC Version

## Compliance and Approvals



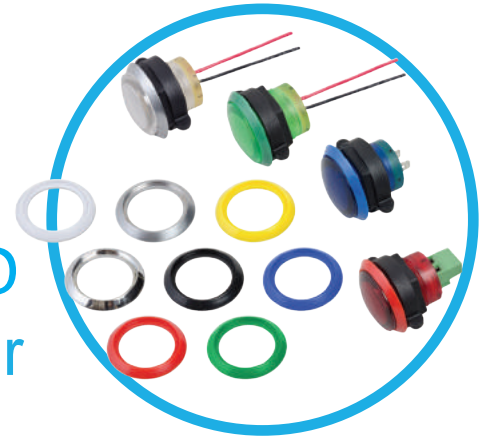

# CNX 722FV Series 0.866" (22mm) Ruggedized LED FlexVolt™ Panel Mount Indicator

CNX 722FV Series with built-in LED FlexVolt™ technology offers fast, easy installation in harsh environments

## Applications

- control cabinets
- instrument panels
- disinfection and sterilization environments
- transportation dashboards
- switch stations
- safety applications
- outdoor signage
- aircraft and military
- industrial machinery
- vending and gaming machines

## Key Features

- designed for extreme harsh and outdoor environments
- variety of connection options for fast, easy installation
- built-in LED can be used with 5 to 28 volt DC circuits
- fast pitch threads ease assembly, requiring only 1 turn
- special nut assembles by finger, or with 1" hex tool
- direct sunlight visibility
- wide viewing angle
- resistant to shock and vibration
- custom LEDs and lens colors available
- optional bezel available in many colors
- moisture sealed, IP67 rated

## Product Dimensions

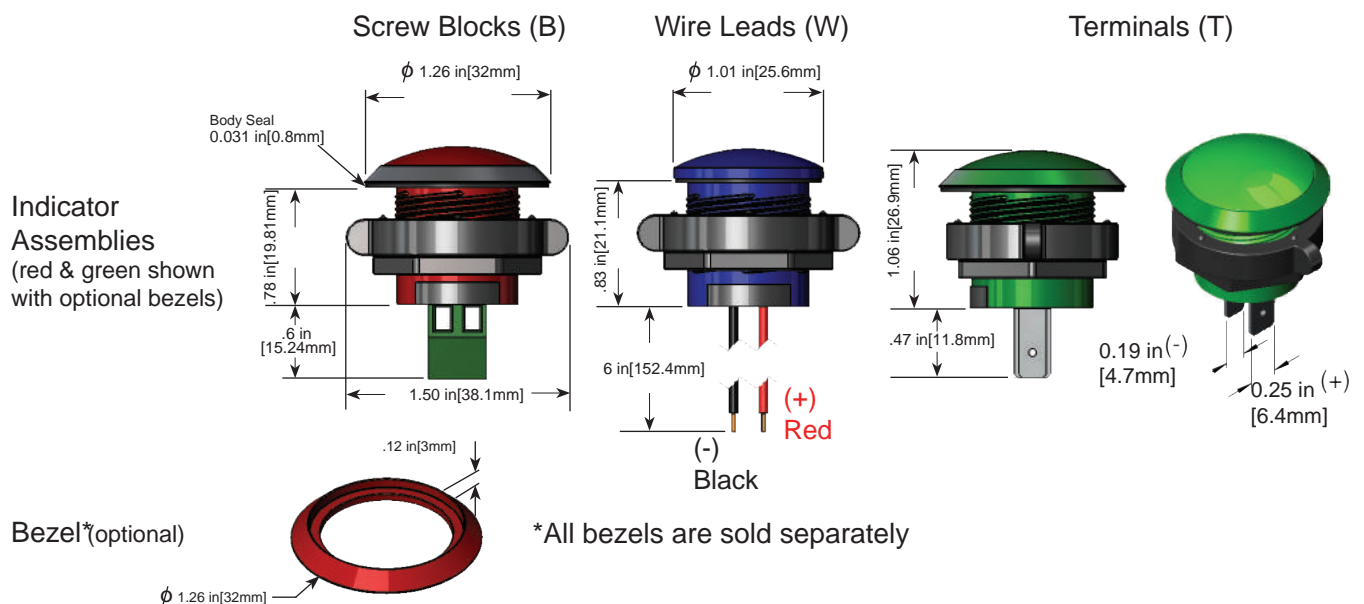

## Ordering Data

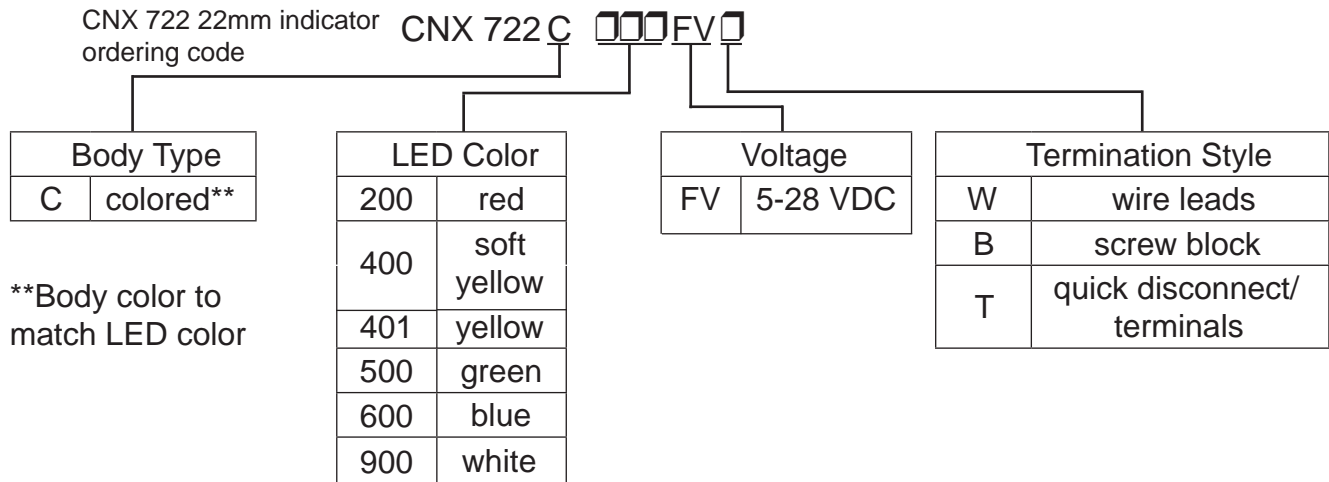

## Product Specifications

LED output		
LED color	typ intensity (mcd)	I (mA)
red	1300-2700	20
soft yellow	80-400	20
yellow	450-1120	20
green	1000-1400	20
blue	280-710	20
white	1300-1800	20

Materials	
body/lens	polycarbonate, UL 94-V2
retaining nut	Valox, black UL 94-V0
wire	22 AWG 1007/1569
moisture seal	EPDM

Installation Specification	
mounting hole	.855-.910" (21.7-23.1mm)
panel thickness	Up to .300" (7.6mm)
spacing	minimum 1.5" center to center

Operating parameters	
operating temperature	-40°F (-40°C) to 176°F (80°C)

## Compliance and Approvals



## Accessory Options

### Optional sealed bezel: BZL722-

#### Sealed Bezel IP67

- Material - either plastic or metal
- For indoor and outdoor applications, protects against falling dirt. Also protects against water or oil and the effects of ice formation.

moisture seal	EPDM
bezel-plastic	ABS, UL 94-HB
bezel-metal	aluminum alloy

<input type="checkbox"/>	Color	Material
0	black	plastic
2	red	plastic
4	yellow	plastic
5	green	plastic
6	blue	plastic
9	white	plastic
A	actual aluminum	metal
B	brushed aluminum	plastic
C	chrome	plastic